

Section 12A

Belt Drive & Primary

Belts	2
Belt Drives	5-7
BDL.....	5-7
Primo	7
Belt & Chain Guards	33-35
Chain	30-31
Chain Adjusters	30-33,36
Compensating Sprockets/Kits.....	31
Derby & Inspect. Covers	12-14, 20-21
Primary	
Inner, Big Twin	16-22
Outer, Big Twin	10-11, 18-21
Sportster	23-25
Pulleys	7,9
Pulley Covers	9
Sprockets	26-29

Replacement Belts

Note:

The replacement belts offered for sale on this page have no warranty whatsoever.



8mm Rubber Primary Belts

Bullseye belts are about .020 longer.

PCP	Size	Teeth	F/R Pulley
42059	8mm x 42mm	130	48-68 Kevlar
42060	8mm 1-3/4"	132	48-72
42062	8mm x 42mm	138	45-68 Kevlar (1-3/4")
42064	8mm x 38mm	138	45-68 Kevlar
42065	8mm 1-3/4"	141	47-72
42066	8mm 1-5/8"	132	48-72
42067	8mm 1-5/8"	141	47-72
42089	8mm 3"	132	44-76 Bullseye
42068	8mm 3"	141	47-72
42069	8mm 3"	132	48-72
3204	8.07mm 1-1/2"	132	41-61
42090	8mm 1-1/2"	132	41-61 Kevlar
3206	8mm 1-1/2"	132	41-61, 39-62, Bullseye
3207	8mm 1-1/2"	144	47-76
42092	8mm 1-1/2"	144	As above, Kevlar
3208	8mm 2"	144	47-76 2T & 2S
3209	8mm 3"	144	47-76 3T & 3S
42087	8mm 4"	140	
3202	8mm 1-1/2"	117	45-76 Sporster
3203	8mm 1-3/4"	117	45-76 Sportster
42056	8.07mm 1-1/2"	132	Kevlar
42085	8.07mm 1-3/4"	132	Kevlar
42057	8.07mm 3"	132	Kevlar



Panther Rubber Racing Belts

42052	8mm 3"	144	Panther
42054	8mm 3"	130	Panther
42055	8mm 3"	120	Panther

Belt Tension Gauge

Gauge is designed to aid in properly adjusting belt tension on models with a secondary drive belt.

26016



41mm = 1-1/2"

42mm = 1-5/8"

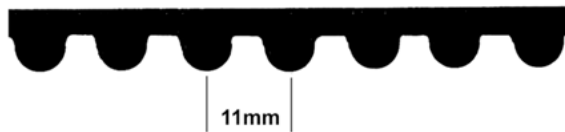

11mm Rubber Primary Belts

PCP	Size	Teeth	F/R Pulley
3199	11mm 1-1/2"	99	31-47 (4 speed)
42083	11mm 1-1/2"	92	31-47 (5 speed)
3220	11mm 1-1/2"	96	29-44, 28-44

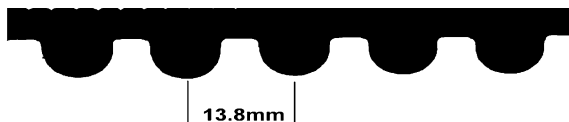

13.8mm Polychain Primary Belts

PCP	Size	Teeth	F/R Pulley
42081	13.8mm 1-1/8"	78	Sturgis (stock)
3213	13.8mm 1-1/2"	78	Karata
42084	13.8mm 1-3/4"	78	Karata

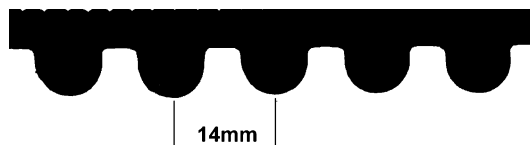

14mm Primary Belts

PCP	Size	Teeth	F/R Pulley
3214	14mm 1-1/2"	69	Polychain
42082	14mm 1-3/4"	69	As above
3216	14mm 1-1/2"	78	24-37, 24-38 (4 speed)
3217	14mm 1-1/2"	72	24 -37 (5-spd) BT 80-84



Rear Belt 'T' Nuts

12628 5 Pack (7669)



Transmission Shaft Nut with Seal

Nut with seal for all BDL and Primo kits.

76213

HTD® and Poly Chain® are registered trademarks of the Gates Rubber Company



Kevlar Clutch Pack for Chain Drive

Set of 7 plates which can also be used with BDL competitor clutches.

76454



Steel Drive Plates for Chain Drive

Set of 8 drive plates.

76455



BDL Clutch Hub Disk Kit

Teflon disk kit includes rivets for BT 1936-84.

76436

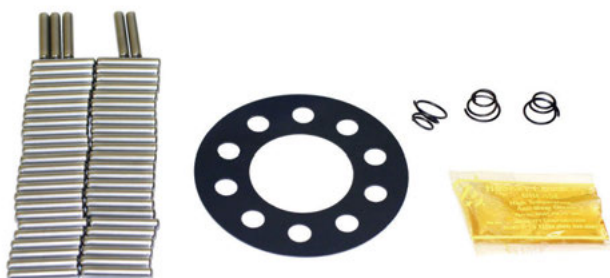

BDL Big Fix Bearing Kit

Fits BT 1941-84.

76438 BF-1



BDL Idler Bearing Kit

76437 IBK-1



76302

BDL Primary Chain Drives with Competitor Clutch

Kevlar clutch provides 60% more clutch surface than stock and the 9 spring pressure plate provides all the spring pressure needed for stock to strokers. Competitor clutch provides transfer of power to the rear wheel. Kits include front sprocket, rear basket with Competitor Clutch, primary chain and adjuster assembly.

PCP Description

76302 1970-84 Electric start

76424 Replacement ring gear

76305 Kickstart basket only 1936-83



BDL Big Twin 1941-84

Clutch kit includes 5 Kevlar frictions and 4 steel plates. Wet or dry operation.

76460

76439



76440



76441



76442



Belt Guides

PCP Description

76439 Inside belt guide

76440 Outside belt guide

76441 Flat hex nut spline size

76442 Washer spline size



76420



BDL "Competitor Clutch"

For all Shovelhead chain and belt drives 1936-84. Features 9 springs and shoulder bolts for easy spring adjustment. A large 40mm double row hub bearing provides maximum performance and strength. The polished pressure plate adds a custom touch for open belt drive installations. Also includes a race proven Kevlar clutch.

76420



BDL Retro Fit Clutch for 3" 4 Speed Drives

Clutch design moves the weight in-board over the bearing to eliminate the gyro effect of the stock or early style hub. Fits all 3" belt drives 1936-E84. To be used with existing 3" front pulley and belt. Competitor Clutch package includes: clutch basket, 40mm double row sealed bearing, 6 Kevlar clutch plates, steel hub, 5 steels, hardware and a 12 hole polished pressure plate with springs and shoulder bolts.

76422

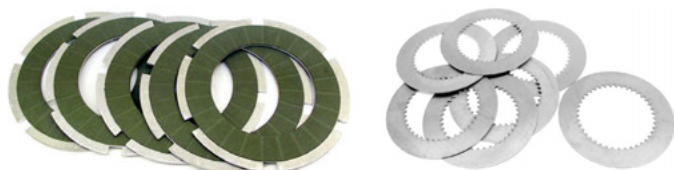

Replacement Clutch Fibers and Steels

PCP Description

76447 Set of 5 fibers for #76420

76448 Set of 7 steels for #76420



Standard Replacement Insert

For BDL #76341 belt drive (76-47-2S).

76091



BT Rear Wheel Spacers (BDL)

PCP Size BDL

76427 .250" RPS-0250

76428 .375" RPS-0375

76429 .500" RPS-0500

76430 .750" RPS-0750

76431 .937" RPS-0937 for use with BDL 1" pulley

76418 15/16" RPS-100

76432 1.100" RPS-1100 for use with CCI wheels

76433 1.250" RPS-1250



Primary Spacers

PCP	Size
76456	1/4" spacer
76457	1/2" spacer
76458	3/4" spacer
76459	1" spacer



BDL Starter Pinion Gear

Replacement parts for 3" electric start.

76212 All Shovelhead (2.750 O.A.L.)



BDL Ring Gear

For 8mm and 11mm.

76423 1965-83



76316

8mm x 42mm (1-5/8") Electric Start Belt Drives

Innovative design features for bolt-in application which allows the belt to track on the correct geometry plane while reducing the need for extensive grinding of the inner primary. The clutch basket features 12 cylindrical replaceable clutch dogs which allow drive plate to make constant contact for quieter operation. Polished pressure plate uses 6 shoulder bolts and springs for easy installation. "Competitor Clutch" has Kevlar clutch plates for maximum performance. Also included is a sealed bearing for the inner primary and a seal for those who do not want to replace the stock bearing. These units are for rear belt drive models only. Only 1 kevlar belt included.

For Shovelhead 1-1/2"

76316	68-45T With rear chain 4 speed 1965-83 (41mm)
76234	45T Front pulley for #76316
42064	Replacement belt for above unit
76317	68-45T With rear belt drive 4 speed 1979-84 (42mm)
42062	Replacement belt for above unit



Pulley Inserts For Replaceable Style (Primo)

PCP	Description
76468	1/4" insert and special nut with screws
76469	1/2" insert and special nut with screws
76470	3/4" insert and special nut with screws
76471	1" insert and special nut with screws
76472	1-1/4" insert and special nut with screws



BDL 8mm 3" Electric Start Shovel Belt Drive

Kit includes 1.2 kw black wrinkle starter and fits Shovelhead 1970-E79 with ratchet tranny lid. Mini dome covers with tape for bolt-less installation and button bolts for on/off installation can be ordered separately.

PCP **Description**

76337 Belt drive kit

3209 Belt for above kit

76443 Mini dome covers for above kit



BDL 8mm 2" & 3" Belt Drives- 4 Spd Kickstart

2" and 3" drives are made from 356T6 aluminum. Each drive includes a big fix kit and requires safety guard at all times.

PCP	For Kickstart Models	Year	Belt
76341	76-47 2" Spline engine shaft	1955-84	3208
76342	76-47 3" Taper engine shaft	1936-54	3209
76343	76-47 3" Spline engine shaft	1955-84	3209

BDL 3" Replacement Basket

Includes basket, gear, dogs and bearings.

76298 Shovelhead



BDL 1-1/2" 8mm Belt Drives Pan-Shovel

These units are a great choice for all around riding and dependability. BDL competitor clutch can be used with these drives for superior performance over stock Shovelhead hubs and clutches.

PCP	Description	Year	Belt
76318	61-41 8mm electric start	1965-78	3204
76319	61-41 8mm electric start	1979-84	3206
76320	61-41 8mm electric start with rear belt drive	1979-84	3206
76321	62-39 8mm kick start taper shaft	1936-54	3206
76322	62-39 8mm kick start spline shaft	1955-64	3206
76323	62-40 8mm kick start spline shaft	1965-78	3206
76324	61-41 8mm kick start spline shaft	1979-84	3206



BDL 1-1/2" 11mm Belt Drives for BT 4 Speeds

Large pitch tooth profile can be used with BDL competitor clutches.

PCP	Description	Year	Belt
76325	47-31 11mm kick start taper shaft	1937-54	3199
76326	47-31 11mm kick start spline shaft	1955-64	3199
76327	47-31 11mm kick start spline shaft with idler	1965-84	3199
76328	47-31 11mm electric start with idler	1965-84	3199
76329	47-31 11mm electric start with idler *For models with rear belt drives with rear belt model inner primary	1979-84	3199

Belt Drive

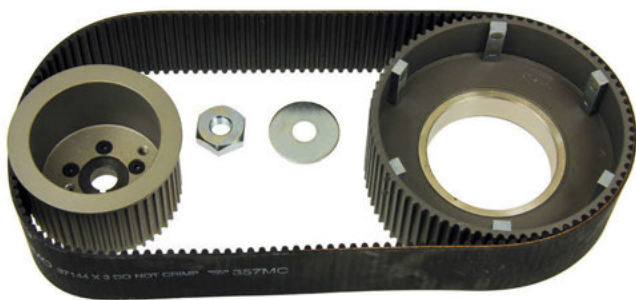

Primo 8MM 3" Open Belt Drive Units

Open belt drives for pre Evo Harleys with adjustable transmission only. A full 3" wide. Primo belt drive pulleys are hard anodized for durable, long lasting service. All rear pulleys have hardened clutch dogs, each secured with two stainless steel rivets. Primo races are made from a special chrome-moly carbon steel alloy.

76106 1937-54 taper shaft (P-47-76-E)

3209 8mm x 144T belt for above unit

Note: All belts by Primo, Karata or BDL are manufactured by Gates Rubber, Goodyear or Dayco Panther. Belts **do not** carry any warranty, of any kind, whether sold separately or in a complete kit.



Laser Etched 3" Front Pulley

Front pulley for 3" belt drive has laser etched numerals from 0-360 degree. The perimeter numbering allows for convenient and accurate timing of the motor without removing the timing hole plug.

76039 1955-84 8mm Splined shaft (P-47-S-3N)

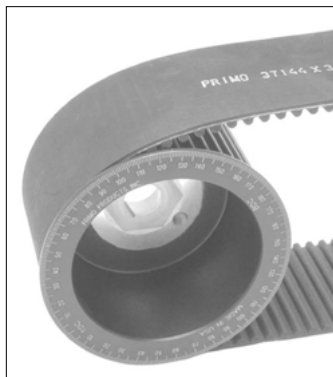

BDL SHS-600 Shovel Shorty 2" Belt Drive

2" Electric start set up with a rear plate that covers the trans to add support for the rear clutch basket. It comes complete with front and rear pulley, BDL's kevlar clutch and 140T 2" belt. Rear plate includes our mini starter housing, pinion gear and starter housing, pinion gear and starter ring gear guard.

76331



BDL EVB-3T-5 Closed Belt Drive

Designed as a bolt-on replacement for 1979-83 rear chain 5 speed Shovelhead models. Clutch basket features 12 cylindrical clutch dogs for constant contact. Polished pressure plate uses 9 shoulder bolts and springs allowing for clutch pressure adjustment. Kit includes Kevlar clutch plates.

76333

BDL 11mm 1.5" Electric Start

Rear Clutch Drum Replacement

76492 (47E)



Primo 8mm Front Pulleys 74 & 80 HD

PCP	Primo	Year	Type	Belt
76034	P-47-T-2	1937-54	Tapered shaft	2" Belt (open installation)

Primo 8mm Rear Pulleys 74 & 80 HD

PCP	Primo	Year	Type	Belt
76042	P-62-K	1937-64	Rear pulley	1-1/2" Belt (kick-start only, closed primary)

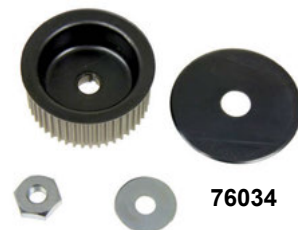

Belt Drive Accessories



Polished Pressure Plate

Precision machined alloy pressure plate for BT 4 speed 1941-84 with a steel centre insert for clutch adjusting screw.

1532

Polished Clutch Dome for Big Twin 4 Speeds

These clutch domes give that finished custom look to our open belt drive units. It also helps protect your leg from spinning parts. Fits BT to 1984 (except diaphragm clutch).

42100 3 Hole

42102 5 Hole



Bearing Support

For use when cast aluminum inner primary is removed for installation of open belt drive on BT 4-speeds 1966-84 because the mainshaft requires additional support.

42106 Chain type (no bearing) fits with belt front & rear c/drive

15718 Bearing only unshielded 1970-E84

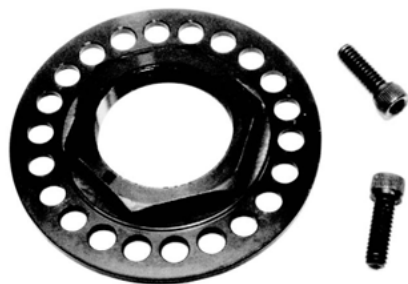

Pulley Indexing 'Mega' Nut

Nut allows drilling and tapping for additional set screw locations.

12629

Chrome Acorn Sprocket Nut

5100 Big Twins 1936-54.

1815 Big Twins 1955-76.



Safety Belt Shrouds for Open Belt Drives

Recommended for all open installations, a necessary safety item. Manufactured from steel and chrome plated, complete with a welded-on mounting tab for easy installation.

Alternator style requires PC #700 or #42103 (chromed) for mounting.

42200 Fits 1937-69 (generator) with 1-1/2" or 1-3/4"



Alternator Cover BT 1970-84

Designed to protect your alternator, also helps cool by acting as a heat sink. It has a mounting lug for our belt shroud built in. Highly recommended for all open belt drive installations.

700 Polished

42105 Chromed



Primo Starter Ring Gears

Designed as a replacement for OEM gears on BT models.

PCP Application

76024 Early Primo belt drive baskets (3 hole) (PP-118)

76025 Pre-Evo electric start Primo pulley (6 allen bolts) (PP-118-L-66)

76026 Sturgis (PP-118-S)

Belt Drive Pulleys

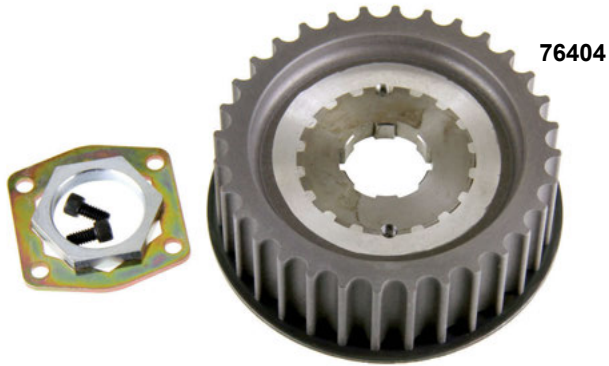

BDL 4 Spd Pulley BT 1979-84

PCP	BDL	Description
76401	TPSH-29	29T
76402	TPSH-30	30T
76403	TPSH-31	31T
76404	TPSH-32	32T (stock)
76405	TPSH-33	33T



Button Head Screws

5 piece set for rear belt pulleys on 1981-on FXSB. Replaces 3771. Includes TORX socket.

24020	Kit
24021	Screws and washers only



BT Chrome Rear Drive Pulley

Pulley fits 1.5" belt on Big Twin models 1980-99.
37229 70T



45007



45005

45008



45802



45006



Chrome Belt Drive Sprocket Insert Kits

Top-quality chrome-plating on formed 'deep dish' steel rear wheel belt pulley inserts. Sprocket insert kit includes a set of chromed button head Torx fasteners and 3/8" drive Torx bit.

PCP	Description
45008	Complete outer cover with hardware 8 holes 80-on w/70T (12 3/4"OD) (91733-85A)
45007	Insert only (12 3/4" OD) for 70T as above (91740-87A)
45802	Inner cover, 70T 1980-97 to fit above

Solid Inserts

45005	Insert only (12 3/4") for all 1980-on w/70T pulley (91740-87A)
45006	Complete with hardware (12 3/4")

Outer Primary



Vented Primary for FXE 1970-E84

This vented cover provides additional cooling and a custom look for a 4 speed Big Twin FXE 1970-E84 running a primary belt drive.

86000

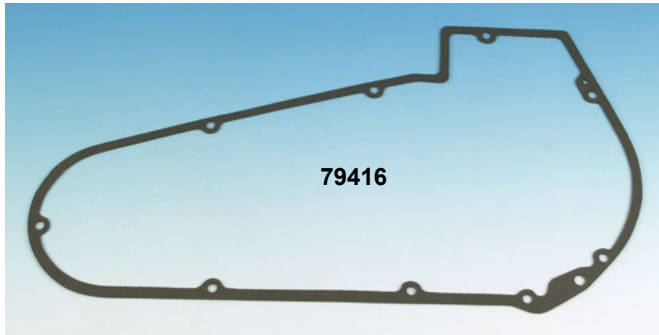

Primary Cover Gaskets for Big Twins

Replacement primary cover gaskets for Big Twins 1965-up, James Products where noted.

PCP	Application
79427	James 65-80 FL, FX .062 w/bead 8 hole (60540-65-A) (5 pk)
79416	James .062 as above 9 hole (60538-81-A) (5 pk)
79328	James 1979-82 FLT, FXR .030 (34901-79) (10 pk)
79330	James 1984-93 FLT, FXR .062 (34901-79B) (5 pk)
25153	1965-88 FL/FX .060 w/bead (60538-81A) (5 pk)
79417	James as above (5 pk) w/silicone (60538-81-C)



Stamped Steel Outer Primary

Replaces alloy cover on 1974-E84 FXE with thru-hole shifter. Bearing not included.

6196



2435



4700

Aluminum Primary Floorboard Mounting Kit

Fits BT 1965-84 FLH-FXE models equipped with FL type forward controls and primary cover with floorboard tab.

PCP	Application
2435	Complete kit 1966-82
5787	Kit for models with custom pipes
10874	Right front short stud FL 1970-E79 (50657-70A)
4700	Right rear bracket 1970-84 (50655-70)
10838	Right front stud 1970-84 (50659-70) zinc

Note: PCP# 5787 includes extended rear floorboard bracket when using custom drag or muffler pipes

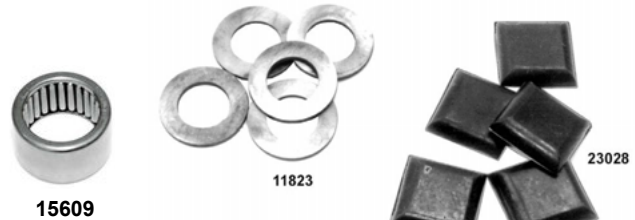

15609

11823

23028

Primary Hardware

PCP	Description
15609	Outer primary bearing 1965-88 (9063) (each)
11823	Starter shaft washer 1965-88 (31502-65) (5 pack)
23028	Kickstand bumper pad (50100-70) (5 pack)

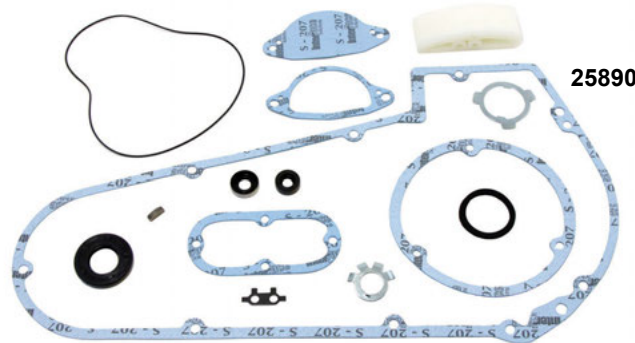

25890

Preston BT Primary Cover Repair Kit

This kit contains all the necessary parts that are required when making inner primary repairs, primary chain service, clutch hub service, or left side transmission repairs.

25890	1965-E82 4 speed
25891	L1982-84 4 speed
25892	1980-84 FLT-FXR

Outer Primary



6190



86009

FLH Primary Covers 1970-84 4 Speeds

PCP	Description
6190*	Chromed less hardware, 9 hole (60508-70)
6191*	Polished less hardware (60508-70)
86106	Polished & laquered, partial 9 hole with footboard tab
86034	Chrome 1982-84 9 hole for FL front belt with factory rear belt (60525-82)

*1/2" from gasket surface to bearing boss.



Matte Black Cast Outer Primary Cover

- Reinforced outer covers for 4 speed BT models

PCP	Fitment
86081	FX 1971-88 with small dowel pins
86082	FL 1970-84 4 Speed with rear chain

FXE Primary Covers 1970-82 4 Speeds

Add both beauty and strength to your motorcycle with the stronger-than-stock construction found in this reinforced die-cast outer primary cover. Has partially tapped ninth hole for nine hole applications. For 4 speeds.

PCP	Description
6192	Chromed FX, FXWG less hardware 1970-82 (60507-77)
86037	Chromed 1982-85 FXSB (front belt) with factory rear belt, includes screws, bearing, inspection & derby gaskets (60531-83B)
86009	Chromed FX models 9 hole 1983-85 less hardware .350" from gasket hole to bearing surface (small locate hole) (60531-83B)



FLT & FXR Primary Covers 5 Speeds 1980-84

Used on all 1980-84 FLT, Classic and 1982-84 FXR's. Cast construction to OEM specifications, supplied with no hardware.

6194 FLT 1980-84, FXR 1982-84 (60605-79B)



1756



5753



5355

Chrome Primary Cover Screw Kits

Acorn	Cap	Allen	Description
1756	5245	5348	BT 1936-64 (stamped steel)
1721	-	-	BT 1965-70 (cast aluminum cover)
1742	-	5354	BT 1971-on 4-speed
1735	5753	-	BT 1965-79 (pressed metal cover)
5247	5248	5355	BT 1980-84 5-speed

Inspection & Derby Covers

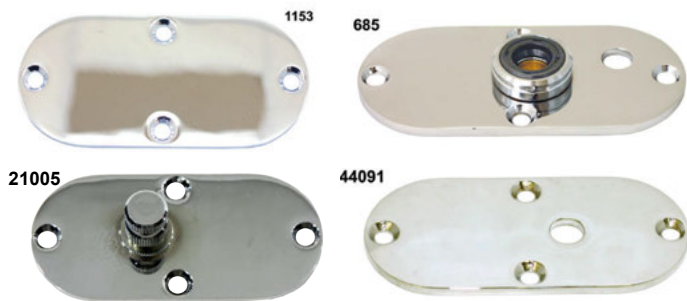

Chrome Inspection Covers

Flat steel covers for Big Twins with forward controls.

PCP Fits

1153 4 speed FL models 1965-1984 and FXWG models 1980-1985 (countersunk holes) (60572-78T)

Flat steel inspection covers for Big Twins with through-the-primary shift and/or foot peg mount.

PCP Fits

685 4 speed FX models 1974-1985 with through-the-primary shifter and foot peg mount (60579-74T)
21005 FL 1965-1977 with splined mount (60574-65)
44091 1971-73 FX with foot peg hole (60513-71)



Chrome Inspection Covers

For 1965-on BT alloy primary unless noted otherwise.

PCP Fits

44089 Billet
45527 Flywheel
45166 Flame



Domed Inspection Covers

For 1965-on BT alloy primary.

Chrome Black Type

44148 45388 Plain
45118 45386 Flames



Chrome Inspection Covers for 5 Speeds

Without Shift Holes

PCP Application

44504 FLT, FXR 1982-86 (forward control) (32519-80)

With Shift Holes

44503 FXR 1982-84 (60642-82)



FX Inspection Cover Bushing and Seal 1974-85

PCP Fits

14070 Seal (60641-74) (not FXWG) (5 pk)
18591 Bushing (60593-74) (each)

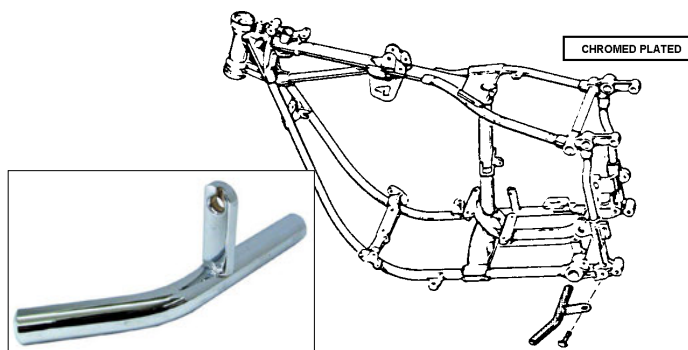

Case Saver BT 1958-84

A simple economical answer to saving those primary cases when you lay the bike over. Simple bolt on installation—Solid bar stock—Highly chrome plated. Installation bolt not included.

6588 Case saver

Inspection & Derby Covers



Flame Covers

Chrome plated diecast designs for BT 1970-on

PCP Description

45164 Derby cover

45165 Points Cover (holes F/T/B)



Finned Primary Cover Accessories

An assortment of accessories for 4-speed Big Twin primary covers as well as all Big Twin point covers. Available in chrome or with a durable black powder coat finish.

Chrome	Black	Fits
1369	3753	Derby cover 1970-98
3292	3754	Inspection with shift bushing 1974-85
44088		Inspection cover 1965-on
3102		Point cover (verticle screw placement)



Domed Derby Covers and Inspection Plates

Chrome plated covers with extra non-functional buttonhead Allen screws for that high-tech look.

PCP Fits

5486 Domed points cover

5488 Inspection cover (60572-78)

5489 Inspection cover FX 1974-on w/mid-shift (60579-74)

5490 Inspection cover FXR models 1982-84 except diaphragm clutch (60642-82)



Chrome Derby Cover

Three bolt type for 1970-98 Big Twin models. Order gasket separately.

PCP Type

1368 Dome (25414-70)

45719 Bonehead

45720 Maltese cross

45106 Black with raised chrome skull

45128 Chrome with black skull

Inspection & Derby Covers



59171



45482



45483

Chrome Skull Design Cover

PCP	Type	Application
45482	Points	1970-98 BT
45483	Points	1971-on XL
59171	Derby	1970-98 BT



"Live To Ride" Chrome Derby Covers

Die-cast aluminum construction with "Live to Ride" emblem. Fits BT 1970-98 models. Replaces OEM 25391-84T.

6592	Chrome
45210	Gold



3-D Derby

Features concealed mounting by use of plate which installs like a Derby. Chrome 3-D spinner cover mounts to stud on plate and is held firmly in place by O-ring. Backing plate may be painted to match colour scheme.

59002

59184



Chrome Maltese Cross Covers

PCP	Cover	Type
59184	Derby	3 Hole BT
59186	Points	2 Hole



45839



45444

Billet Iron Cross Derby and Point Covers

Features chrome Billet cover with chrome raised iron cross.

45839	3 Hole derby
45444	1970-99 Big Twins points cover

Chrome Pirate Skull Derby Cover

3-Hole cover fits 70-84 FL, FX, 82-94 FXR, 79-98 FLT.

45083



Chrome Derby with Raised Black Skull

PCP	Type	Application
45248	3-Hole	1970-84 FL, 1971-84 FX, 1979-98 FLT

Gaskets



James Gaskets FLT-FXR

PCP Application

- 25124**** 1979-85 .030 inner chain (34903-79) (10 pk)
79333 1979-85 inner chain .035 (34902-79-A) (10 pk)
79337 1979-84 inspection .030 (34906-79) (10 pk)
79338 1979-84 w/silicone-2 sides .060 (34906-79-A) (5 pk)
25127** As above no silicone, JAN'S (10 pk)

**Note: Not James

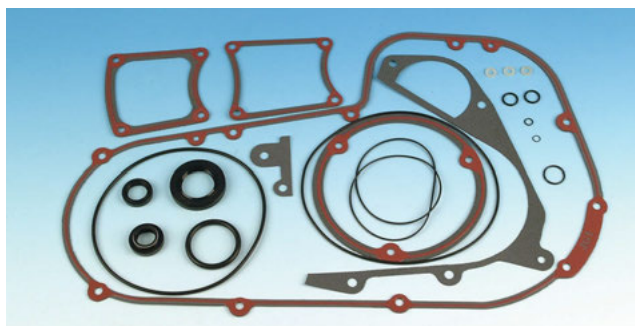

James Primary Gasket Kit

Fits FLT, FXR 1979-83 .062 primary.

79731 34901-79-K



James Gaskets

PCP Application

- 79424** Starter motor to primary FL, FXWG 1980-85 (60559-80) (10 pk)
79415 Starter cover FL, FX 1965-on (60518-65) (10 pk)
79433 Solenoid gasket FL 1965-80 (60645-65) (10 pk)
79431 Primary to engine BT 1955-64 (60629-55) (10 pk)



James Derby Cover Gasket

PCP Application

- 79291** FLT, FL, FXR, FX 1970-83 .030 (25416-70) (10 pk)
79293 As above, w/silicone .062 (25416-70-X) (10 pk)

Inspection Cover Gasket

- 79428** FL-FX 1965-on w/silicone 2 sides .062 (60567-65B) (5 pk)

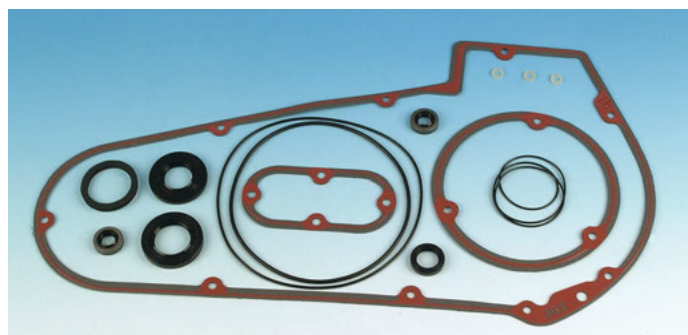

James Primary Gasket/Seal Kit

Fits 1965-86 FL and FX.

79723 60538-85-K

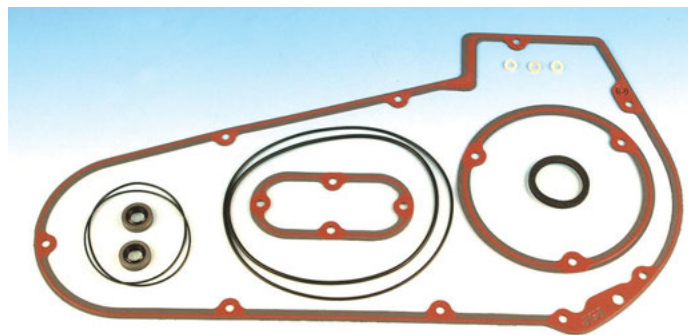

James Primary Kit

Fits 1966-86 FL w/silicone.

79722 60538-81-K



Crankcase Saver Kit

BT 1970-on

Metal gasket and lock plate only.
79839

Inner Primary

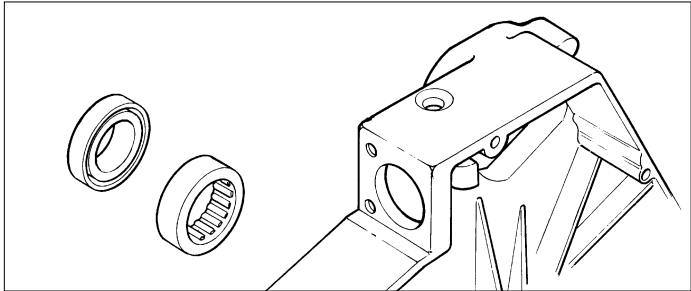

BT Inner Bearings

Bearing and Seal Kits			
One bearing and one seal.			
PCP	OEM	Application	Shielded
15742	9040	70-84 4 speed	Unshielded
14013	12018	70-84	Seal only 5 Pk
Bearings Only- Sold Each			
PCP	OEM	Application	Shielded
15740	9037	65-69 4 speed	1-side
15718	9040	70-78 4 speed	thin, unshielded
15719	9061	79-E84 4 speed	2-sides
15741	9061	70-84 4 speed	2 sides
15705	8975	80-06 FXR, FLT 5 speed	1-side



Jims Gasket Locator Tool

Fits 1/4"-20 thread on BT & XL 73-77. Replaces 96781-72.
31599

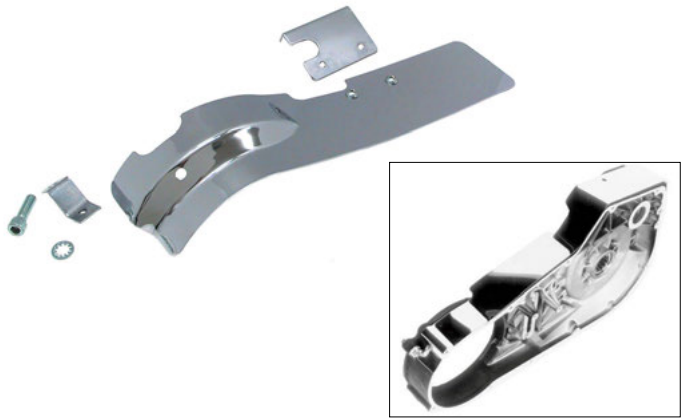

Chrome Inner Primary Trim Covers

Easily adapt to stock cast inner primary without complicated disassembly.

3167 1970-84 FX, FL



Inner Primary Mounting Bolts

24158 BT 1970-86 (4021) (10 pack)



Inner Primary Mounting Studs BT 1980-84

877 2-5/16" (16830-54) (4 pack)



Inner Primary Lock Tabs

Fits FLT, FXR 80-84. 10 Pack.

13728

Inner Primary



BT Block-Off Kit 4 Speed 1965-on

Zinc solenoid and starter hole cover kit FL-FX 1965-84.
3756 Kit (60646-65)



Inner Primary Lock Tab

One piece design eliminates the need for safety wire on Big Twins 1970-on
13726 (5 pack)

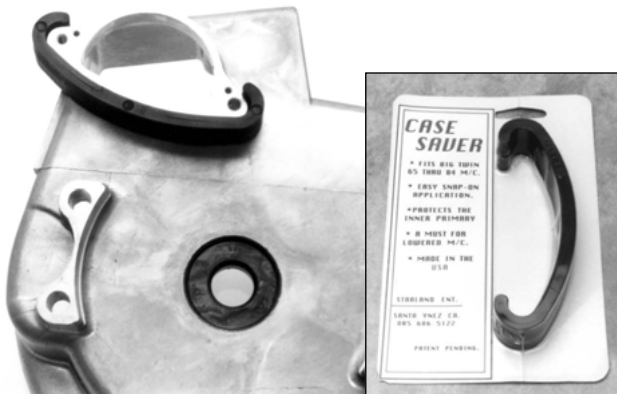

Case Saver

This reinforced nylon piece protects the inner case and starter housing area that can be damaged by the rear chain.
27143



Inner Primary Mounting Kit 1980-85

Complete hardware kit properly mounts inner primary on 1980-85 FL and FX models.
9869

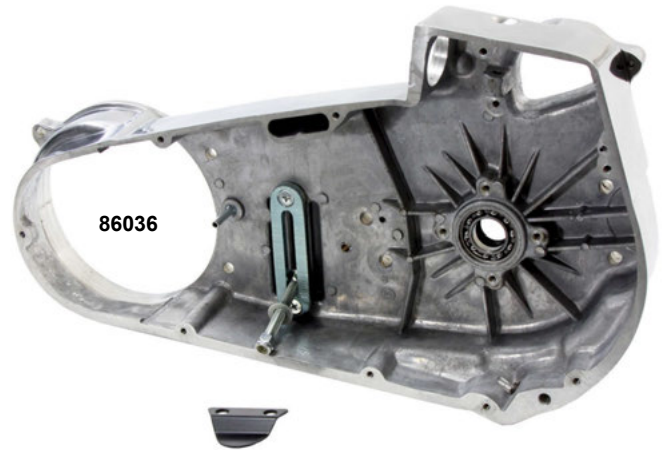

1971-84 FX and 1970-84 FL Complete Inner Primary Housing Assemblies

For 4 Speed models. Includes die cast inner cover in chrome or natural finish, without clear coating, bearing, seal, chain tensioner, detent plate, vent tube, chain oiler tube, and drain plug.

86035 1971-84 FX natural
86042 1971-84 FX chrome
86036 1970-84 FLH natural
86043 1970-84 FLH chrome

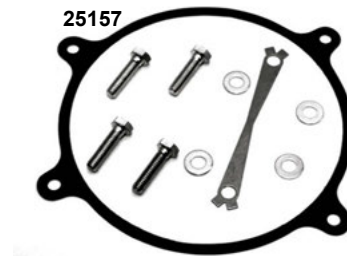

O-Ring Replacement Gasket 1970-85 4 Speeds

This inner-primary O-ring replacement gasket replaces the O-ring when the lip of the motor is partially or entirely broken off. To avoid extensive machine work, welding, time and money, just grind the partially broken lip smooth for installation.

25157 Alternator gasket
79839 James, steel gasket w/bead and lock tab only



Inner Primary Mounting Kit 1970-79

Complete hardware kit properly mounts inner primary on 1970-79 FL and FX models.
9868

4 Speed Primary 1970-84

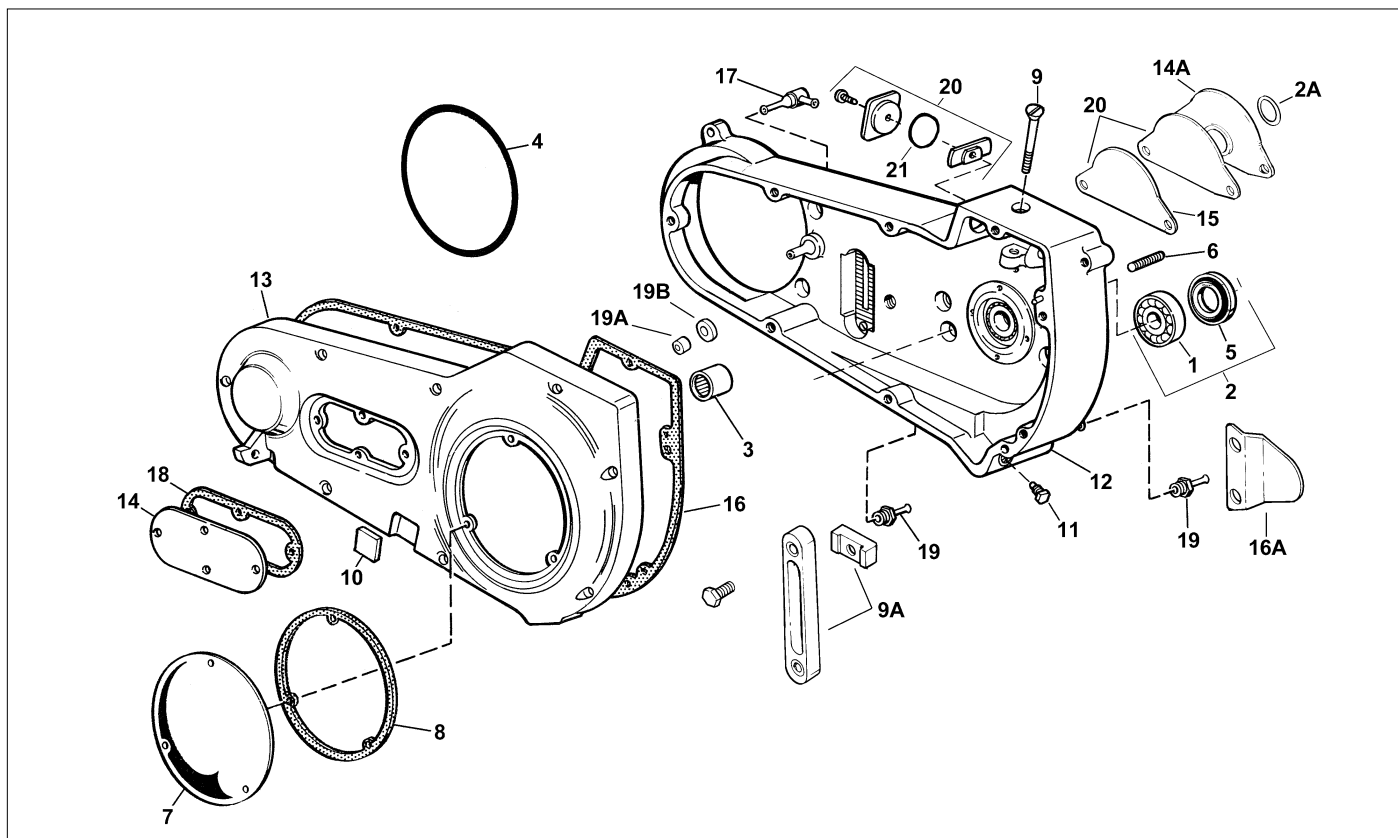

Front Chain Housing FLH-FX 1970-on

#	PCP	OEM	Description	
1	15718	9040	Ball bearing unshielded	
2	15742		Ball bearing and seal kit 1970-E78	
2A	14501	11101	O-ring L1966-86 (10 pack)	
3	15609	9063	Needle bearing 1965-88	
4	14515	11125	O-ring, inner cover 1970-82 (10)	
	79022		As above, James (10 pk)	
	14522	11147	O-ring, inner cover 1984-99 (10)	
	79033		As above, James	
5	14013	12018	Oil seal 70-E84 (5 pk)	
	79062		As above, James (5 pk)	
6	10828	24811-59A	Stud, start shaft housing 65-72 (5)	
7	1368	25414-70	Chrome derby cover 70-98	
8	79291	25416-70	Gasket, derby cover (10 pk)	
	79293		As above with silicone (10 pk)	
9	4026	31478-65	Blk top screw, chain housing 65-*	
9A	3747	39992-65A	Chain adjuster slide bracket	
10	23028	50100-70	Bumper, jiffy stand (5 pk)	
11	10618	60348-65	Magnetic drain plug 1965-*	
12	86013	60411-70	Front inner chain housing 70-84	
13	6192	60507-77	Chr. FXE primary cover 1970-82	
	6190	60508-70	Chrome primary cover 1970-85	
	6191		As above, polished FL with tab	
	86106		Polished & laquered FL 70-84	
14	685	60579-74	Chr. inspection cover FX 1974-85	
	1153	60572-78	Inspection cover FL 1965-*	
14A	4029	60516-65A	Deflector plate with o-ring	
15	79415	60518-65	Gasket, starter hole FX 1971-*	
16	79427	60540-65A	Gasket, housing cover .062 James 1965-80 (5 pk)	
16A	5493	60556-74	Primary baffle plate	
17	3757	60549-70	Chain oiler fitting	
18	79428	60567-65	Gasket, inspection cover w/silicone 1965-* (5 pk)	
19	10575	63533-41	Nipple, vent hose 1966-* (5 pk)	
19A	18591	60593-74	Shifter shaft bushing FX 1974-84	
19B	14070	60641-74	Shifter shaft oil seal FX 74-84 (5)	
20	3756	60646-65	Cover kit, starter and solenoid hole BT 1965-on	
21	79433	60645-65	Solenoid gasket (10 pk)	

Cast Inner Primary Covers

PCP	OEM	Year	Finish	Model
86013	60411-70	1970-84	Pol/9 hole	FL-FLH Chain
86109		1970-84	Cast natural FL	Chain 8/9 Hole
86096	60619-70	1970-84	Polished	FL-FLH Chain, With sealed mainshaft bearing
86006	60441-82A	1970-84	Pol/9 hole	FX-FXE Chain
86108	60441-82A	1970-84	Pol/9 hole	FX-FXE Chain
86012	60421-79A	1970-84	Chrome	FX-FXE Chain

For 9 hole inner primaries you must use 9 hole outer primaries.

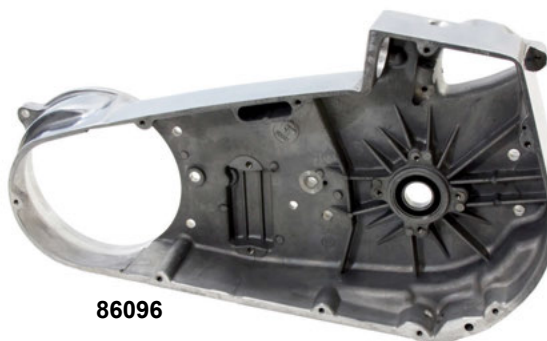

86096

FL 1965-69 Primary

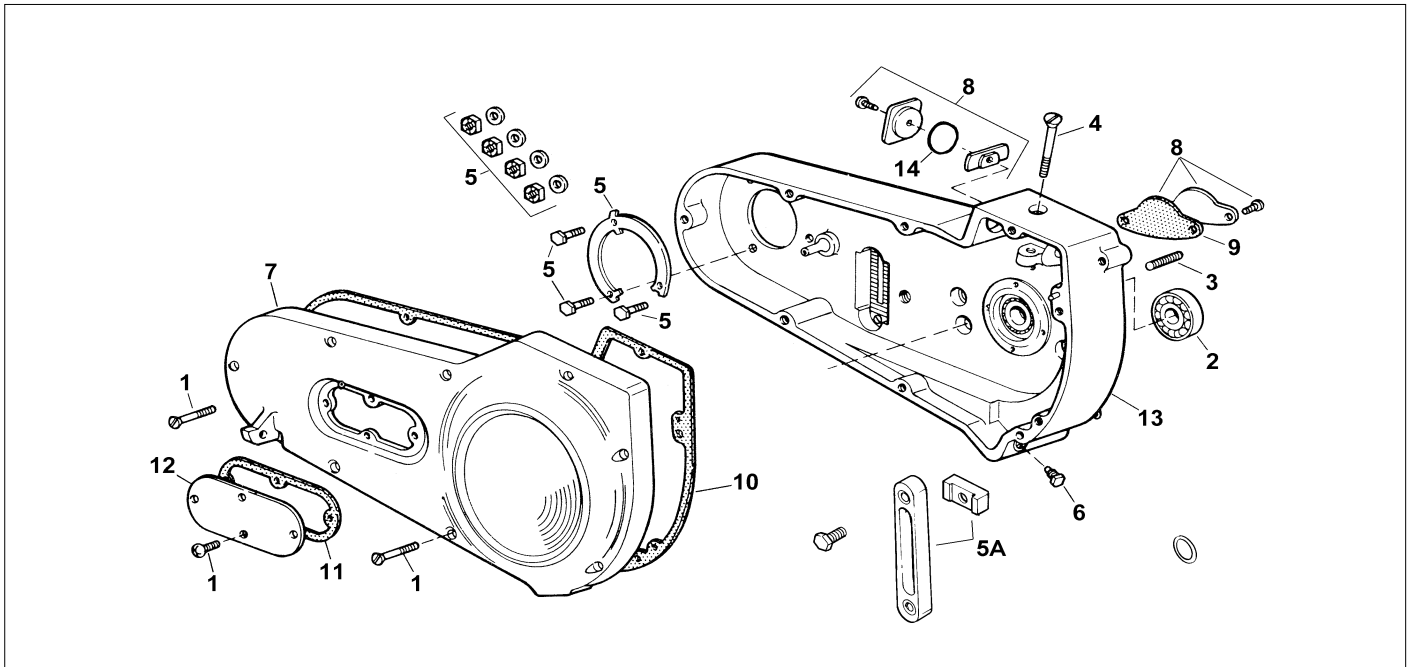

FL Front Chain Housing 1965-69

#	PCP	OEM	Description
1	1721	7146-12	Acorn screw kit, chrome (12 pc)
	5390	8799-12	Slotted screw kit, chrome (12 pc)
	5391	8800-12	Slotted screw kit, cad (12 pc)
2	15740	9037	Bearing and seal kit, inner housing
3	10828	24811-59A	Stud, starter shaft housing (5 pk)
4	4026	31478-65	Top screw, chain housing, black (ea)
5	5389	31479-65	Bolt and lock plate kit (12 pc)
	10545	45830-48	Plug, chain housing vent hole 1965
5A	3747	39992-65A	Chain adjuster slide bracket
6	10618	60348-65	Magnetic drain plug
7	N/A	60508-65	Outer cover
8	3756	60646-65	Cover kit, starter & solenoid hole

#	PCP	OEM	Description
9	79415	60518-65	Gasket, starter hole cover
10	79427	60540-65	Gasket, primary .062 8 hole James (5)
11	79428	60567-65B	Gasket, inspection cvr James (5 pk) w/silicone (5 pk)
12	1153	60572-78T	Chrome inspection cover
	21005	60574-65	As above, with spline mount
13	86028	60617-65A	Inner housing, cast finish with trans mainshaft bearing
14	79433	60645-65	Solenoid gasket (10 pk)



Big Twin 1965-1969 Cast Inner Primaries

Replaces OEM 60617-65A. Available in a natural cast finish.
86028 Import with bearing



Inner Primary Mounting Kit

Complete hardware & lock kit to properly mount cast aluminum inner primary cover to case on Harley Big Twins 1965-1969.
5389



Outer Primary Cover Kit 1965-69

Includes polished or chrome outer primary cover, chrome derby cover, chrome inspection cover, starter shaft extension, gaskets and screws.

86044 Polished
86045 Chrome

Primary Cover Accessories

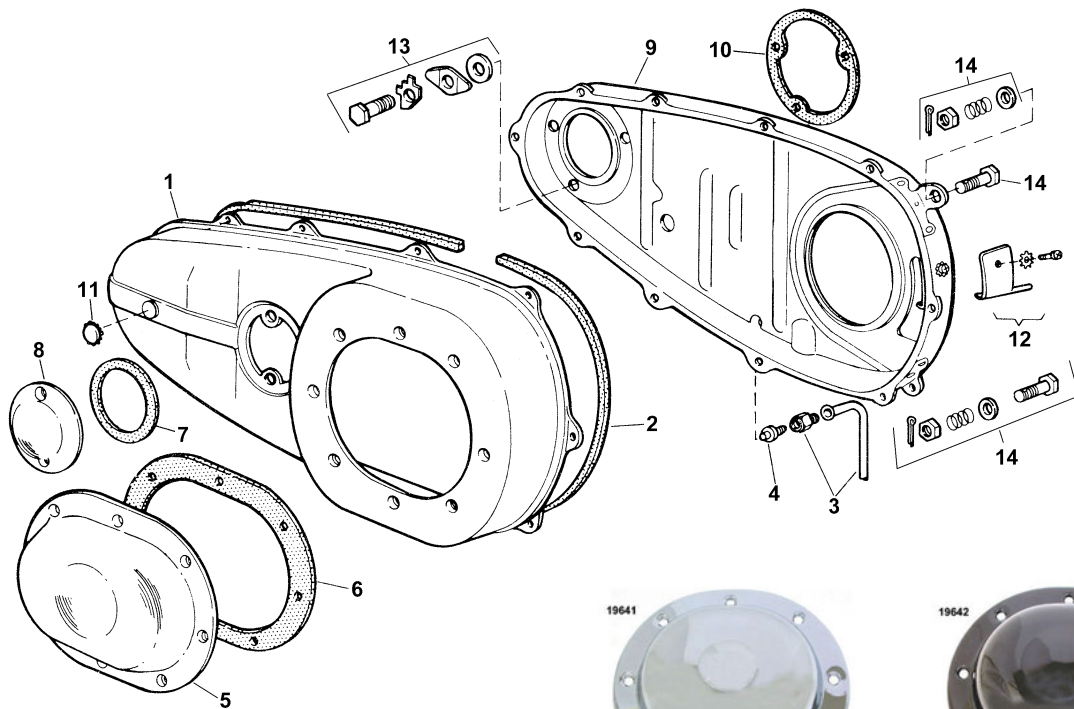

Front Chain Housing 1936-64

#	PCP	OEM	Description
1	6475		Chrome outer "Diamond" housing 36-54
	6476	60505-55	As above 1955-64
2	25155	60540-36	Gasket, housing cover (ea)
	79422		James as above (10 pk)
3	19376	60546-36	Cad drain pipe, & nut 1937-57
	19377	60546-59	Cad, as above, late 1958-64
4	19378	60548-36	Primary cover nipple for drain pipe
5	19641	60555-36	Clutch derby cover, chrome
	19642		As above, black
6	25158	60565-36	Gasket, clutch cover (10 pk)
	79425		James, as above (10 pk)
7	79426	60567-36	James inspection gasket (10 pk)
8	44077	60573-36	Inspection cover, chrome
9	6186		Chrome inner primary 1936-54
	6187		As above 1955-64
10	79431	60629-55	Gasket, chain housing back 55-64 (10)
11	73533	60650-54A	Plug, chain housing 1954-64 (5 pack)
12	19381	63591-62	Rear chain oiler kit 1954-64
13	1811		Inner primary mount kit 55-64 (12 pc)
14	9601		Parkerized case mount kit (10 pc)
	72071		Chrome, as above

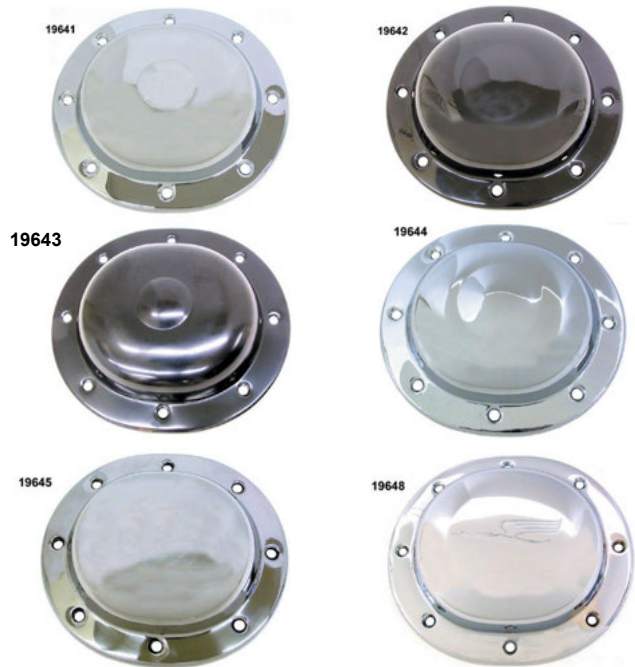

Derby Covers for Tin Outer Primary 1936-64

Chrome unless otherwise stated.

PCP	OEM	Description
19641	60555-36	Derby with dimple
19642	60555-36	As above, black
19643	60555-36	Replica black with dimple
19644	60555-36	Replica chrome with dimple
19645		Replica SS with dimple
19648		Chrome bird Derby



Inspection Covers

PCP	Description
44073	BT Flat (60572-36)
44075	BT Black
44076	BT Replica black
44077	BT Replica chrome
44078	BT Replica SS
44079	Flat XLCH 1952-70 models (60569-29)

Tin Primary Covers



19826



6476



6475

Chain Case Cover

Black	Chrome	Chrome Paughco	Years
19826	6475	75060	36-54
19827	6476	75061	55-64



1735



1756

Tin Primary Cover Screw Kits

1735 74 1965-69 Stamped cover acorn
1756 1936-64 Acorn



5195



5390



9307

Stock Primary Cover Screw Kits

Chr.	Cad	Application
2161	5195	BT 1936-64 (slotted)
5390	5391	BT 1965-69
9307	9308	Shovelhead 1970-80

871



911



Chrome Derby and Inspection Covers 1936-64

Finest plating and heavy-gauge material, fits all 74s with steel primary covers.

871 Inspection cover
911 Derby cover

19863



19864



1936-54 Big Twin Replica Outer Primary Cover

Accurately shaped for proper fitment.

Black	Chrome	Years
19879	-	36-40
19863	19864	41-54

19873



19874

Outer Primary Cover for BT 1955-64

Order plug separately.

PCP	Finish
19873	Black
19874	Chrome
73533	Plugs
25649	Primary gasket and plug kit

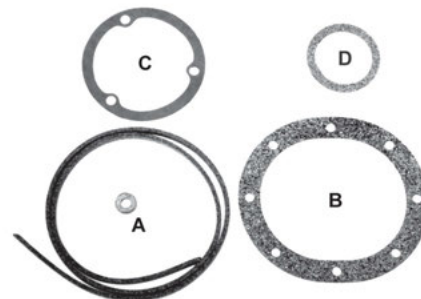

Primary Gaskets 1936-64

Fits 1936-64 U, UL, ULH, E, EL, FL, FLH.

James	Jans	Description
79422	25155	(A) Chain cover gasket (cork) (10 pk) (60540-36) (Jans sold each)
79425	25158	(B) Clutch cover gasket (cork) (10 pk) (60565-36) (Jans sold in a 10 pk)
79431		(C) Engine case to inner primary 1955-64 FL, FLH (60629-55) (10 pk)
79726		Kit including all pieces shown
79426		(D) Inspection (cork) (60567-36) (10 pk)

Inner Primary



Replica Inner Primary Covers

Features installed drain fitting.

Black Chrome Application

19848 1936-54 (60626-36)

19849 19852 1955-57 (60620-55)

19853 1958-64 (60620-58B)



Inner Primary Mounting Kit

Complete mounting kit contains reproductions of the original hardware used to mount a stamped steel inner primary cover on Big Twins 1955-64.

1811

Inner Primary Mounting Hardware Kits

Includes hardware required to mount a stamped steel inner primary cover to the engine. May also be used when converting a 65-69 FL to a stamped steel cover.

PCP Fits

1810 1937-54 Big Twin H-D #60554-36

Inner Primary

Reinforcement Ring

Use on all Big Twins 1936-54. Helps strengthen weak tin inner primaries.

5484



Rear Chain Oiler BT

1955-64

Fits on rear of inner primary.

19381



Rear Chain Oiler Kit 1954-64

Replaces 63591-62 on rear of inner primary cover. Includes screws.

PCP Description

19378 Rear chain oiler nipple (60548-36)

19376 Oil drain 1937-57 (60546-36)

19377 Oil drain 1958-64 (60546-59)

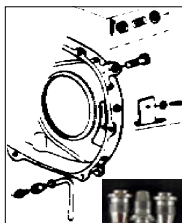

Steel Inner Primary Covers 1936-80

1936-54 Covers have a small hole at motor end and 1955-69 covers have a large hole at motor end for a splined sprocket shaft. PCP# 6188 allows use of 1955-64 type compensator outercover on alternator types but electric start must be sacrificed.

Black	Chrome	Chrome Paughco	Years
19828	6186	75062	36-54
19829	6187	75063	55-64
-	6188	75064	70-80 Alternator type

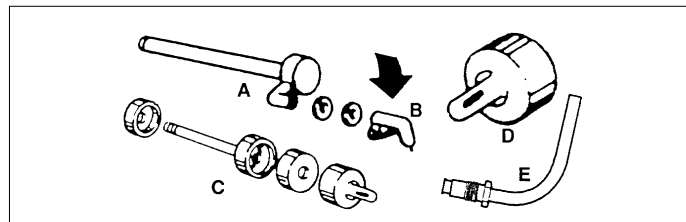

BT Primary Breather Tubes

PCP Description

10904 (A) Stud and oiler 1948-57 (24912-48A)

19308 (B) Snoot 1936-57 (24918-64)

17500 (C) Breather stud kit (all) 1958-64

1379 (D) Rubber Nipple 1958-64 (24918-58)

17506 (E) Tube with nut 1965-66, zinc (24912-65)

17507 (E) Tube with nut 1967, zinc (24913-67)

Sportster Primary



Colony XL Primary Screw Sets

Cadmium Stock Type Screws

PCP	Application
9851	XL, XLH 1957-66
8891	XLCH 1964-69

Chrome Allen Type Screws

9753	XLCH 1957-69
5376	XLCH, XLH 1971-76
5379	XLCH, XLH 1977-85

Chrome Acorn Type Screws

1698	XLCH, XLH 1957-69
1723	XLCH, XLH 1971-76
1791	XLCH, XLH 1977-84

Chrome Cap Type Screws

2867	XL 1977-85
------	------------



Filler and Clutch Caps

These chrome caps fit adjuster on XL 1977-84 models.

44098 Set

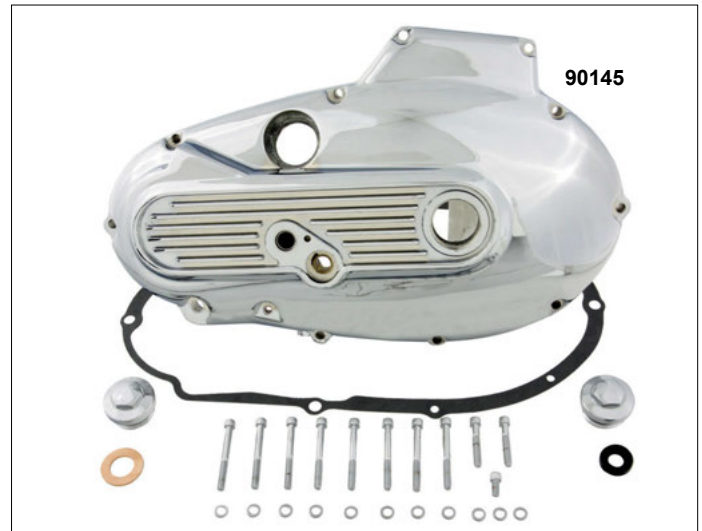

Chrome Primary Cover Kit XLH-XLCH 1971-83

Kits include chrome die cast outer primary cover, inspection cover clutch adjuster cover, gasket and chrome allen screw set.

PCP	Application
90144	1971-76 generator
90145	1977-83 generator



Primary Chrome Filler Cap & Clutch Hole Cap

XL Custom chrome plated steel caps have a 15/16 hex to facilitate installation and removal with a standard wrench.

1773	Filler cap 1971-76 (each)
1774	Clutch adjuster cap 1971-76 (each)
1779	Filler cap & clutch adjuster 1977-84 (each)
5367	Adjuster clutch hole & filler 1985-90 (2 needed) (ea)

Chain Housing Needle Bearing

Use for starter drive. Replaces #9063. Use on 1965-88, 74", 1967-on XLH.

15609



Sportster Primary

86021



86021 Chrome 1971-76 (34949-71)
86019 Polished 1971-76 (34949-71)



4874 Chrome tin (Paughco) 1958-69 XLCH (34949-64)



86022 Chrome 1977-83 (34949-75A)



67648 Polished cover 1977-83 (34949-75A)

Primary Cover Filler Cap & Clutch Hole Cap

Custom chrome plated steel caps have a 15/16 hex to facilitate installation and removal with a standard wrench. Now available for Sportsters 1977-84. 2 required per motor.

1779 Each

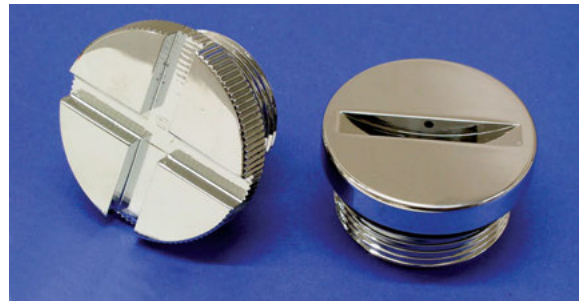

XL Chrome Primary Cover Caps

44097 Set for 1971-76



Colony Primary Cover Filler Cap

Reproduction of original aluminum plug (34742-71) to fit 1971-76 Sportster.

72559



Colony Clutch Adjusting Hole Cap

Reproduction of original aluminum cap (37880-71) to fit 1971-76 Sportster.

72557

Sportster Primary



Primary Cover Filler Cap

Reproduction of the original aluminum primary plugs to fit 1954-70 Sportster. Replaces 34742-52A and is available in chrome plated steel or aluminum.

- 72144** Aluminum
72145 Chrome



Primary Cap Installation Tool

Use to prevent damage to primary caps on 1954-70 XL
5800

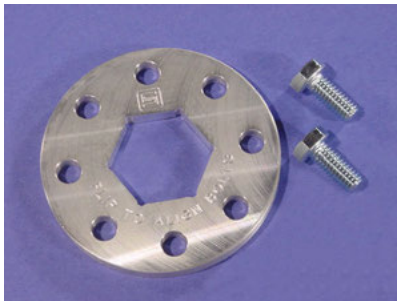

Motor Sprocket Nut Lock Plate for XL 1967-90

Plate is held in place by 2 hex bolts which are threaded into the stock non-compensating sprocket. Constructed of aluminum.

12610

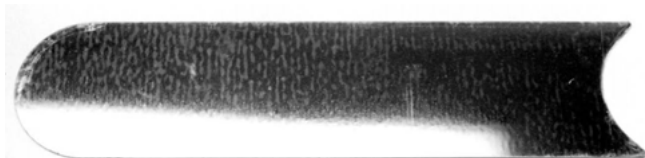

Inserts for Sportster Primary

Available in chrome steel supplied with an adhesive back, to fit in recess in aluminum primary cover. Each.

- 22197** Chrome 1971-76

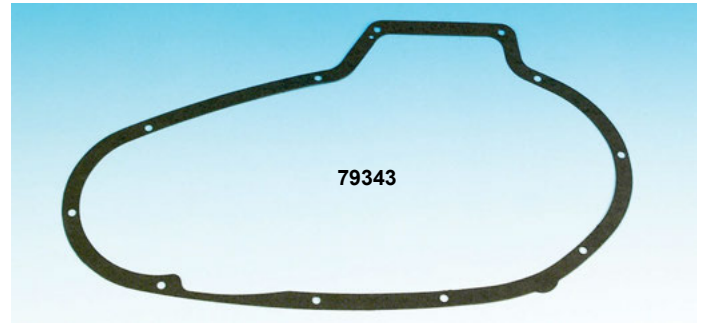

Sportster Primary Gasket

James Application

- 79341** .062 XLH, XLCH 1952-69 (34952-52-A) (10 pk)
79342 .020 XLH, XLCH 1967-76 (34955-67) (10 pk)
79343 .030 XLH 1967-76 (34955-67-A)(10 pk)
79344 .030 1977-90 (34955-75) (10 pk)



James Sportster Chain Cover Gasket Kit

James Description

- 79727** 1977-90 (34955-75-K)
79728 1977-90 w/silicone (34955-75-X)

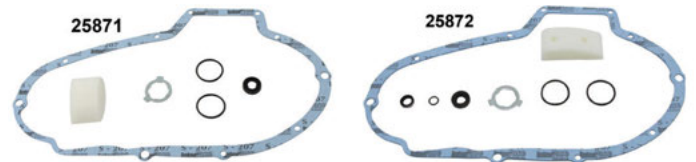

XL Primary Cover Gasket Kit

Includes gaskets and small parts for left side repairs.

PCP Fit

- 25871** 1977-1979 XL, XLH
25872 1980-1989 XL

Sprockets

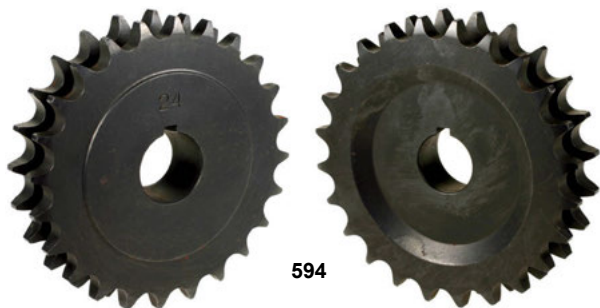

594

Taper Motor Sprocket Fits BT 1936-54

Steel sprockets, assorted sizes to accomplish the gearing you want.

PCP	# of Teeth
2486	22 (40209-30)
593	23 (40210-30)
594	24 (40211-30)
595	25 (40212-30)

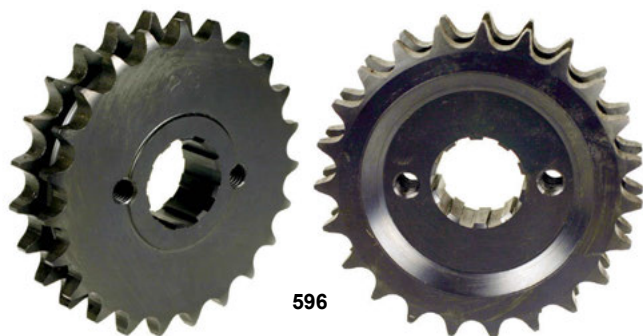

596

Spline Motor Sprocket Fits 1955-on

Steel sprockets, assorted sizes, to accomplish the gearing you want.

PCP	# of Teeth
2485	22 (40209-55)
596	23 (40210-55)
597	24 (40211-55)
598	25



BT Sprocket Nut and Locktab Set 1955-On

Locks nut by using 2 tabs which fit into sprocket holes when non-compensator sprocket is used.

12632

Motor Sprocket Nuts

PCP	Application (Each)
12524	XL 1957-69 (8025)
12568	XL 1970-88 (40387-70)
12537	BT 1930-54 (24003-30)
12538	BT 1955-69 (24003-55)
12569	BT 1970-90, 2-1/2" (40392-70)



12569

12568



284



257

Rear Brake Drum Sprocket Replacement Kits

Steel rear wheel sprockets. BT 51 tooth complete with rivets and dowel pins. Mechanical type, with rivets included. Hydraulic sprocket kit complete with 20 rivets.

PCP	Fitment
284	1957-78 XL, XLCH, XLH (41470-70)
257	1930-57 All BT except 1936-61 models (41470-30)
10141	1937-72 BT Brake shell dowel pins (41425-37) (5 pk)
4538	1958-61 FL, FLH, Hydraulic (41470-58)
254	1962-66 FL, FLH, Hydraulic (41470-62)
251	1967-72, FX, FL, FLH, Hydraulic (41470-67)



3282

Compensating Sprocket

These sprockets fit FL late 1970-82; FL Classic 1970-81 and FX 1971-83.

PCP	Tooth
3279	23 (40282-70)
3282	24 (40275-70)



Complete Rivet Dowel Pin Set

Especially made for drum brake, hydraulic and XL type sprockets. Cadmium plated, or black finish.

PCP	Fitment
285	Mechanical 1930-59
252	Hydraulic 1967-72
285	XL-XLCH 1954-78

Sprockets



USA Trans Sprockets

USA made transmission sprockets for all Sportster and Big Twin models from 1936-on. These sprockets are fully hardened for maximum service and performance.

For Big Twin Models 1936-79

PCP	Tooth
5080	22 (35203-36)
5081	23 (35212-73)
5082	24
5083	25

For Big Twin models 1980-85 (With 4-Speed Transmission)

PCP	Tooth
5085	22 (33338-83)
5086	23 (33337-83)
5087	24
1281	Sprocket spacer L1980-81 (35079-80)



XLCH Motor Sprocket-34 T

PCP	Description
43612	Sprocket 1954-69 (40288-58)
43613	Sprocket 1970-76 (40235-70A)
43614	Sprocket 1977-90 (40235-74)

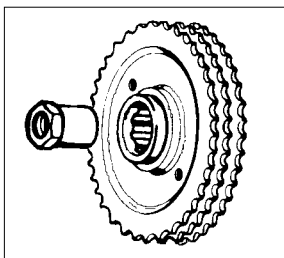

Heavy-Duty Imported Transmission Sprockets

High quality imported transmission sprockets, a lower cost alternative to our line of USA made transmission sprockets.

For Big Twin Models 1936-79

PCP	Tooth
2487	22 (35203-36)
599	23 (35212-73)
600	24
601	25
1281	Sprocket spacer (35079-80)

For Big Twin Models 1980-85 (With 4-Speed Transmission)

2489	23 (33337-83)
2490	24 (35212-80)
2491	25
1281	Sprocket spacer (35079-80)

For Big Twin Models 1980-84 (With 5-Speed Transmission)

3621	22 (33336-83)
3622	23
3623	24



USA Sportster & K 1954-E79

PCP	Teeth
5961	21 (35205-52A)
5962	22
5963	23
5964	24

Sportster Models L1979-E84

5092	21 (35205-79A)
5093	22
5094	23

Sportster Models L1984-90

5095	21 (35208-84)
5096	22
5097	23



Offset Sprockets (1/4" offset)

Fits XL models which allows the use of a 150 series tire. Order rear sprocket spacer separately.

4 Speed 1984-90

PCP	Teeth
43622	19T
43623	20T
43624	21T
43625	22T



Heavy-Duty Transmission Sprockets

Sportster & K 1954-E79

Seal Side .435"

PCP	Tooth
2484	20 (35198-52A)
603	21 (35205-52A)
604	22

Sportster Models L1979-E84

Seal Side .500"

2492	20 (35205-52A)
2493	21 (35205-79A)
2494	22

Sportster Models L1984-90

4539	21 (35208-84)
4540	22
5965	23
5966	24

Sprockets



BT 1/4" Offset Rear Sprocket & Spacer Kit

This kit mounts wider rear tires on Big Twin 1973-85 4 speeds. Kit includes special 1/4" offset transmission sprocket, rear sprocket spacer plate and mounting hardware.

PCP Teeth

43608 22T

43610 24T

Note: Kit is designed to ease the problems encountered on some custom applications. 1979-85 FX models will require modifications, including changeover to a Prestolite starter.



Solid Motor Sprocket Conversion Kit

The conversion kit replaces the compensator unit and sprocket. Includes nut.

PCP Description

43617 24T FL 1970-84, FX 1980-84

43618 25T FX-FL 1970-84



59459

Chrome 5-Spoke Sprockets

Offers a 9.8mm offset.

Offset Teeth

59459 48

59460 51

43503



43500



Chrome-Plated Rear Sprockets with Cutouts

Slotted chrome rear wheel sprockets match the front brake rotors used on all 1984-on. For Big Twin 4 speeds 1973-85 and Sportster® 1979-81.

43503 51 tooth

Chrome-Plated Solid Rear Sprockets

"Solid" chrome plated rear wheel sprockets. Fits all 4-speed Big Twins 1973-85 and Sportster® 1979-81

43500 51 tooth



Chrome Rear Chain Sprocket Covers

Sprocket covers for the stock rear sprockets on many Sportster® 1979-81 and Big Twin 1973-85. These steel covers are chrome-plated and install over the stock-plated OEM rear sprockets. Use your stock mounting hardware or Colony custom kits.

45801 Big Twin 4 speeds 1973-85 & Sportster 1979-81 51T

Note: The covers with holes listed above will **ONLY** fit Harley-Davidson® sprockets, and will require rotating them to the sprocket to get all of the holes to line up.



Chrome Plated Rear Sprocket Hardware Kit

Includes flat head allen screws, locknuts and companion countersunk washers. Fits 1973-on.

PCP Application

9856 FL, FX, XL w/chain drive spoke rear (41197-73)

9857 FL, FX 1973-on, XL 1973-91 w/cast rear wheel including belt drive (3769). Locknuts not included.

Rear Sprockets

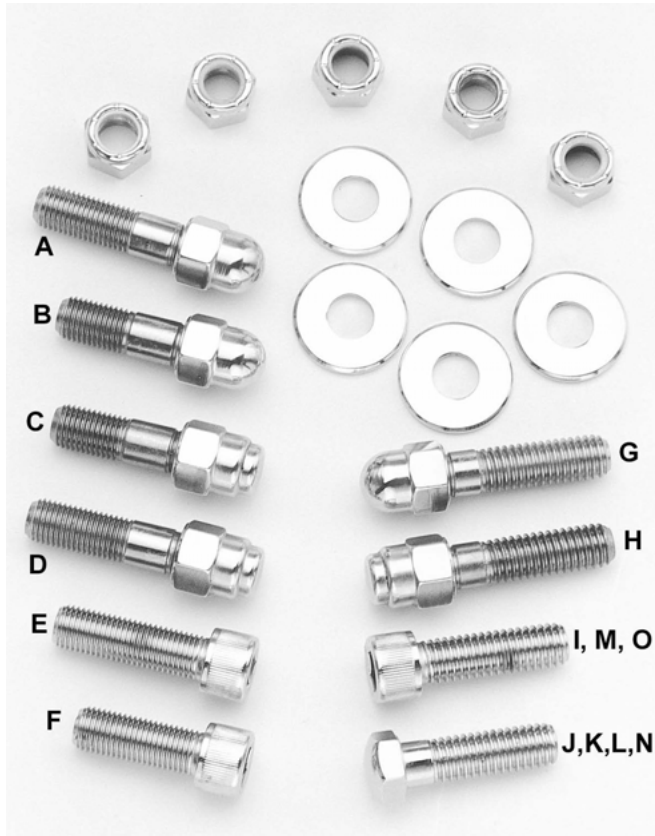

CHROME PLATED REAR SPROCKET HARDWARE KITS

Sprocket bolt & nut Kit fits 1973-on FL, FX, XL with spoke rear wheel. 7/16x20, OEM# 41197-73

4364	B	Acorn style
4368	F	Allen style
9609	J	Domed hex style

Sprocket bolt & washer kit fits 1973-on FL, FX, XL with cast rear wheel including belt drive. 7/16x14, OEM# 3769

4370	H	Cap style
4371	I	Allen style
9608	K	Domed hex style



Sprocket and Disc Spacers

Spacers provide offset when required.

PCP	OEM	Description	Thickness
3376	41814-76	1976-81	1/16"
11855	40932-81	1981-on	3/16"
11856	Allo	1973-on	1/4"
11857	Alloy	1973-on	5/16"



Rear Disc Brake Sprockets

Various sizes are available in our rear sprockets for Big Twins 1973-84 and Sportster's 1979-81. Plain or chrome-plated.

Plain

PCP Tooth (Dished)

524	48
3542	49
523	51 (41470-78T)

Chrome

526	48 (41470-78)
2483	49 (41470-73)
525	51 (41470-78T)

Chrome Sprockets for FXR Models 1982-85

FXR models (except FXRT, FXRP) with rear chain drive.

PCP Tooth (Dished)

3549	46
5967	47
2543	48 (40954-81C)
3281	51 (40954-83)

Chrome Sprockets for Sportster's 1982-85

PCP Tooth (Flat)

3761	48 (41470-82T)
1235	51 (41464-81)



Chrome Lazer Style Sprockets

Sprockets have a 9.8mm offset and feature a milled centre design. Sprockets fit FL, FX 1973-84 and XL 1979-81 chain drive models.

PCP Teeth

59233	48T
59234	49T

Chain



Standard

Diamond 530 standard is the mainstay of the motorcycle chain. It has been continuously upgraded by raw material selection, improved heat treating methods and innovative manufacturing and production techniques to keep it in step with the demands of today's motorcycles.

PCP	Size	# of Links
2642	530STD	100
2643	530STD	102
2644	530STD	104
2645	530STD	106
4641	530STD	108
2646	530STD	110
4642	530STD	112
4643	530STD	120
2647	Master links	(5 pack)



2656



2657

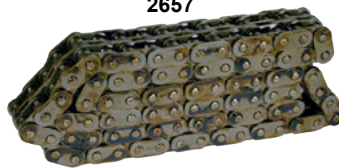

2658



Diamond Primary Chains

Endless link diamond chain for primary drive replacement on Big Twins, FLT and XL. Chain type links.

PCP	Size	Fitment
2657	428x2-82	1936-06 BT (not FLT-FXR) (40007-36A)
59480	428x2x80	Special length
2658	428x2-76	1979-06 FLT-FXR (40037-79)
2656	35x3-94	1957-03 XL (for 34T sprocket)
2654	35x2-96	1938-on Servi-Car
2655	35x2-100	1929-52 45 Solo
5528	428x2x88	1930-36 VL G models (endless)

XDL Self Lube

530 XDL eliminates the possibility of hit and miss lubrication, as it has a constant and consistent lubrication in the pin bushing (wear) area. This chain combines the high strength and capacity of Diamond's proven performance with the advantages of fewer adjustment and less maintenance.

PCP	Size	# of Links
2637	530XDL	102
2638	530XDL	104
2639	530XDL	106
4546	530XDL	108
2640	530XDL	110
4547	530XDL	112
4548	530XDL	120
2641	Master links	(each)



Diamond Spare Parts Kit

Includes: 2 master links, 1 link and 1 offset link for all 530 heavy-duty chain.

4644 Spare parts kit



53066

TYK Brand Primary Chains

Shot peened heavy duty oval side plates and solid roller construction. One piece riveted design with no master link.

PCP	Links	Application
21987	76	FLT 79-06, FXR 82-94
21986	82	FL 65-84, FX 71-84
21988	82	FL 41-64, EL 36-52

Rear O-Ring Chain

Natural finish 530 x 120 link o-ring rear chain with master link. Fits FL 1941-85

21990



Primary Chain Drive Systems for BT

Kit includes 82 link Diamond primary chain, chain shoe adjuster assembly, clutch drum basket with starter ring gear and steel & fiber clutch plates with pressure plate assembly. Correct front compensator sprocket assembly includes all parts necessary for installation, including sprocket nut. All pre 1985 FLH-FX 4 speeds require 82 link primary chains.

82 Links Year

53084	1970-84
53066	FL 1965-69 Also has a 24T sprocket kit
53067	FL 1955-64
53068	FL 1955-64. Does not include compensator
53069	FL 1936-54

76 Links

53092	FLT 79-84
-------	-----------



530ENP Nickel Plated

Diamond chains are also available nickel plated, which offers rust-proof protection along with a brilliant chrome-like finish. Each part of these nickel plated chains is individually plated before assembly to insure maximum coverage.

PCP # of Links

2648	100
2649	102
2650	104
2651	106
4648	108
2652	110
4647	120
2653	Master links (each)



530 Parkerized 120 Link Chain

21885

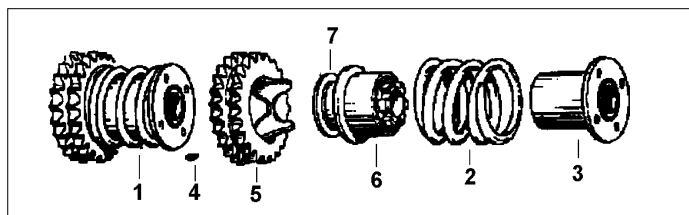

BT Compensator Parts 1955-69

#	PCP	Description
1	29075	Complete kit
2	13244	Spring (40302-55A)
3	12624	Nut (40385-55)
4	10316	Key (40390-54)
5	29095	24T Sprocket (40275-55A)
6	29096	Slide cam (40292-55A)
7	29097	Sprocket shaft extension



530XLO Diamond O Ring Chain

The features contained within the linkplates of Diamond 530XLO include a .214 Diamond pin which has been produced using a special alloy steel and case hardened for optimum strength and toughness, heavy series inside and outside linkplates, special constructed extended solid brushings, true wall solid rollers, quad staked pin heading, a whopping 9300 lbs. average tensile strength.

PCP # of Links

4800	102
4801	104
4802	106
4803	108
4804	110
4812	112
4813	120

XLO Connecting Links

4788	Each
------	------



Chain Breaker

Good for cutting 530 chain
26039

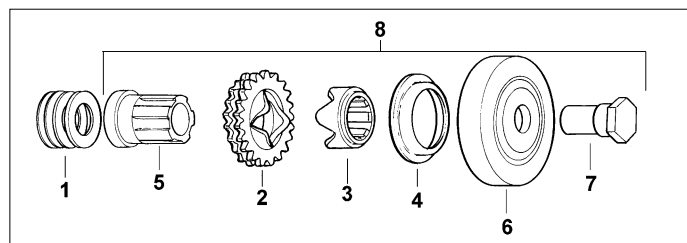
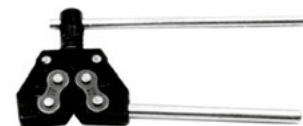

Compensator FL, FX L1970-82

#	PCP	Item
1	11850	Spacer .010 (35850-84) (5 pk)
	11851	Spacer .020 (35951-84) (5 pk)
	11852	Spacer .032 (35852-84) (5 pk)
	11810	Spacer .060 (24032-70)
	11811	Spacer .090 (24033-70)
	11812	Spacer .120 (24034-70)
	11813	Spacer .150 (24035-70)
	11814	Spacer .180 (24036-70)
	11815	Spacer .210 (24037-70)
2	3282	Sprocket 24T (40275-70)
	3279	Sprocket 23T (40282-70)
3	43407	Slide cam 1970-83 (40299-70)
4	29071	Cup (40324-70)
5	29072	Extension (40375-70)
6	29073	Retainer & cover assy w/springs (40384-70)
7	12569	Nut (40392-70)
8	29074	24T Kit as pictured (no spacers) (40270-65A)

Chain Related

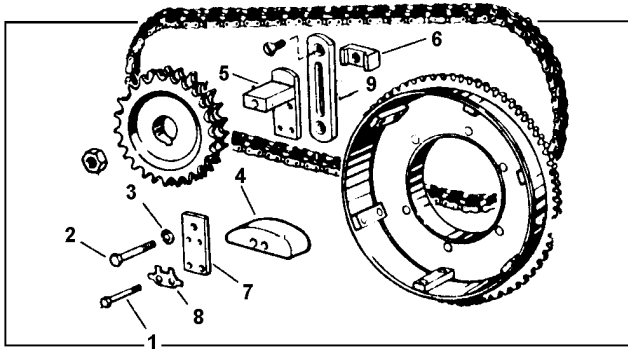

Chain Tensioner Parts

Items listed below fit 1965-84 4-speed Big Twins.

PCP	Type
24034	(1, 2, 3, 4, 7, 8) Hardware kit
1190	(4) Nylon pad (39976-65B)
13731	(8) Lock (39996-65) (10 pack)
27113	(5) Shoe (39990-65)
17502	(7) Plate (39993-65)
3747	(6,9) Nut and anchor plate (39992-65A, 39998-65)



1190

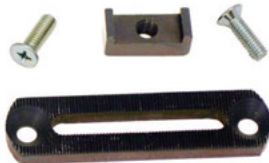

3747

Nylon Primary Chain Shoe Adjustor

Replaces OEM #39973-65 lining. Also No. 39976-65B tensioner shoe. Use on 1965-00 74", 80".

1190

Tensioner Anchor Plate

Replaces plate 39998-65, and nut 39992-65A on FX-FL 1965-on, heat treated detents for positive hold.

3747

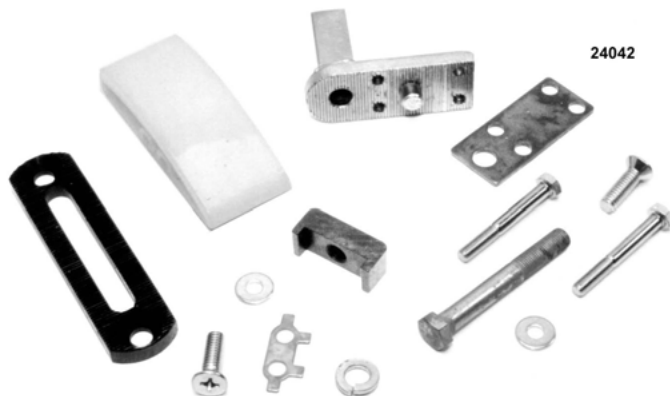

24042

BT Chain Tensioner Parts

PCP	Application 1965-84
24042	Complete kit
24034	Hardware kit
1190	Nylon pad (39976-65B)
13731	Lock (10 pack) (39996-65)
27113	Shoe mount bracket (39990-65)
17502	Plate (39993-65)
3747	Nut and anchor plate (39992-65A, 39998-65)

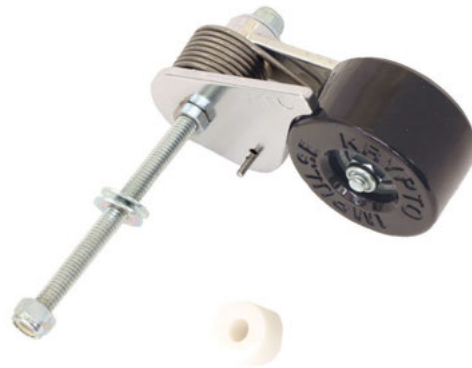

Rear Chain Tensioner

Use of tensioner reduces chain vibration and frequency of adjustments. Tensioner features a durable urethane roller which revolves on sealed bearings mounted on chrome anchor plates.

PCP Description

43112	FL, FLHS, FXE, FXWG 1973-85
43113	XL, XLH 1957-on

43400

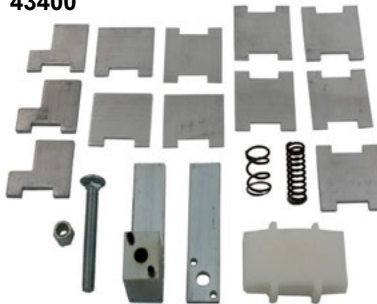

43402



Self Adjusting Chain Tensioner Kit

Fits Big Twins 4 & 5-speed 1965-on replacing factory type detent adjuster shoe. Kit includes all hardware and detailed instructions for the complete conversion.

43400	BT 1965-00
43402	XL 4 speed 1977-90
43401	Replacement shoe

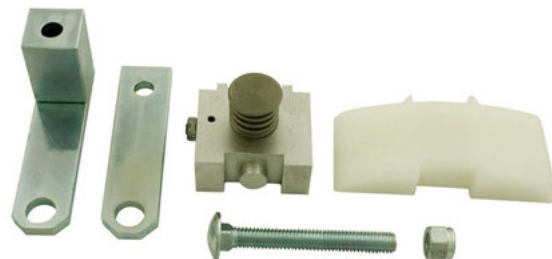

Sifton BT Hydraulic Primary Chain Tensioner

Features a hydraulic valve which controls the motion of the submerged piston which constantly keeps the chain in tension for 1965-on BT.

59964



Chain Related

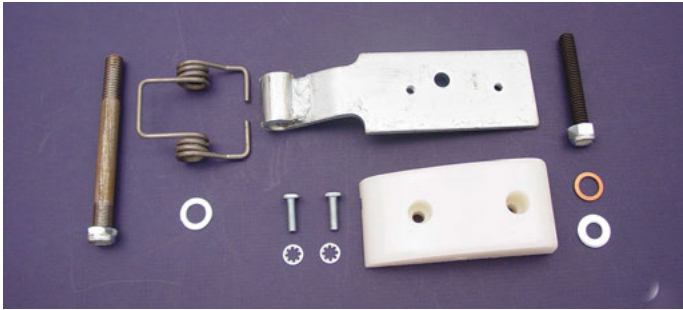

Sportster "Primary Adjuster Shoe Kit"

Fits 1979-85, OEM on 1980-85, use to update 1977-79.

60000 Kit as required 1977-85



Axle Plates

Made of polished stainless steel to protect axle area. (Pairs)

PCP Models

43001 FXR-FXRS 1982-on

5047* Rigid BT 1936-72

* Requires drilling and tapping at axle area (drill and tap not included), but includes screws.

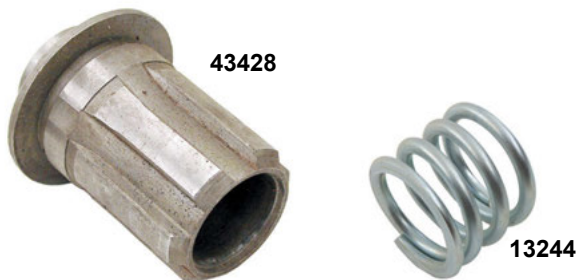

XL Compensator Sprocket Components 57-76

PCP Application

43428 1974-76 Shaft extension (40377-74)

13244 1957-76 Spring (40302-55A)

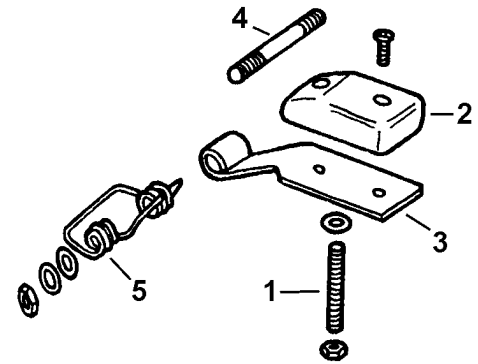

Sportster Primary Adjuster Shoe Components

#	PCP	Item
1	10902	Adjuster stud 1977-90 (each) (3250)
2	3276	Pad 1980-90 (39966-80)
3	60002	Carrier 1980-90 (39973-86)
4	10858	Stud 1977-85 (40018-77)
5	13197	Spring 1977-85 (40019-80A) (each)

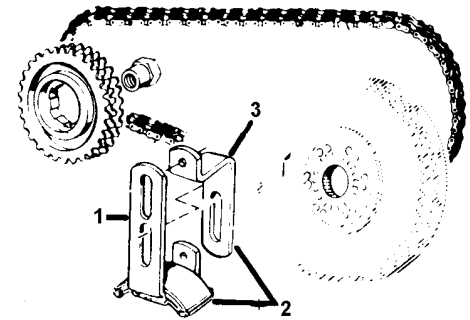

Sportster Chain Tensioner

Includes pad and clip replaces 39975-54A on 1957-69 XLCH models, or 39975-54B on 1971-79 XLH-XLCH which includes 39980-54 brace.

#	PCP	OEM
1	43420	39975-54A
2	43421	39975-54B (2 pc.)
3	43422	Offset Bracket 39980-54

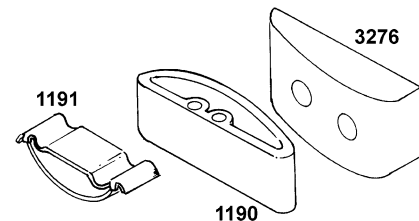

Nylon Primary Chain Shoe Adjustor

PCP	Description
1191	XLH-XLCH 1957-79, plastic piece only (39978-58A)
1190	FL-FLH-FXE 1965-00 (39976-65B)
3276	XLH-XLCH 1980-90 (39966-80)

Chain Guard



Chrome Iso Mount Swing Arm Chain Guard

Use on all FLH-FXE-FXR models 1958-on chain drive models. Includes rubber bushing & rear bracket.

PCP Application

451* FX-FL-FXE 1958-85, FXWG 1980-84 (60302-73T)

6343 FXR 1982-84 (60607-81A)

24084 Mount kit

***Note:** Also fits FL models 1958-84 for the FX look.



Chrome Rigid Chain Guards

PCP Model

6349 BT 1936-57 (60302-36) (no bolts or brackets)

5529 45 Solo 1936-52 (60303-36)

5530 45 Solo, raw (60303-36)

82020 As above black powder

82019 L/S universal layer type for custom mount

3176 As above, right side



FLH Style Full Chain Guard

Includes bushing

PCP Description

6346 Chrome FL 1963-82 (60302-63T)

85021 Black FL 1963-84 (60302-63)

23021 Bushing (11411) (5 pack)



Chrome Chain Guard

For 1958-82 FL and Super-Glide FX. Bracket included. Also fits FL models 1958-84 for the "lighter" FX look.

6350



FLH Style Chain Guard 1958-62

Fits FX and FL 1958-84 and replaces 60302-58.

85023 Chrome

85022 Black



1958 Style FLH Rear Chain Guard

Fits FL 1958-84. Replaces 60302-58.

85024 Black

85025 Chrome

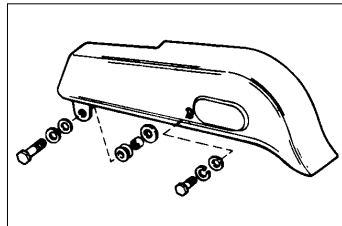

FLH Bushing Kit

Fits FLH chain guards 1963-84, includes one of each 11411, 5926B and 6107B for one guard.

PCP Description

24035 Bolt and bushing kit

23021 Bushing only (11411) (5 pack)

Chain Guard



Chrome Rear Belt Guards

6348 1980-86 FXB-FXSB (60380-79)



1796



Rear Chain Adjusters

Adjusters are heat treated and plated. Sold in pairs with plated lock nuts and assembled to insure properly fitting threads.

5165 BT 1936-72 Cad
1796 BT 1936-72 Chrome
1632 45's 1930-52 Chrome
5246 45's 1930-52 Cad

Rear Chain Adjusters

Chrome XL adjusters with lock nuts.

1337 All XL 1954-78
5128 Colony as above



1337



BT Rear Chain Guard Mount Kits

Kit includes bolt, nut, spring, cotter pin and washers.

PCP **Description**
9601 BT 1936-64, parkerized

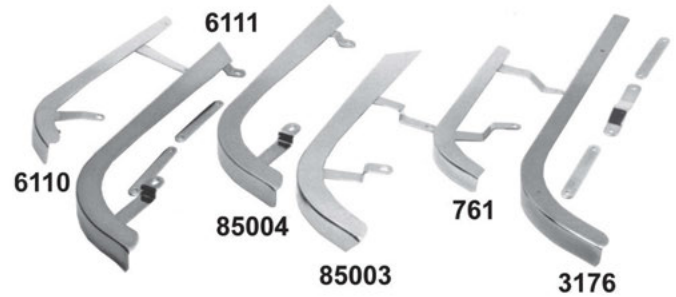

Chrome Chain Guards for Sportster

PCP **Model**
6110 1957-71 XLH (60308-67)
6111 1957-71 XLCH (60303-56)
85004 1972-78 XLCH (60308-72)
85003 1972-78 XLH (60344-72)
761 1979-81 XLCH-XLH (60375-79)
3176 Universal right side, 25"L



6345

Chrome Chain Guards for Sportster

PCP **Years**
85005 1982 only, without apron (60387-82)
6345 83-87 with splatter apron (not 87 Hugger) (60375-83)



82017

82069

82058

Rigid Replica Chain Guards

Come complete with stud for mounting to stock rigid fender.

PCP **Application**
82017 BT 1936-57 black
82018 As above, chrome
82068 BT 1941-57 black
82069 As above, chrome
82058 BT 1936-40 black (3 rivets)

Chain Adjusters



Custom Axle Adjusters (Pairs)

43100 FXR models 1984-91

43101 Heavy-duty axle adjuster blocks prevent swingarm body collapse due to overtightening. Fits 4-speeds 1973-on, FLT 1980-83, FXR 1982-on & XL 1979-on

OEM Style Axle Adjusters (Pairs, zinc)

3547 FXR 1982-on and FLT 1980-83 (41570-77, 41112-79, and 7725)



Calibrated Rear Wheel Adjusters

Adjusters have chrome pyramid blocks with sight indicator to view calibrated adjuster bolt. Bolt is a heavy duty 1/2" rod with micrometer markings. Complete with chrome bolt and stainless steel nut.

43108 FX-FLH 1973-85, XL 1979-on



1778



Pyramid Adjuster Blocks

Chrome, die cast for positive adjustment. Includes nuts. For BT 4 Spd. 1973-86 and XL 1979-96.

5585 With pull adjusters as pictured

5586 Chrome outer parts only (use your stock adjusters) (41532-89T)

Complete Rear Wheel Adjuster

Complete kit contains adjusters; chrome plated end plates, hex nuts, and custom chrome plated tapered lock nuts.

1778 Fits BT 1973-on

Chrome plated end covers and nuts replace the original equipment.

1802 Fits BT 1973-84, XL 1979-87.



Chrome Rear Wheel Adjusters

BT 4 speeds 1973-85, XL's 1979-96. Set of 2.

2504 41530-84T



Rigid Axle Adjuster Kit

For use with 3/4" axle on rigid hardtail frames with 7/8" slots.

16322