

Section 6A

Front End

BT to 1984, XL to 1985

Fork Stem Parts	20-27
Fork Assemblies	8-14
Fork Covers	6-7,22
Fork Tubes & Springs	15-17
Handlebar Controls / Wiring / Levers	37-42
Handlebar Mount Kits	28
Handlebars	30-33
Head Light Cowlings	6-7
Mirrors	29
Neck Cups	BT 18-19, XL 27
Risers	34-36
Throttle Grips	43-46
Tins	7,27
Triple Trees	6, 8-10, 12-13, 20
Windshields	2-5

Windshields

National Cycle Windshields are made of GE Lexan Polycarbonate



Touring Heavy Duty For Wide Glides

Full height wide screen with a very light tint, 21 1/2" wide

52125 Windshield for FXDG 1983, FXWG 1980-85

27168 Chrome mounting kit

52125 Windshield for FL DUO 1948-59

27169 Chrome mounting kit

52118 Windshield for FL Duo 1960-84

27169 Chrome mounting kit

52118 Windshield for FLHS 1977-83

Requires OEM windshield frame brackets

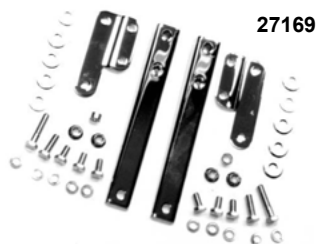

Chopped Heavy Duty For Wide Glides

Wide screen look with a low profile. Very light tint, 15-18" high and 21 1/2" wide

52126 Windshield for FXDG 1983, FXWG 1980-85

27168 Chrome mounting kit

52126 Windshield for all FL Duo 1948-59

27169 Chrome mounting kit

52127 Windshield for FL Duo Glide 1960-84

27169 Chrome mounting kit brackets*

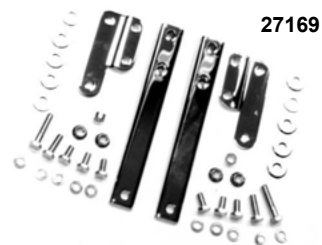

With billet trim #82059 for Chopped and Touring Shields

Beaded Heavy Duty for Wide Glide Forks
Classic look of the 50's models, colour lowers and windows available, 19"-22" high, 21½" wide



For FXWG Models 1980-85

Windshields to fit FXDG 1983, FXWG 1980-85

- 52120** Clear lower
- 52123** Black lower
- 27168** Chrome mounting bracket kit



27168

For FLH Models 1960-84 and FLHS Models 1977-93

- 52134** Clear lower
- 27169*** Chrome mounting bracket kit
- Note:** FLHS Requires OEM windshield b equivalent and FLHS window



27169



Replacement Windshields for all years of FLH

PCP	Height	Colour
52003	18"	Clear
52004	18"	Tint



"Chopped" Replacement Windshields for FLH

PCP	Height	Colour	Fits
52006	7"	Tint	1960-85

Windshields

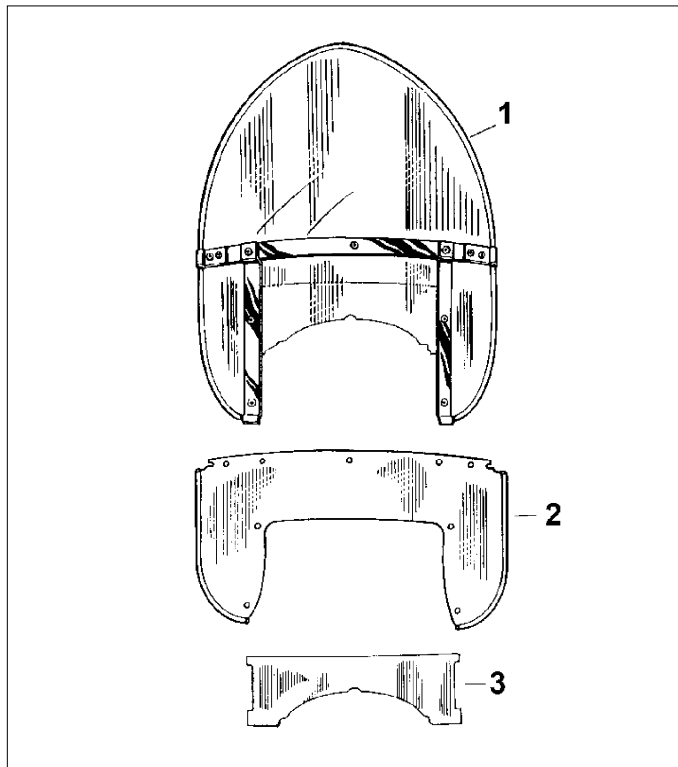

2416



4051



Chrome Wind Deflectors

2416 Fits FLH front ends 1960-84

4051 Fits 1983-85 FLHT

Windshield Molding Clamp

16249 FLH 1969-84 (pair) (58048-50)



Police Style Windshield-National Cycle

Windshield top has a beaded edge and available with a pointed or gently curved top. Fits all police style windshields. Replaces 58020-49.

#	PCP	Description
1	52009	Peaked top only (58020-49)
2	52015	Lower shield, clear
	52018	As above, black
3	52010	Slider, clear notched FLH style
	52012	As above, blue



Windshield Trim Mounting Kit

Chrome plated special phillips head screws fasten plastic to steel frame on all FL,FX,XL, & K windshields 1949-on.

9200 Chrome screws and acorn nuts

9201 Chrome screws and cad plated acorn nuts

Windshields

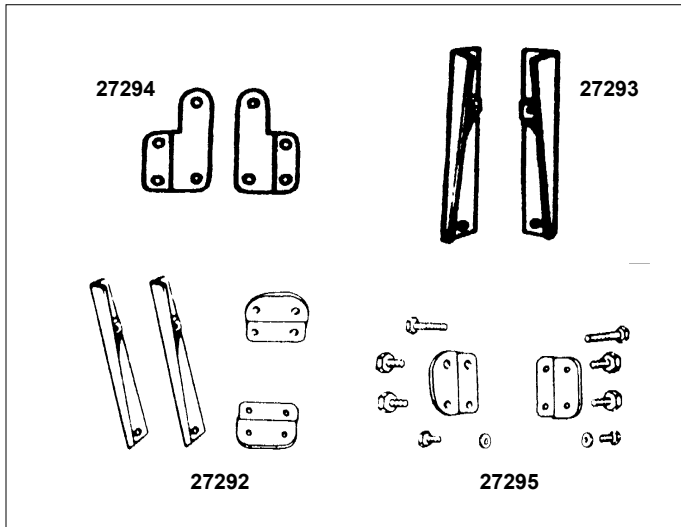

FLH Shield Hardware

Includes right and left extensions and right and left fork braces for mounting shields on all 1949-on Glide forks. If spot light brackets are installed, the right and left fork braces must be omitted.

PCP	Application
27292	Complete kit 1949-59 (4 pieces)
4581	As above 1960-84
27293	Right and left fork braces 1949-84 (58095-49, 58096-49) (pair)
27294	Extensions 1949-59 (58108-49) (pair)
27295	Extensions 1960-84 (58107-60) (pair)
27296	Mounting hardware 1949-84

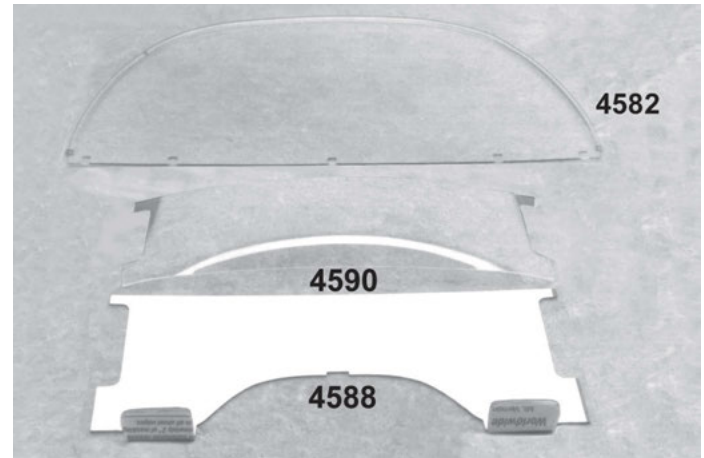

Beaded Top Shield Only

Available as short type, OEM 58020-49A for 1949-on FL, or taller type OEM 58164-69 for fairing.

PCP	OEM	Height
4582	58020-49A	Short-15"

Adjustable Lower Windshield 1960-on

PCP	OEM	Colour
4588	58027-60B	Blue
4589	58027-60R	Red

Lower Window 1949-59

Hydraglide

PCP	OEM	Colour
4590	58027-49	Clear



FLH Windshield Bracket Kit

Includes all parts pictured in chrome for #27085 equipped for 1949-83 FLH police windshield, complete kit bracket set.

27085 FLH 1949-83 with 57996-60A Police style windshield (57950-92T)



National Cycle Shield For FL Models 1949-59

52120	Clear lower
52123	Black lower
27169	Chrome mounting bracket kit



Light Housings



FL Headlight Housing 1960-84

Diecast headlight housing for 1960-84 FL front ends. Fits to both original equipment and our triple tree to dress up the bike.

- 56340** Chrome (as shown)
- 56341** Polished as above
- 4038** Chrome outer trim ring (OEM 67712-60A) includes rubber seal (OEM 67716-60A) 4 retaining clips (OEM 67779-60)
- 4960** Retaining Ring for Seal beam unit (OEM 67765-60)



Chrome 7" Headlight Cowl Kit

Kit includes chrome ABS headlight housing, 7" H-4 lamp assembly with rim, upper fork covers and chrome fork air baffle. Fork covers can be installed without disassembly of forks. Fits 1980-86 FLT, 1983-85 FLHT-FLHTC.

90416



FLH Head Lamp Cowl Kit 1960-84

Kit available in polished or chrome finish complete with rim and matching top handlebar clamp. As shown.

PCP Description

- 90403** Chrome kit with bulb
- 90404** Polished kit with bulb



Black 7" Headlight Cowl Kit

Black powdercoat 7" headlight cowl and handlebar riser with 55/60watt H-4 unit, stainless screws. Fits 1960-84 FL.

90406



Handlebar Clamp Cover

Replaces original type on 1960-84 FLH wide glide forks.

Chrome	Polished	Black	Year	Type
3810	45347	45506	60-79	Smooth
3806	45537		60-79	Damper hole
45094			80-84	Smooth (56590-79)

#3806 Uses #40701 damper kit



Headlamp Cowl Screw Kit

Fits 1960-84 FL and 1960-73 G models. 5 Pack.

16364

Fork Tins

Top Triple Tree Covers

Feature either a chrome or stainless steel finish. Note: 45302 does not have tube plug holes in side for adjustable fork application. 2253 and 4525 fit 1949-59 solid mount glide risers.

Chrome S.S. Description

4525	2253	(A) FLH Solid (4-3/4" C/C) (45740-49)
-	45301	(B) Adjustable, solid (45741-50) 50-59
4526	4390	(C) FXWG (3 1/2" C/C) Fits 1960-on type Iso mount trees (45741-60)

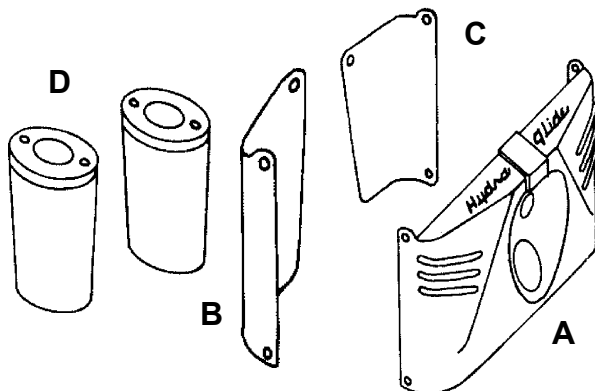
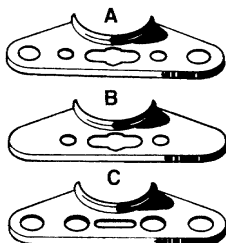

Headlight Trim, Stainless Steel and Chrome

Reproductions of the 1949-59 Big Twin triple tree and headlamp trims. Ideal for restoration work or bringing a classic look to newer models. Available in stainless steel or chrome plating.

Chrome S.S. Description

4527	2200	(A) (46273-49)
-	2201	(B) (46283-49)
4528	2202	(C) (46281-49)
1227	-	(D) stock length 6-5/8" (pair)(45964-49)
2456	-	(D) +2" (pair)
2031	-	(D) +4" (pair)



Triple Tree Cover Kit With Angled Ribs

3 Rib design features embossed Hydra Glide emblem on front cover. 4 Piece kit includes front panel, top tree cover, left and right panels. PCP #45858 is a replica of 1950-54 FL.

PCP Finish Application

45858	Black	FL 1949-54
45859	Chrome	FL 1955-59



Early Model Front Fork Tins for FL 1949-54

Complete with the front and rear tins.

Stainless Steel Straight Ribbed 4 Piece Kits

45704	1949
45705	1950-54 "Hydra Glide" on front panel

Stainless Steel Straight Ribbed Front Panel

45712	1949
45709	1950-54 "Hydra Glide" on front panel

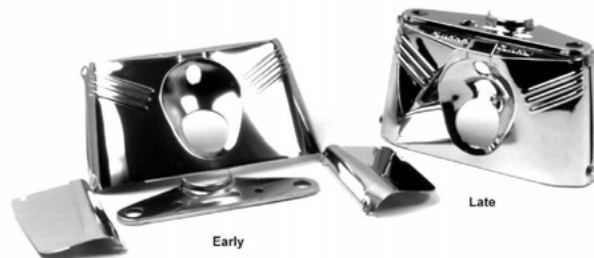

Early Model Front Hydraglide Fork Tins for FL 1949-84

Complete with the front and rear tins, and your choice of the early 4 3/4" c/c or late 3 1/2" c/c triple tree top cover. Side mounting holes are 6-5/8" c/c.

6606	Late stainless kit (4 pc)
45715	As above chrome
6607	Early stainless kit FLH 1949-59 (4 pc)
6608	Late chrome kit (4 pc)
6609	Early chrome kit (4 pc)
24085	S.S. Mount kit FLH 1949-59



Adjustable Fork Stem



Adjustable Fork Crowns (Black)

Complete kit available for 1977-84 FLH. Kits feature swivel type tube plugs, lower tree has 2 positions for changing rake, black painted. (Fork plug accepts O-ring), you must drill & thread bolts if cowlings are required. Use late style rubber bushing on 3.5 c/c. Trees adjust from 0 to 3 degrees.

- 5004** FLH 1977-84, FXWG 1980-86 (45695-77)
- 5003** FL 1949-E77 with a 3.5" mount (45709-66)
- 51410** Partial Kit
- 19604** Top tree only 1973-on (3.5" c/c riser) (56129-73A)
- 19605** Lower tree only with stem (45697-50A)
- 19795** Lower tree with stem and dampner
- 19655** Lower tree cross bar only, for slider covers
- 19656** Lower tree cross bar only, without tabs
- 19606** Top tee bolts with lock tabs (kit)
- 13734** Lock tabs (45752-50) (pair)

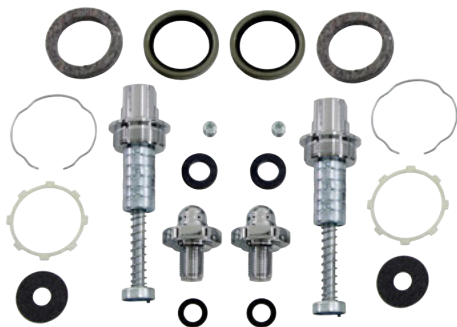

Glide Top Nut Kit

1948 Style design with top nut, 2 fork plugs with vent valves, deluxe gasket and seal kit. Fits FL 1949-76.

40704

Adjustable Top Plug (Each)

Swivel type top plug for adjustable FL forks late 1977-on FL and FXWG (45777-77). Use this type when installing rakeable trees on late 1977-on fork sets. Zinc finish.

885 1977-84 (each)

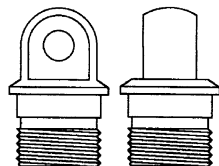

Adjustable Position Tabs

Replaces 45710-58 on all adjustable forks 1950-on. Tab has welded pin.

4411 Pair



FLH Adjustable Fork Assemblies

Includes black adjustable rake triple tree set, polished sliders with 1977-on type internals installed, stainless slider covers, axle, nut, fork bearings and cone nut. PCP# 98009 accepts #53035 caliper. PCP# 98008 accepts left side brake component kit # 90136. Both units accept riser bushing sets which replace riser stems (3-1/2" centre to centre).

PCP Application

- 98008** Left side drum 1949-58 (45512-60A)
- 98009** Disc 1972-84 (45509-72B)



FL Fork Plug Sets

Parts offered as pictured. Sold in pairs and are zinc plated. Fits FL-FLH models 1949-76.

- 51005** Standard Glide (45775-50)
- 51006** Adjustable Glide (45775-49)

Fork Baffle Kit

Fits FLH forks 1949-E77, Servi-car 1958-73, with all parts necessary to thread into slider tube plug, as pictured for 2 sides.

40700 Pair (45775-50)

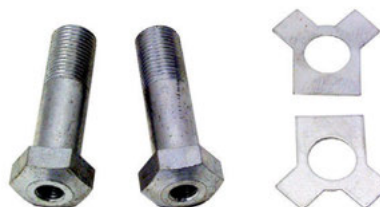

Adjustable Fork Upper Bracket Bolt & Lock Kit

Cad plated bolts replace OEM 45753-50 and lock plates replace OEM 45752-50. For use on 1949-84 FL models with adjustable forks.

72185

Glide Drum Brake Forks



98025

1960-68 Style
#98025 shown
with #90404 cowl
set sold separately



98025

Glide Fork Assemblies

Feature lower triple tree with or without lock tab and accept a left side drum brake assembly. Includes PCP# 1227 chrome slider covers and polished aluminum lower sliders with L1977-on type internals installed in 41mm stock length hard chrome fork tubes. Also includes axle nut, neck bearing, top crown nut and dust covers.

1949-59 Style (no lock tab)

Features black upper tree with solid holes 4-3/4" centre to centre spacing. Will accept glide post riser PCP #51331.

1960-71 Style

Features black top tree with 3" centre to centre spacing which will accept rubber bushing kit PCP# 1795. The PCP#3553 riser clamp fits two piece bars. The PCP #51333 riser kit fits one piece bars.

Both #3553 and #51333 riser kit allows the use of #3810 handle-bar clamp cover on aluminum cowl. Both forks accept #56340 aluminum cowl set or #6609 or #6606 4 piece chrome panel set (not included).



FLH Black Triple Trees

Designed to fit BT 41mm fork tubes 1949-59 with tin cowl set. No lock plate on lower fork clamp

51423

Fork Assemblies (Cowlings not included)

PCP	Year	Brake	Trees	Sliders
98005	1949-59	Left	Black	Polished
98025	1960-66	Left	Black	Polished
98080	1967-68	Left	Black	Polished
98081	1969-71	Right	Black	Polished

Leg Assemblies Only

PCP	Year	Brake	Sliders
98020	1949-68	Left	Polished
98021	1969-71	Right	Polished

Cowling Assemblies

90404	1960-84	Polished cowling assembly w/riser cap
90403	1960-84	As above, chrome

1949-59 Units
feature early
style solid mount
trees



FL Forks



FLH Fork Assemblies

Available as single disc model 1972-84 type which accepts large banana caliper for a 10" brake disc. Includes tapered aluminum sliders with slider covers, triple trees, stock length fork tubes and all 1977-on internals installed. Lower tree has a padlock tab and only accepts aluminum cowlings. Also includes axle with nut, neck bearings top and crown nut. Lower sliders and tube assembly with internals are sold in pairs and available separately from whole kit.

PCP	Item	Description
98011	Leg set	Polished (R+L) Stock
98013	Leg set	Chrome (R+L) Stock
98050	Kit	Chrome trees & slider covers, pol/sliders
98052	Kit	Chrome legs and triple trees
51456	Sliders	Polished right and left lower sliders only
53030	Caliper	Black 1972-84
53031	Caliper	Chrome 1972-84

All Fork & Leg Assemblies listed here have late 1977-up style damper internals.

Although these assemblies come with fork oil already installed, **we recommend draining and refilling to factory specifications.**



Chrome Triple Tree Set 1949-84

- Late style rubber handlebar bushing
 - For early style 1949-59 headlights
 - Lower tree is drilled and tapped for slider covers
- 51419

6A-10



Triple Trees

These triple trees are reproductions of the stock FLH type clamps, drilled and tapped for slider covers, 1949-59 for steel panels and 1960-84 for alloy cowlings. The top tree features the late style, 1973-on rubber handlebar bushings, **not included**, and the 1949-59 style are for solid mount handlebars on 4" c/c. (Stock Heritage tins **do not** fit these tree sets).

- 5767 Chrome set fits cowl 60-84 w/lock plate (45700-60A)
- 51424 Chrome set (no lock plate) fits cowl 1960-84
- 51423 Black set fits tins 1948-59
- 5000 Chrome lower tree 1949-84 (no lock plate) (45700-60)
- 5007 Chrome lower tree 1969-84 (45700-69A)
- 59099 Black lower tree 1960-84 (45700-69A)
- 59100 Black lower tree 1948-59 (45700-48A)
- 5001 Chrome top tree 1973-84 (56121-73A)
- 59101 Black top tree 1973-84 (56121-73)
- 59102 Black top tree w/solid riser mount 49-59 (56121-48)
- 1795 Riser bushing set 1973-84 (56157-85T)



Riser to Top Tree Dampner 1949-72

- | PCP | Description |
|-------|--|
| 3804 | FL Handlebar dampners (56158-49) (pr) |
| 4509 | Riser-dampner rubber bushing washer only FL-XL 1949-72 (56159-49) (pair) |
| 18618 | Handlebar bushing, +.007 O.S. (pair) |



Chrome Top Clamp BT 1949-on

Styled after the FXST fork clamps they feature late model handlebar rubber mount bushings.

- 51420 Chrome top tree only (no bushings) (45672-80)

PRESTON CYCLE PRODUCTS INC.

FLT Forks



Chrome Front Fork Air Baffle

Fits 1980-on FLT, FLHT, FLHR models.

45447 58520-79B

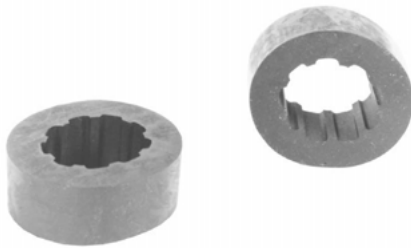

FLT Fork Stop Rubber 1979-on

Fits 1979-on FLT models and replaces 47530-79B.

73550



Black FLH Top Triple Tree 1960-84

1960-84 Style top tree, no lock plate and later style riser.

51507



FL Dual Disc Forks (FLT Type Sliders)

Assembly features FLT style 1986-99 polished, tapered, aluminum sliders, chrome slider covers, chrome FLH triple trees, and axle, nuts, bearings and dust covers. Use aluminum headlamp housings **PCP 56340**, 11" disc brake rotors, FLH wheel assembly **PCP #70796** and **6095** or fat kid fender **88202**. Fits FLH 1949-84.

Over all length is 29". Order calipers separately.

98017 FX-FL fork assembly w/chrome sliders

61012 Left caliper, black

46750 Chrome caliper set



Fork Installation Kits

Kits include 2 bearings, dust covers, top nut axle and hardware.

PCP **Application**

43125 Drum FLH 1949-66

43126 Single FLH 1973-84, dual FXWG 1980-83

FXWG Forks

FXWG Dual Disc Fork Assembly 1980-83 Style

Dual disc model, 1980-83, features polished lower legs, hard chrome fork tubes (as on OEM) and chrome plated fork trees. Fork tubes are pre-assembled but oil level must be checked with factory manual. Bearings, axle, dust shields, top and crown nuts included. Stock is 31" overall length. Use 2 10" discs (order separately). These fork assemblies can be fitted to BT 1949-on when 1977-83 style dual disc calipers are used.

PCP	Length	Type/Year
98000	Stk. Cpt. Fork	FXWG 1980-83 with polished lower legs
98002	Stk. (27 1/4")	FL trees with polished lower legs
98003	R+L Leg Assy.	FXWG 1980-83 fork leg assemblies (polished set)
46756	Black caliper set	1977-83 (44195-80)
46757	Chrome caliper set	1977-83 (44025-79)

NOTE: Supplied with fork oil in tubes but assembler should drain and refill to factory specifications.



5764



43300



43301

Chrome Plated FXWG Triple Tree Set

Chrome plated upper and lower pieces. These are the 1980-99 type with the stock built in rake. Replaces 45672-80 upper, 45665-80A lower stem and bracket.

5764	Chrome set 1980-87
59200	Chrome top
5766	Chrome lower

Speedo Drive Adapter Kit BT 1973-84

Kit includes 2:1 ratio right side speedo drive, chrome hub cover and chrome axle with nuts. Fits single disc FL spoke hubs and cast wheels 1981-85 style. FXWG kit includes adapter flange, 2:1 ratio speedo drive and axle to fit 1980-83 FXWG dual disc spoke hubs.

PCP	Application
43300	FLH single disc
43301	FXWG dual disc



43300 Installed

Fork Trees



Smoothie Billet Triple Tree Set BT 1949-99

Features hidden stem nut top tree for use with 41mm fork tubes. Kits include riser bushings and stem hardware.

PCP	Description
51422	Stock rake
40702	Top plugs 1949-76
40703	Top plugs 1977-99



Machined Triple Trees

Flat type, custom pair, fits 1948-84 FL models. Stock width & rake.

51411 Chrome set

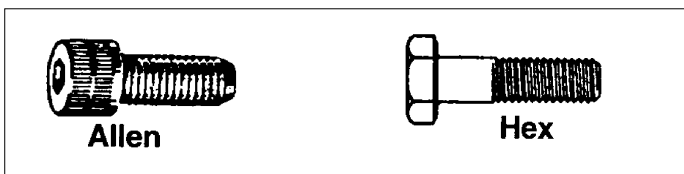

Lower Stem Pinch Bolts

Offered in chrome allen or zinc finish hex caps. Chrome allen set for FL, FXWG includes head light bracket screws, XL set includes screws for side of tree.

PCP	Type	Fits
24017	Hex	1973-86 FX-XL, zinc (4411)
24018	Hex	1949-on FL-FXWG, zinc (4729)
9803	Hex	As above in chrome (4729)
24019	Allen	1973-86 FX-XL, chrome
9782	Allen	1949-on FL-FXWG, chrome



Fat Kid Style Fork Assemblies for Sportster

Assemblies include chrome top tree, black lower tree with polished or chrome lower sliders, hard chrome fork tubes and axle kit.

98064 FLST style fork assembly for XL 1952-81

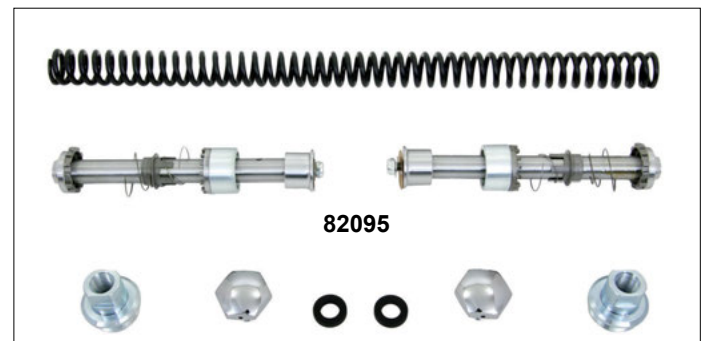

Fork Tube Assemblies

Assemblies include chrome fork tube plug and caps, seals, springs, and damper kit.

82095 1949-76 FLH

82096 1977-84 FLH



Chrome Taper-Top Socket Fork Caps

Unique tapered style uses hex wrench for installation, no more marred chrome from wrenches.

PCP	Application (Pairs)
40702	FLH Wide Glide 1949-76
40703	FLH-FXWG Wide Glide 1977-on

Fork Leg Assemblies



"Gator" Fork Boots

Black, flexible rubber boots measure 230mm long and fit FXST-FXWG 41mm forks.

PCP Size
23079 41mm



Fork Tube and Slider Assemblies

Fork tube and sliders come completely assembled for left and right sides. Includes hard chrome fork tubes, chrome or polished lower sliders, springs and all internal components installed.

FXWG Assemblies

69729 41 Dual -2" (30.5") w/polished sliders
98003 41 Dual 1980-83 (46002-80) 32.5" stock

FL Disc Brake Assemblies

98011 41 Single 1973-84 w/polished sliders
98013 41 Single 1973-84 w/chrome sliders

FL Drum Brake Assemblies-Polished

98020 41 Left side Drum brake 1949-68



Fork Slider Drain Screws

Plug and Washer K, XL, FX 1952-72 (46201-52, 6218-W)

9907 (A) Chrome

9908 (A) Cad

Stock Plug FL 1949-E77 (45830-48)

9909 (B) Chrome

Button Head Allen Screws & Copper Washers

9910 (C) Chrome XL, FXR 1973-on and FX 1973-86 (does not fit XL sport models) (45790-80, 45996-73)

24161 Allen head as above

9758 (D) Chrome FXWG, FLT, & FL L1977-84 (45858-77)



Chrome Complete Fork Tube Assemblies

Each assembly includes: fork tubes, caps, plugs, springs, o-rings and dampener valve. Stock length assembly sold each.

69724 FL 1949-76 (20.5" tube)

69725 FL 1977-84 (20.5" tube)

69726 FXWG 1980-83 (24-1/4" tube)

Fork Springs

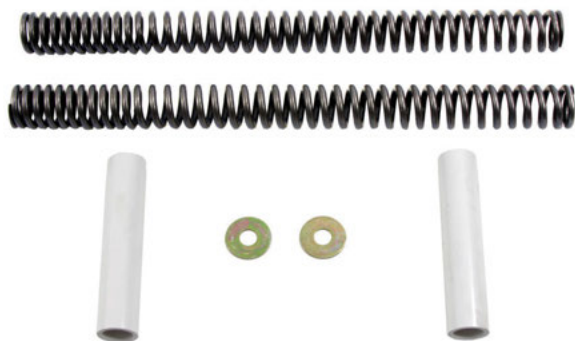

Fork Springs by Progressive Suspension Inc.

These springs eliminate front end sag, reduce nose dive under braking, improve stability and increase rider comfort.

82000 Fit all 35mm Showa forks from 1975-87

82002 Fit all Wide Glide® 41mm forks on FL 1949-92, FXWG 1980-86, FLT, FLHT, FLHS 1980-95



Cruise Control Front Fork Lowering Kit

Kit lowers front end by 1" or 2" decreasing initial ground clearance. For maintaining proper balance geometry it is recommended that the rear end be lowered by an equal amount.

PCP Size Application

82027 35mm FXR 1982-87, FXRS 1984-87, XL 1984-87



Fork Tube Spring Set

Exact replacement for the OEM's. Made from high tensile strength wire for long service life. All fork springs sold in pairs. For more complete fork spring applications, check your factory parts book.

Fork Spring Application Chart

PCP	OEM	Model	Free Length
82073	46057-52	1952-70 XLH-XLCH	
6710	46057-71	1971-72 FX, XLH	19-5/8"
6711	45984-73	1973-77 FX 1973-74 XL	19.25"
6712	45408-75	1976-83, FX, FXE, XLH, XLCH	19-3/8"
6713	45987-77	1977-83 FX, 1979 XLS 35mm	23-1/4"
6715	45907-80	1980-83 XL, 1983 XLS, XLX	23-1/4"
82076	46052-80	1982-83 FXR, 1980-82 XLS	
6719	46051-49A	1949-77 FL-FLH	20-1/8"
6720	45837-77	1977-84 FLH, 1980-83 FLT	17-3/4"
6721	46048-80	1980-83 FXWG	21-1/2"



Lowboy Fork Lowering Kits

Kits have progressively wound springs that resist bottoming out. Installation requires minor disassembly to lower the front forks 1 1/4" or 2" depending on the spacer used. Each kit includes springs, spacers and hardware. Stock ground clearance is maintained with forks fully compressed. May be converted back to stock by reinstalling the OEM springs.

82124 (41mm) FXWG 1980-86

82129 (35mm) FXR-FX-XL 1975-87, Showa & Kayaba

Fork Springs

Progressively wound springs are made using the finest drawn spring wire. Eliminates front end sag, reduces nose dive under braking and improves stability.

PCP Size Application

82083 35mm 1975-87 Showa

Fork Tubes

H.D. 74" & 80" FL & FLH Late 77 & Later (Showa). To identify Showa tubes internally the tube has a groove around the bottom. Externally the lower fork sliders flare out at the bottom and the top bolt has metric threads.

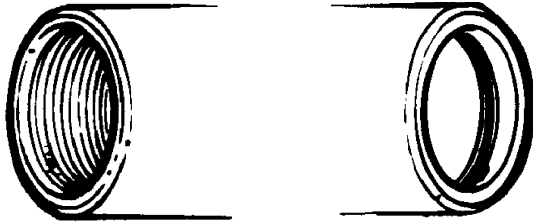

FL Models 1949-Early 1977

	Hard	
Chrome	Chrome	Length (45950-48)
6365	98519	Stock length 20-7/16"
6366	98520	2" over stock
6367	98521	4" over stock
6368	98522	6" over stock
	98523	8" over stock

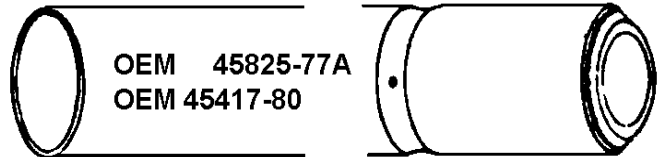

Preston's FL, FLH Late 1977-84;FLT/HT1980-83 Hard Chrome Plated

PCP	Length
n/a	Stock length 20-13/16" (45825-77A)
98352	8" over stock

FXWG, FXDG Models 1980-83

PCP	Length
n/a	Stock 24-3/4" (45417-80)
98352	4" over stock



FL, FLH Models from Late 1977-84; FLT, FLHT Models 1980-83

	Hard	
Chrome	Chrome	Length (45825-77A)
6386	98527	Stock Length 20-13/16"
6387	98528	2" over stock
6388	98529	4" over stock
	98530	6" over stock
6390	98531	8" over stock
	98532	10" over stock
98359		12" over stock
98360		14" over stock



FXWG, FXDG Models 1980-83

PCP	Length
6388	Stock 24-3/4" (45417-80)
6390	4" over stock

Fork Tubes

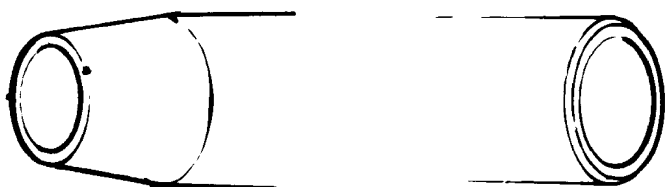

XL Models 1973 and 1974; and FX, FXE Models 1973-77 (Kayaba Fork)

PCP	Length
6373	Stock Length 23-1/2" (45977-73)
6567	2" over stock
6374	4" over stock
6375	6" over stock



XL Models 1954-72 and FX Models 1971-72

Chrome	Hard Chrome	Length
6370	98518	Stock 22-3/4"
6566	-	2" over stock
6371	-	4" over stock

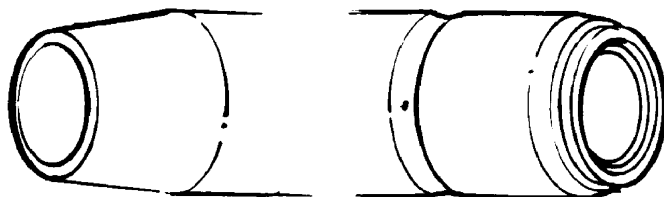

XLH, XLCH; XLCR Models 1975-83; XLX, XLS Models 1983; and FX, FXE, FXEF Models 1976-83 (Showa Fork)

Chrome	Hard Chrome	Length (45407-75)
6376	98505	Stock Length 23-1/4"
6377	98506	2" over stock (45644-77)
6378	98507	4" over stock
6379	98508	6" over stock

XLS Models 1979-82 and FXS, FXB, FXSB, FXR, FXRS Models 1977-83 (Showa Fork)

PCP	Length
6377	Stock length 25-1/4" (45644-77)
6378	2" over stock
6379	4" over stock



XL Models 1984-Early 1986

Chrome	Hard Chrome	Length (45407-83)
6381	98510	Stock Length 23-1/2"
6382	98511	2" over stock (45392-83)
6383	98512	4" over stock
6384		6" over stock
6385		8" over stock

•Note: 1978 Superglides, FX's and FXE's came factory equipped with two types of front ends - either "Showa" or "Kayaba". The fork tubes for these two front ends will not interchange! The "Showa" front end has a removable axle cap on each lower leg, while the "Kayaba" has only one removable axle cap on one lower leg.

FXRT and FXRD Models 1983-86

PCP	Length
6382	Stock Length 25-1/4" (45392-83)
6383	2" over stock
6384	4" over stock
6385	6" over stock

Neck Cups



Chrome Internal Fork Stop Kit

Includes pieces for complete installation on Big Twins, and custom frames which accept press-in neck cups. Kit allows choice of 35 or 45 degree turning rad.

40711 1949-87 BT



40707



40712



40708



40708 Installed

Raked Fork Neck Cup Set

Replaces removable cups to provide a 3 degree rake. Set includes cups, bearings, and dust covers.

40707 1949-84 FLH, 1971-84 FX, 1984-87 FXST stainless

40708 1949-84 FLH, 1971-84 FX, 1984-87 FXST chrome

40712 1952-77 XL chrome

27214



15510



15511



BT Fork Stem Bearing and Race 1949-59

PCP Application

15510 Bearing .998" I.D. (each) (48300-49)

15511 Race 1.968" O.D. (each) (48315-48)

BT Neck Cup Assembly 1949-on

Complete kit includes chrome neck cups with races and a chrome top nut.

PCP	OEM	Description
27214	Kit	Complete kit 1949-85
4799	48311-60	Cups with bearings 1960-85
548	48515-48	Chrome cup set
2455	48315-60	Races 1960-on (each)
15515	48300-60	Bearings 1960-on (each)
5755	48365-48A	Chrome dust cover 1949-88 (set)
12533	48330-48A	Lower cone nut 1949-59
12589	48332-48B	Zinc cone nut 1960-99
12590	48333-80	Cone nut FLT 1980-90
12625	45718-60	Chrome top nut with lock 1960-on
5398	45718-60	Zinc top nut with lock plate 1960-77
13733	45717-63	Lock tab 1960-85(5 pack)



Chrome Upper & Lower Dust Cover Set

Use on all FX-FL models 1949-88. XL models 1977-88, when a 1" stem is used. Use on Glide forks if threaded nut is not used.

5755 (48365-48A, 48361-80)

Neck Cups



Big Twin Neck Cups (Zinc)

27213 48311-60 Cup set with zinc finish



Chrome Frame Cups and Bearings 1960-85

74-80 Neck Cup includes 2 chrome cups (48311-60); 2 races; 2 (48300-60) bearings. Use on FL, FX 1949-85, FXWG 1980-86 and XL 1981-85.

4799 Complete kit

548 Chrome cups with races only

Ball Bearing Races

Fit BT 74 and 80 Springer and early XL (1952-77). Each.

PCP	OEM	Description
19050	48345-36	Upper and lower 74"-80" 1936-48
3799	48347-52	Lower XL 1952-77
19049	48346-39	Upper XL 1952-77



Zinc Plated Dust Shields

PCP	OEM	Description
11668	45597-78	Upper XL 1979-81
5760	48361-80	Upper BT 1948-on, XL 1982-on
1159	48365-48A	Lower FX-FL 1948-on, XL 1982-on
73553		Set FX-FL 1960-84
11669	48370-78	Lower XL 1979-81
11711	48370-52	Upper XL 1952-78
5755	48361-80	Chrome set, upper and lower FL, 48365-48A FXWG, FLT 1" type 1949-88

Timken Sealed Neck Bearings

Bearings feature built-in rubber seal at contact to race. Available as a complete set with chrome cups or as update to models where races are built-in frame.

27184 Chrome cup and sealed bearing kit 1949-88, BT includes 2 chrome dust covers

15517 2 Sealed bearings and 2 chrome dust covers fits FLT 1980-on, XL 1982-on

15518 Sealed bearing 1949-on (each)

15515



2455

Fork Stem Bearing and Races 1960-on

Replaces OEM 48300-60. Use on all 1960-on FL, 1971-on FX, and 1982-on all XL's.

15515 Bearing

2455 Races (48315-60) (each)



19170

Ball Bearing Neck Cups

Use on all XL, 45", 74" and 80" Twins. Use 5/16" type balls.

PCP	Application
5757	74"-80", 1936-48 (cad cups, pr) (48311-36)
5758	XL 1952-77 (zinc cups, pr) (48310-30)
15700	Head race 5/16" ball bearings 1954-78 XL (8860) (50 pk)
19170	Chrome kit for BT 1936-47 (cups-races-balls)
19171	Chrome kit for Sportster 1952-77 (as above)

Fork Stems



Cast Lower Tree Application Chart

Black	Chrome	OEM	Application
59278	708	45608-77A	1973-83 All FX models
706	51413	45703-73	1973-78 XL
51414	-	47693-84	1984-87 XL 35mm without fork cover holes



Chrome Top Fork Tube Nuts

- 543** FL Glides 1949-77-1/2 (Ea)
- 1794** FL Glides 1977-1/2-on (Ea)
- 1785** Sportster & Superglide (Vented) to 1972 (each)
- 1786** Sportster & Superglide 1973-85 (Ea)
- 1176** FXWG 1980-on (45419-80) (pair)
- 5485** Fork tube bolt replaces the original equipment of MID 1985-on XL, FX. This bolt is similar to the 1973 XL, FX except for coarser thread of MID 1985-on XL-FX.
- 9911** Wide Glide 1960-77, flat top
- 8872** As above, ZINC, flat top (45754-60)
- 9912** FL, FXWG 1978-on (45419-80)
- 9964** Fork tube bolt washers for PCP# 9912 (pr) (5710)



Weld On Fork Stem Locks & Stops

Lower fork stem lock part allows repair or adaption of tee, on models 1973-on Must be welded on.

- 3812** 1973-84 FXE
- 3809** 1948-84 FLH-FXWG
- 27011** 1981-83 XLH



Chrome Wide Glide Fork Tube Plugs

- 51014** BT 49-E77 zinc (45776-49) Pr
- 546** FL Glide 49-E77 (45776-49) Pr
- 547** FL Glide L 77-on (45838-77) Pr

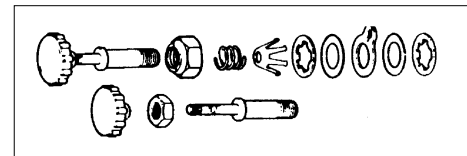

FL Steering Damper Assembly

Kit includes pieces shown including alloy adjusting knob.

- 40701** Complete kit 60-84 (46700-60)
- 44050** Knob only (46746-52)



E-Z Fill Fork Tube Top Plugs

Chrome plugs feature small oil cap built in to fork tube top plug which will allow fork oil change/fill without removing top fork cap. Pairs.

- 44104** FL forks 1949-76 Classic style

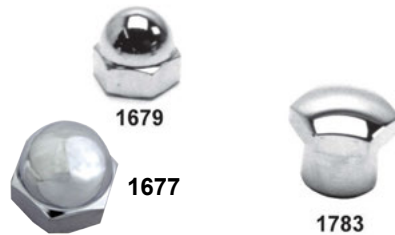

Chrome Fork Stem Acorn Nuts

- 1677** Springer 1" x 8 T.P.I. "Custom"
- 1679** FL Glide top nut 1948-on
- 1782** Sportster top nut 1952-77
- 1783** Top nut FX 1971-on, XL 78-on



FX Top Triple Trees

Fits FX models 1973-1986, FXR models 1982-86 and XL models 1973-86.

- PCP 33.4 mm**
- 59275** 1954-72 cast (45739-62B)
- PCP 35mm**
- 59276** 1973-86 cast (45738-73)
- 59277** 1973-86 polished (45738-73)
- 3260** 1973-86 chrome (45736-78B)

Colony Chrome Stock Style Fork Tube Bolt

Stock style replacement 45993-86 bolt and o-ring used on all 1985-87 XL and FX.

- 72371**



Fork Stem Parts



Chrome Fork Stem and Tube Nut Covers

Fit over stock stem nut and held in place by socket set screws. PCP# 2221 screws in stem, #44202 includes 2 fork tube cap covers and 1 stem nut cover. PCP# 44200, 44201 and 2221 are sold each.

PCP Fits

44200 35mm forks FX-FXR 1971-87, XL 79-87
2221 FXWG 1980-99 screws in stem (45670-80)
72058 Colony as above

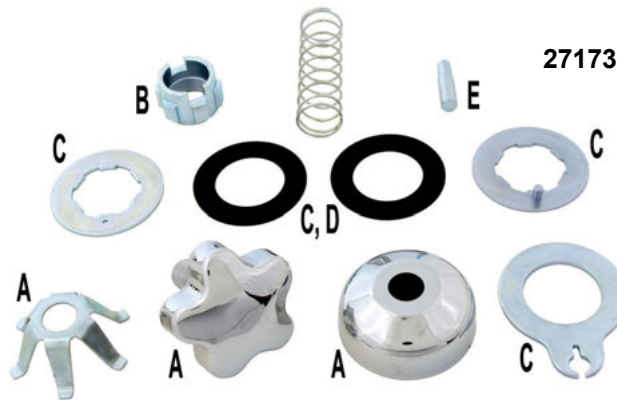

FLH Glide Steering Damper Hardware

Fits FL 1949-59 with drilled and tapped fork stem.

#	PCP	OEM	Description
	27173		Kit (A,B,C,E)
A	3105	47640-48	Chrome adjusting knob kit w/o spring,
		46751-48	with spider washer.
		46710-48	
		46715-48	
B	12576	45718-48	Crenelated stem nut 1949-77 (zinc)
C	3395	46718-48	Friction disc set (5 pcs)
D	11710	46727-48	Friction washers only (5 pack)
E	10168	46731-48	Frame anchor pin (ea)



Fork Steering Damper Knob Kit

Adjustable kit includes black knob and cover with zinc spring and spider washer. Fits 1949-59 FL.

27413



Glide For Stem Nut

Crenelated type top nut for use with Dampner units on 1949-59 Glide forks. Replaces 45718-48, zinc.

12576 Fork stem nut

Cone Seat Nut

Replaces OEM 48330-48A. Harley cone seat nut with dust guard. 1" x 24 thread. EL, FL, FLH 1948-on. 45" Servi-Car 1949-on Glide Fork.

12588 Hex type, zinc

12641 Replica type, zinc

Late Cone Cover Nut

Cad plated stock type cone cover nut for use on all Big Twins with steering damper.

12589 1960-99 BT (48332-48B)

Fork Dust Guard

This dust guard is used on Harley lower fork bearing 1948-79. Replaces OEM 48365-48A.

1159

Cone Nut

Features built-in dust cover. Replaces 48330-48 for 1960-84 BT, FL-FX.

12642



Fork Tube Bolt and Washers

Flat top bolt and chrome washers sold separately.

9911 Bolt for Wide Glide 1960-77, chrome

8872 Bolt for Wide Glide 1960-77, zinc

9912 Bolt and washer for FL, FXWG 1978-on, chrome (5710, 45419-80)

9964 Washer only for FL, FXWG 1978-on, chrome (5710) (pair)

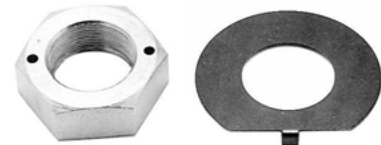

FL-Stem Nut & Lockwasher Kit

Precision machined stock stem nut and stamped steel lockwasher fits Harley Wide Glide 1949-77 without steering damper.

PCP Fits

5398 Kit Cpt.

13733 Retainer only 1960-85 (45717-63) (5 pk)

12577 Nut only (chromed)

Fork Covers



Chrome Slider Covers

45965-49 for FL's 1949-84 and FLT 1980-88 forks. Pairs.

PCP	Year	Size
1227	1949-84	Stock, chrome (6½") (45964-49)
69520	1949-84	Stock, stainless
2456	1949-84	2" Chrome (8½")
2031	1949-84	4" Chrome (10½")



Rubber Fork Boots

These rubber fork boots have an exceptional resistance to flexing, tearing, weathering or cracking, and this design improves the sealing and wiping action. Sold in pairs.

PCP	Fits
5010	FX & XL models 1971-72 (46001-71)
639	FL models 1949-E77
5011	FXWG models (except FatBoy & Heritage) from 1980-on (45420-80)
640	35mm Kayaba forks from 1973-76 (45893-73T)
641	35mm Showa forks from 1975-87 (45404-75T)



Upper Fork Slider Covers

Chrome covers for upper fork legs. Fits 1949-84 FL, 1980-on FLT, FLHT, FLHR.

45710 Pair (45963-97)

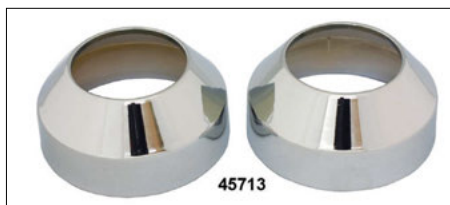

Chrome Wiper Boot Covers

These covers are die-cast for a snug-fit over the stock rubber fork-wiper boot. Fork must be disassembled for installation. Sold in pairs.

2217	Kayaba FX 1973-75 XLH 73-74
2218	FX 1976-87, XL 1975-87, Showa (45350-84T)
2457	FL Wide Glide 1949-E77
45713	FXWG 1980-83



Forged Aluminum Fork Brace 35MM

This top quality brace adds rigidity to fork tubes, by clamping to the fork seal area of lower sliders. Designed to fit FX, FXR, & XL models with Showa forks. Precise machining with a high lustre.

27081 Chrome



Black Fork Slider Cover Set

FLH 1949-84 5-5/8" stock length fork slider covers.

45732



Tweek Bar

Fork brace is made of polished alloy, 2 piece for easy installation.

PCP	Application
59284	41mm 1949-84 FLH, 1980-on FXWG

Billet Slider Covers

Fits 1949-84 FL, FLT.

PCP	Finish	Design
45578	Chrome	Grooved
45579	Chrome	Bellows
45734	Black	Tapered



FLH Fork Parts



Fork Drain Screws and Washers

PCP	Description
24538	Showa 1976-on (45790-80) (10 pk) (zinc)
24539	FLH 1977-on, FXWG 1980-on (45858-77) (pair)

Drain Screw Fiber Washers (10 pack)

PCP	Description
25205	Showa 1976-on (45986-75)

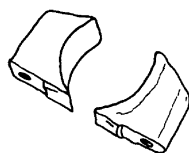

Weld on Tabs

Cast alloy to restore FLH Glide legs to accept fenders, must be welded on to either stock or turned down legs. Sold as 1 pair for 1 fork leg.

16213 Stock



Slider Tube Snap Ring

Replaces OEM #46172-48. Used on all 1949-77 FL's.

11100 Pack of 10



Damper Tube Rings 1977-96

Sold in 4 packs.

PCP	Description
13801	All FLT (45859-77A)

13801

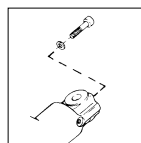

Damper Tube Screw

Replaces 45405-75A on 1975-on Showa forks for FX, FL, 1980-up FXWG

24537 Pair



Lower Damper Tube Springs (Pair)

PCP	OEM	Description
13219	46062-72	FX-XL 1971-72
13215	43855-77	FL 1977-85, FLT 1980-97
13220	45382-83	XL, FX 1983-on, FXR 1983-87



40706



Front Fork Damper For Early Glides 1949-E77

PCP	Description
40706	Complete damper set (for 2 fork tubes)
1367	Damper assembly set, shown (for 1 fork tube)
40000	Lower leg plunger tube only FL (46100-48) (ea)
16503	Lower damper bushing (46121-48) (pair)
13228	Damper valve spring (10 pack)
6719	Fork spring (46051-49A) (pair)

Damper Tube Washers (10 pack)

PCP	OEM	Description
79405	45992-73	XL Kayaba 73-74, FX 73-76 (fiber)
79388	45406-75	XL Showa 75-on, FX 76-on (copper)



Lower Damper Tube Stop (Pair)

PCP	OEM	Description
16503	46121-48	FLH 1949-76
16504	45918-73	XL-FX Kayaba 1973-77
16515	45402-75	FX-XL Showa 1976-83
16514	45834-77	FL-FXWG 1977-83, FLT 1980-97
16508	45403-84	XLH-FXR 1984-on

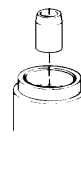

Fork Slider Bottom Cap Stud & Nut Kit

Chrome plated locknuts and replacement studs fit right lower leg.

3788	FLH Wide Glide 1949-77
4380	Showa & Kayaba 1973-on

Glide Axle Leg Caps

Cast Alloy for Glide lower legs, FLH type.

PCP	Years
5028	1949-77 (45836-48)
44083	As above, chrome
5029	1977-on plain (45832-77)
44039	As above, chrome

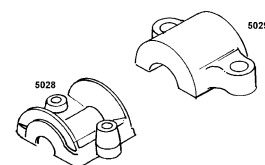

Fork Parts



Fork Damper Tube Kit

Kit for 2 sides includes: damper tubes with rings, screws and washers, lower stops, slider seal washers and retaining clips.

PCP	MM	Application
40010	41	Wide Glide FLH 1949-77
40011	41	Showa FLH 1977-84
40012	41	Showa FXWG 1980-83
40046	41	Showa FLT 1983-96
40015	33.4	Steel leg FX-XL 1971-72
40017	35	Showa FX-XL 1976-83
40018	35	Showa XLH 1984-on

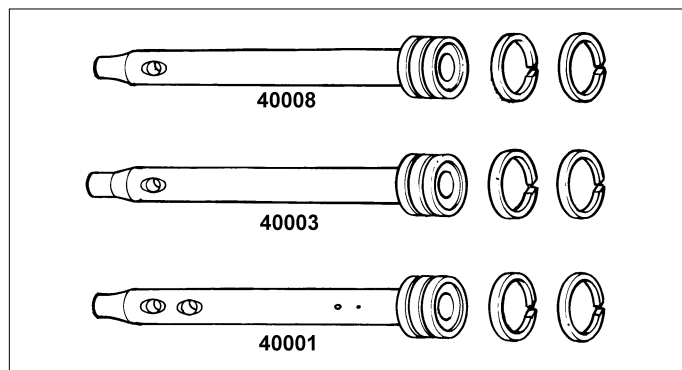

Fork Damper Tubes

Tubes are sold each (rings included if required) but does not include bolts/washers.

PCP	OEM	Description
40000	46100-48	FLH 1949-76
40001	45418-80	FXWG 1980-83
40003	45831-77	FLH 1977-84
40004	45913-84	XL 1984-87
40007	45980-73	XL-FX, Kayaba 1973-76
40008	45409-75	XL-FX, Showa 1975-83
13801	45859-77	Nylon ring 41mm 1977-on (4 pack)
13804	45412-75	Nylon ring 39mm 1975-86 (4pk)

Fork Bushings

Top quality replacement bushings.

PCP	OEM	Description
18579	45823-49	Lower bushing (each)
18580	45824-49	Upper bushing 1949-77 (each)
18581	45824-49	FLH 1949-77 (4 Pcs)
	45823-49	1 of each for 1 leg
18578	45818-52	XL-FX 1954-72 (each)



Fork Gasket & Seal Kits

PCP	Fits
79800	FL, FLH 1949-E77 (45849-49) (kit) (James)
5762	FL, FXWG 1977-84 (45849-77) (6 pieces-Preston))



Upper Fork Seal Kit 1949-77

Use to update 1949-77 FL, FLH to later style fork seal. Kit includes seals and spacer washer. New style seal replaces original type narrow seal, felt and top washer.

14109



FI, FLH Fork Seal Kit 1949-76

Complete seal kit for 1949-76 FL, FLH models includes both upper and lower seal and gaskets. Replaces 45849-49.

14110

Fork Parts

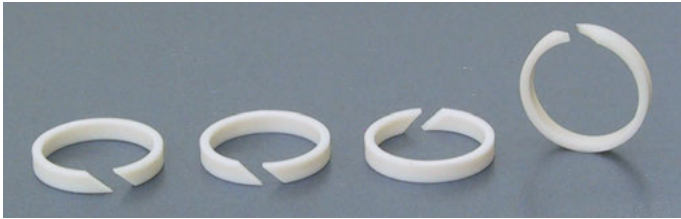

35mm Nylon Rings for Fork Tubes

Fits XL models 1975-86. Replaces 45412-75.
13804 4 Pack

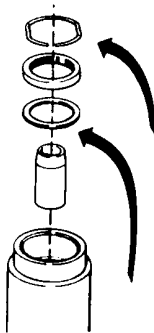

Fork Seal Retaining Rings (10 PK)

PCP Description

- 5012** 1949-76 FL-FLH (45856-48)
11093 1977-on FL-FXWG (45842-77)
11097 1980-on FXS-FXSB (45908-80)

Slider Washer

1949-up FL Wide Glide type fork assembly.

PCP Fits

- 5015** 1977-on FL, 1980-83 FXWG (45844-77) (10)
5016 1949-76 FL, FLH (45854-48) (10 pk)
11548 1973-76 FX-XL Kayoba (45928-73) (pr)

Narrow Glide Axle Cap

Chrome cap for left 1975-83 XL, FX and replaces 45410-75.
44056



Glide Fork Plug Kit

Kit includes fork tube plugs and matching top filler cap plugs. Kit available for 1949-E77 FL-FLH and 1977-on FLH-FXWG. Big Twin Glide models are Showa type.

PCP Application

- 51015** 1949-E77 early FL
51016 1977-on Showa FL-FXWG



Allen



Hex

Lower Stem Pinch Bolts

Offered in chrome allen or zinc finish hex caps. Chrome allen set for FXWG-FXST includes head light bracket screws, XL set includes screws for side of tree.

PCP	OEM	Type	Fits
24017	4411	Hex	1973-86 FX-XL, zinc
24018	4729	Hex	1949-on FL and FXWG, zinc
9803	4729	Hex	As above in chrome
24019		Allen	1973-86 FX-XL, chrome
9782		Allen	1949-on FL and FXWG chrome

BT and XL Tree Cover Screws

Button head screw kit for fork top tree & lower bracket chrome cover 1952-on, FX 1971-on.

8757 8 Piece kit



James Damper Tube Gaskets

Fits FL 49-77. Replaces 46111-48.
79172



40702

Chrome Taper-Top Socket Fork Caps

Unique tapered style uses hex wrench for installation, no more marred chrome from wrenches. Pairs.

PCP Application

- 40702** FLH Wide Glide 1949-76
40703 FLH-FXWG Wide Glide 1977-on

Fork Seal Kits



Top Quality Fork Slider Seals in Pairs

PCP For Sportster®, FX and FXR Models

- 1381** Sportster®, FX 1973-74 with Kayaba forks (45927-73)
1380 Sportster®, FX, and FXR 1975-82 with Showa forks (45400-75)
5751 Sportster®, FX, and FXR models 1983-86 with 35mm Showa forks (45387-83)

PCP For FL, FLT/FLHT, FXWG and all Softail® Models

- 3813** FL models 1949-E77 (45852-48)
3818 FL models L1977-84, FXWG and FLT/FLHT models 1980-83 (45843-77)



Genuine James Fork Oil Seal and Gasket Kits.

PCP Description

- 79800** Fits FL, FLH 1949-E77 (45849-49)
79804 Fits FL/H, FXWG L1977-84 (45849-77)
79801 Fits XLH, XLCH, FX 1971-72 (45849-71)
79802 Fits XLH, XLCH w/Kayaba fork legs 1973-77 & FX w/Kayaba legs (45849-73)
79803 Fits XL 1975-83, FX w/Showa (45849-75)

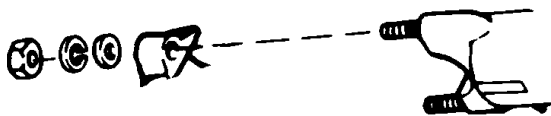

Fork Slider Bottom Cap Stud, Nut & Washer Kit

Chrome plated hardware fits lower leg cap Showa & Kayaba forks 1973-on.

4380

XL-FX Fork Parts

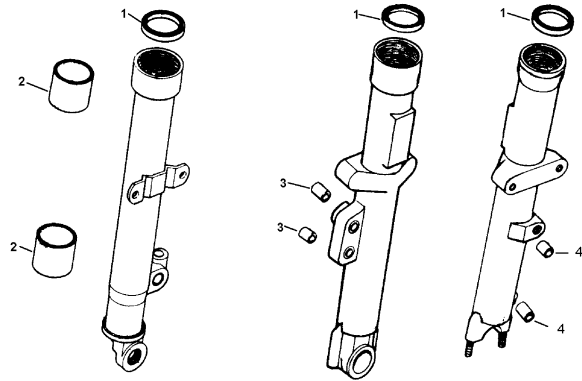

PCP	OEM	Description
1 2562	45975-71	FX Fork tube seal 1971-72 (pr)
1381	45927-73	FX & XL Fork tube seal 1973-74 (pr)
1380	45400-75	FX & XL Fork tube seal 1975-82 (pr)
2 18578	45818-52	XL Fork leg bushing upper (ea) and lower 1954-72
3 3797	45821-75	FX Fork leg caliper bushing (ea) long upper 1973-77
3801	45822-75	FX Fork leg caliper bushing (ea) short lower 1971-77
4 3791	46018-77 46019-77	FX-XL for leg bushing (set of 4) set upper & lowers 1978-83



Deluxe Fork Seal Rebuilding Kits

Kits include pieces shown as appropriate for each application.

PCP Application

- 40031** 35mm Kayaba 1973-74
40032 35mm Showa 1975-84
40034 35mm Showa 1984-87
40035 41mm FLH 1977-84
40036 41mm FLH 1949-76

Caliper Mounting Bushings

This set of American-made caliper mounting bushings will fit all dual disc fork legs from 1977-83.

- 3791** 46018-77, 46019-77 (4 pk)



XL Fork Stem Parts



Neck Cup Conversion

Bearing cups for converting Sportster 1952-76 cups with ball bearings to tapered style roller bearings. Complete set includes: two chromed cups, two tapered bearings and chrome top dust shield. 1978-on are for stock replacement.

PCP	Description
549	Kit 1952-76 (shown)
5754	Bearings 1978-81 (45586-78) (pair)
27210	Cups with races 1978-81 (48310-78)
11668	Upper dust shield 1979-81 (45597-78)
11669	Lower dust shield 1979-81 (48370-78)
27211	Kit with 2 dust shields all 1979-81
27212*	Kit with 2 bearings and 2 shields, 1982-on
15515	Bearing only 1982-on (sold each)

*Note: Does not include neck cups



Narrow Glide Chrome Lower Triple Tree Covers

A 3-piece chrome cover assembly designed for easy customizing of the black painted lower triple tree on all 1957-85 XLX models without having to dismantle the forks. Easy installation. Ideal for any 1971-on XL or FX "Narrow-Glide" 35mm only.

4531	3 piece kit
2472	1 piece cover XL 1970-on, FX 1971-87 (45751-71TA)
8757	Colony button screw kit

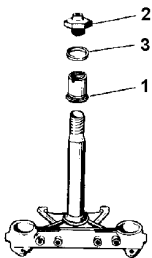

XL Stem Post Hardware

PCP	Fits
12579	(1) 54-78 lower nut (45721-54)
N/A	(2) 1954-78 top nut (45722-54)
3267	(3) 1952-78 spacer (45752-52)

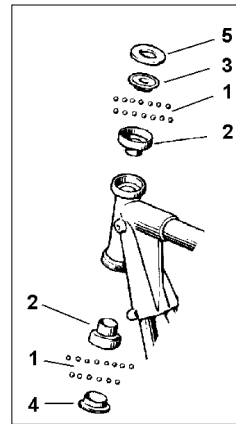

XL Fork Neck Hardware

#	PCP	Description
1	15700	Ball bearings 1954-78, 5/16" (8860) (50 pk)
2	5758	Neck cups 1954-78 (zinc) (48310-30) (pair)
3	19049	Upper race (48346-39)
4	3799	Lower race 1952-77 (48347-52)

(5) XL Dust Shields (Zinc)

Bearing dust shields for XL's 1978-on.

PCP	Fits
11711	Upper 1952-78 (48370-52)
11668	Upper 1979-81 (45597-78)
11669	Lower 1979-81 (48370-78)
5760	Upper 1982-on (48361-80)
1159	Lower 1982-on (48365-48A)



Stem Bolt & Cover Kit

Complete kit includes sleeve, stem bolt, dust shield, spacer rubber plug and chrome cover. Fits all Sportster 1957-78 without steering damper.

5399	Complete kit
5400	Cover and rubber plug only

Early Fork Cover Set K, XL

Chrome plated steel panels as shown. Top panel does not have key switch hole covers or provisions for them.

45446	(46298-52A, 46269-52, 46292-52, 46291-52)
-------	---



Acorn Type Fork Stem Nuts

Chrome plated.

1782	1952-77 XL's
1783	1971-on FX-FXS-FXR 1978-on XL-XLH

Fork Tube Bolt

Custom chrome plated MID 85-87 XL, FX, coarser thread.

5485	Each
------	------



Fork Boots

Replaces 46001-54 on 1954-70 XLH-XLCH. Also for extended glide forks.

2928	(pair)
------	--------

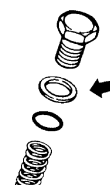

Tube Cap Washer

Replaces 45997-73 on all FX-XL-FXR 1973-on Showa & Kayaba fork legs.Chrome.

9964	Pairs
------	-------

Handlebar Mount Kits

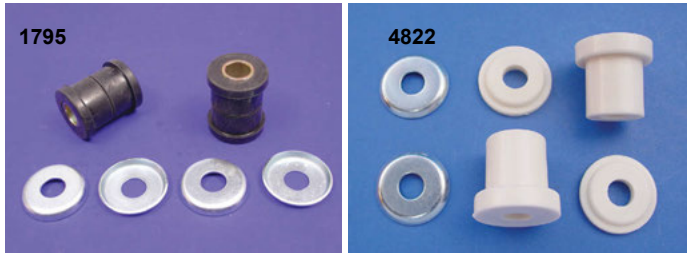

Handlebar Damper Kit

A rubber handlebar mounting rebuilding kit complete with handlebar spacers, cup washers and rubber bushings for all Harley models 1973-84. Each kit mounts one set of handlebars. OEM 56153-73, 56158-73 and 56159-73.

1795 Kit with zinc washers FX-XL-FXWG

51002 As above chrome washers

Nylon Handlebar Damper Kit

Machined white nylon, provides a stiffer, dampening action, and longer life for all FX-XL 1973-84.

4822 Kit with zinc plated washers

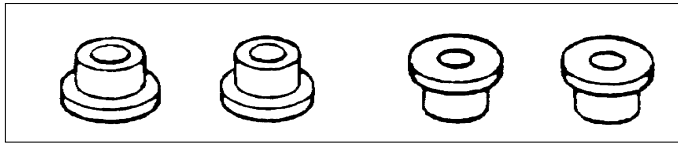

Handlebar Damper Bushings

Sold in sets of 4 to replace OEM rubber type.

51008 FXE, FLT 1948-85, FXR 1982-94 (56158-73)



Riser to Top Tree Dampner 1949-72

PCP Description

3804 FL handlebar dampners STD size (56158-49) (pair)

18618 Handlebar bushing +.007 O.S. (pair)

4509 Riser-dampner rubber bushing washer only FL-XL (56159-49) (pair)



Handlebar Cable Cover

An exact reproduction of a long-obsolete original equipment part, this cover fits between handlebar and fork on 49-59 Harleys. It streamlines the appearance between handlebars and the top of the triple tree, and protects wiring and cables.

4506 56600-49

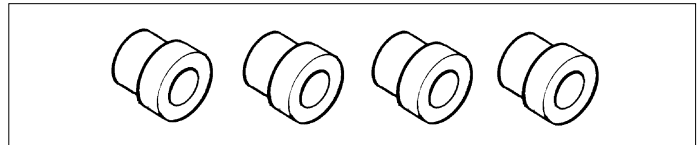

Handle Bar Bushings

American made bushings consist of vibration absorbent polyurethane for 25% stiffer construction than stock rubber units. Four piece set fits FX, FXR, XL 1973-on. Replaces OEM 53156-86 & 56158-86.

51003

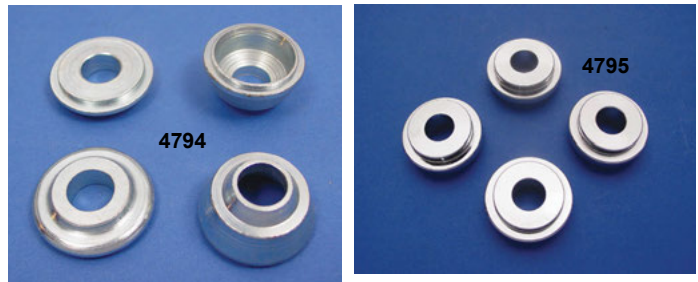

Solid Handlebar Mount Kits for Harley

Designed to eliminate rubber-mounted handlebars. Will fit all top fork trees. Easy to install and highly recommended when installing high bars and/or risers.

4794 1962-84 FL, 1979-84 FLT, 1984-on FLT

4795 1973-on XL, 1973-84 FX, 1982-94 FXR, 1991-on FXD



Colony Chrome Riser Bolt Sets

Each chrome polished set includes 2 bolts and 2 lockwashers.

Allen	Hex	Size
72094	72135	1/2-13 x 2-1/2
72095	72136	1/2-13 x 2-3/4
72129	72137	1/2-13 x 3
72130	72138	1/2-13 - 3-1/2
72131	72139	1/2-13 x 3-3/4
72132		1/2-20 x 2-1/2
72133		1/2-20 x 2-3/4
72134		1/2-20 x3

Mirrors



Chromed Stock Style Mirrors

PCP Fits

847 Tin mirror right or left side. (4" x 5") (91869-83T)

848 As above, w/clamp (4" x 5")



Chrome Mirror Extension Kits

These kits are used to extend mirrors approximately 2"

27129 Kit (91907-87)



Custom Round Mirrors (each)

4753 3" mirror

4754 4" mirror

1456 3" clamp-on mirror with 10" stem

1457 4" clamp-on mirror with 4" Stem



One Piece Die Cast Chrome Mirrors

Swivel head type for 1965-on, all models.

PCP Type

6611 Short right (91875-82T)

6612 Short left (91892-82T)

6613 Long right (91879-82T)

6614 Long left (91894-82T)

891 Short left or right (91875-70)



Mirror Marker Light Mount

17047

For a Larger Selection of Mirrors, Risers and Handlebars see Section 6 of our TC/EVO main catalogue

Handlebars

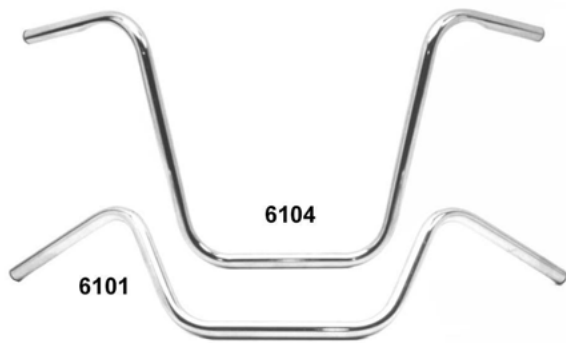

Police Style Bars

Wide style FLH tour bars. Measures 12" across riser mount area. Excellent for Dog Bone or Flanders style risers. Keeps grips 31-1/2" apart and a 4" rise for full control. Pre 1982
6100

Ape Hangers

Show chrome plated. Our 1" dia. ape hangers are 38" wide at the grips. Center 11". Available in 8", 10", 12" and 16" heights.

6101 8" Rise to 1981

6103 12" Rise to 1981

6104 16" Rise 1982-on (no knurls for riser area)



OEM Style Stainless Bars

For FX-XL models 1974-81 no indents.

51826 (56083-74)



Stock FXWG Pullbacks

Replaces OEM 55950-80. Good looking and comfortable, these regular pullback style handlebars feature smooth flowing bends, heavy wall steel tubing, and an outstanding chrome finish, a medium rise height, a good wide handle spread, and narrow mounting width, make these pullbacks one of the most popular handlebars of all time.

6335 FXWG pullback

Cruiser Handlebars for Pre-1982

These bars are 26" wide with a 3" rise, riser space is 5". Chrome plated for pre-1982; (no indents).

51835



Replica Glide Handlebar Set

Chrome duo-glide bar set with push throttle spiral on the right hand side. Left side is grip only. For use with Bendix carbs on FL 71-73 models.

51855

For a Larger Selection of Mirrors, Risers and Handlebars see Section 6 of our TC/EVO main catalogue

Handlebars

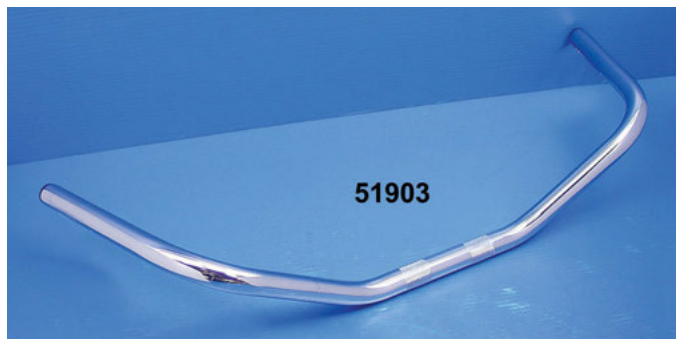

Low Rise Pullback Handlebars (pre 1982)

Replicas of original FXE bar. Measures 7-1/4" across riser mount area. 4" Rise and 7-3/4" grip area. 27" Across.

51903



Two Piece Buckhorn Style Bars

Original buckhorn type features knurls to fit stock riser block on 1970-78 FL. 1" Diameter enables snap throttle to be used.

51923



Speedster Style Bar

Features wide format and will accept cross bar which is sold separately.

PCP	Item
51850	FX-XL handlebar
19847	Cross bar



Replica Lever Assembly

Replica lever assemblies include a slotted lever bushing as OEM with a small hole for brake or clutch. BT1941-64 and XL 1954-64.

50208 Chromed



Chrome Handlebar End Plugs

These are accessorized with jewels and skulls.

50000 Plain chrome (10 pack)



Allen Bolt Custom Cap Covers

These cap covers are sized by bolt thread diameter. Chrome plated and machined from aluminum, these caps come with set screws and an allen wrench. **Sold in pairs.**

45310	1/4"
45311	5/16"
45312	3/8"

Ball End Lever

Constructed from heat treated aluminum alloy and polished to a chrome like finish. The rounded end eliminates the dangerous sharp end on all early endurance model 1941-65 Harley-Davidsons.

50242 45017-41



Chrome Cable Wrap-60" Long

Classic 50's style dresser trim item.

45196 3/16" diameter

Handlebars



Early Glide Bars BT 1949-59

One piece style accept internal controls.

93034 BT 1949-53 (56049-49)

6337 BT 1954-59 (56049-54)

2 Piece Stock Bars

Use on all models 1960-64 FL, XL. Internals and grips not included. Replaces 56054-60 & 56058-60.

6338

ABOVE Handle Bars require hand fitting for proper assembly of internals.



Handlebar Cross Bar

Curved, 1" bar features milled ends and fits 1936-57 spring fork bars. Includes 2 chrome clamps and bolts.

19847



Chrome Cross Bar

OEM type with clamps replacing 56575-26 for FL model handlebars.

51101 Cross bar

73517 Clamps for cross bar

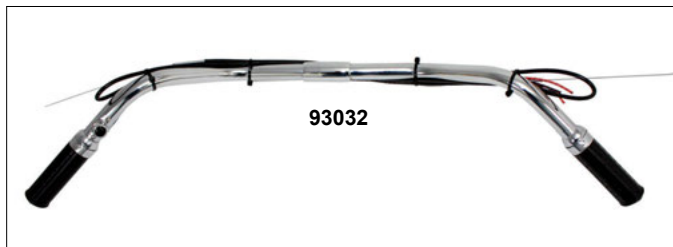
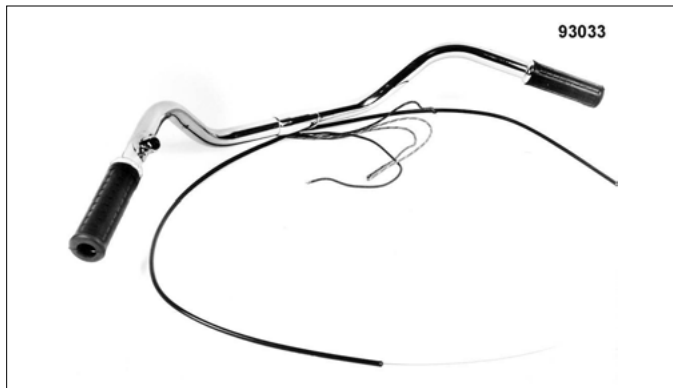

Early Glide Bars

Bars use stock internal components for years listed. Feature 1 piece design with reinforced centre. Some hand fitting of internals may be required.

93032 1949-53 Assembly (see note A)

93033 1954-59 Assembly (see note B)

93035 1954-59 Assembly (see note C)

51849 FL-FLH 1965-73 (56070-65, 56085-65) Shown with black mounting bracket #3553, not included

NOTE: A Complete with push throttle/spark/switches

B Complete with push throttle/push spark/switches

C Complete with pull throttle/push spark/switches



Braided Outer Throttle and Spark Control Cable

Replica outer throttle and spark control cable includes 2 outer cable housings with black cloth covered braid and 2 inner wires.

PCP Application

28643 FL 1949-53

28642 FL, XL 1954-59

Handlebars

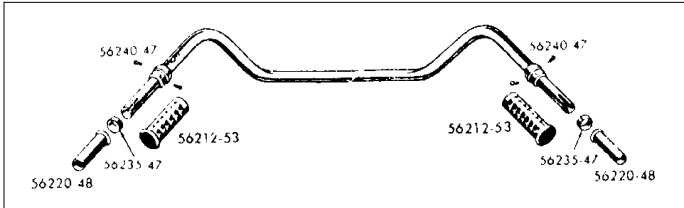

Throttle Control Parts All Twins

PCP	OEM	Description
19207	56220-48	Grip spiral 1949-53
19178	56528-49	Outer control casing 1949-53
19180	56373-09	Inner wire 1909-48



Throttle/Spark Control Cable

Rubber coated, braided cotton as on 1949-52. Outer 60", inner 66" wire. Replaces 56628-49C.

19276



Handlebar Plunger

Accurate reproduction of throttle and spark plunger OEM 56400-53. Fits FL 1954-74, FX 1971-73, XL 1954-73 and Servicar 1954-73. 1 plunger and 1 set screw per kit.

9514



Throttle and Spark Cable Bracket OHV BT 1949-53

Original style replicas feature a parkerized finish and include mounting hardware.

19302 (56605-49B)



Brass 4" Dog Bone Riser Set

For 1" bars. Cast brass generally has small surface imperfections like casting voids or pits. Brass may dull with age but can be re-polished to a high lustre. Brass is soft so care must be taken not to dent them with a wrench or hammer.

21092



19202

Throttle Spirals and Cable Kits

Kits include all internal parts required for years listed.

PCP	Years	Sides	Throttle
19201	1949-53	2	Push
19202	1954-73	2	Push
19203	1965-70	1	Push
19204	1971-73	1	Pull

Handlebar Spirals

PCP	OEM	Description
19207	56220-48	1949-53 raw
19208	56220-53	1954-70 raw
19209*	56220-58	1971-74 throttle, raw

Note: Reverses direction on 1954-70 throttle

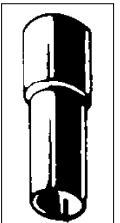

Inner and Outer Throttle Spark Casing Assembly

PCP	OEM	Description
19178	56528-49	1948-72 Outer, small
19276	56628-49C	1949-52 Outer, small, cotton braid
19179	56360-61	1961-72 Outer, small, vinyl
19180	56373-09	All, inner wire 1909-38

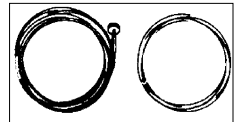

Handlebar Throttle & Spark & Roller Pin Kit

Hardened and ground rollers, pins and cable screw.

8924 All H.D. 1954-74, OEM: 9261, 56278-10, 10-32 set screw

Risers



Early Style Glide Risers 1949-59

Chrome riser feature rubber bushings for use on FL models 1949-59. Top link is available separately #3811 if required.

19173 Chrome set (3")



BT 2-1/2" Riser Kit 1949-59

Kit includes 2 chrome post risers with zinc plated caps, chrome riser link with 4 studs and acorn nuts, 2 rubber bushings, 4 screw rubber washers, 2 screws and 2 flex lock nuts. Replaces 56141-49.

51331 Riser holes C/C 4-3/4"



Chr. Handlebar Riser Link Cap 1949-58

Fits FL models using Stock type FL Risers 1949-on. 4-3/4 c/c.

3811 56165-49



Handlebar Riser Cap

To fit over domed risers. 3-1/2" c/c.

3807 56148-49

Chrome Handlebar Riser Kits in the FL 1949-59 Style with Top Clamps

Beautifully chrome plated. Kits are complete as pictured with all necessary mounting hardware for one piece handlebars.

51326 4-1/2" with 4-3/4" centres

51328 4-1/2" with 3-1/2" centres



One Piece Handlebar Clamp

For 2 piece handlebars. Fit FL models 1960-78 (black).

3553 56104-52

Note: All riser measurements are from the bottom of post to the bottom of the handlebar hole

Handlebar Risers



Flanders Style Risers

Original type rubber mounted with 4" rise for springer Dog Bones style top tee.

3062 Chrome plated (pair)



Flanders Riser Sets for Spring Forks

Risers fit 1" diameter handlebars. Available in chrome or cast solid brass. Cast brass generally has small surface imperfections like casting voids or pits. Brass may dull with age but can be re-polished to a high lustre. Brass is soft so care must be taken not to dent them with a wrench or hammer. Fits FL 41-48.

Chrome	Brass	Size
-	51605	2"
51604	51603	3.5"
51602	51606	5.5"



Chrome Paughco Post Risers

Machined steel risers have 1/2x20 internal for mounting.

PCP	Rise
51341	3"
51342	5"



Custom 1" Risers (Pair)

Brilliant chrome finish. These die cast risers will mount to all top trees, use 1/2-13 mounting bolts (not supplied)

838 4-1/2" Round plain

842 2-1/2" Round plain

2451 2-1/2" Round fancy pullback



Stock Type Risers

Chromed steel risers feature original tapered type, through bolt design. Bolts not included.

PCP Rise

51354 3"

51355 4" threaded

51356 5"

51357* 5" w/iso inserts

51358* 3" w/iso inserts

*Note: Feature rubber ISO inserts and 5/16" allen screws



Handlebar Spacers

For 7/8" bars to 1" risers.

2459 Set of 4

Note: All riser measurements are from the bottom of post to the bottom of the handlebar hole

Risers & Clamps



Chrome Die-cast Stock Style Risers

PCP	Fits
2254	4" FXS 1977-82, FX, XL 1974-82 (56122-77, 56124-77)
840	3-3/4" FXWG style (56098-80, 56099-80)
3551	1-1/2" Stock risers. FX-XL 1974-83 (56116-77, 56117-77)
51310	1-1/8" short risers for FL L1977-84 fit under handlebar clamp (59940-79, 59941-79)

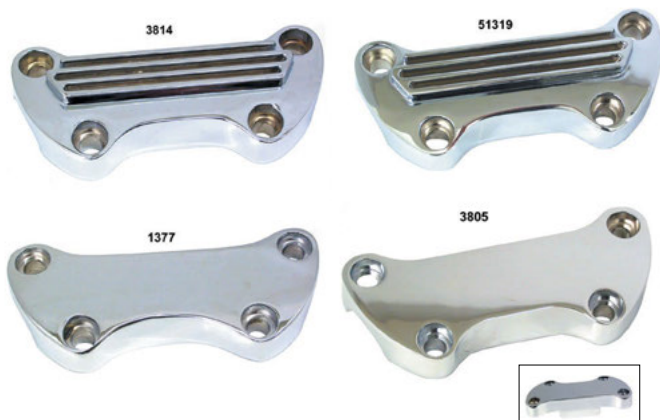

Handle Bar Clamps for 1974-on

Clamps fit 1974-on FX-FXR-FLH-FXST. Choose short type for 1979-on XL models where gauge housing mounts under clamp and choose a long skirt type where it blends with riser tops.

Chrome Ribbed Top

3814	Short replaces (56115-79)
51319	Long (with skirt) (56119-77)

Chrome Smooth Top Clamp

1377	Short
3805	Long (with skirt) (56104-74)



Vintage Top Clamps

Fits 2 piece OEM or aftermarket stock type risers 1974-on.
51321



5-1/2" Chrome Straight Riser Kit

Risers measure 5-1/2" tall and replace OEM 56223-98 on FX, XL and FXR models 1977-on. The use of longer cable, wiring or brake hose may be necessary.

51330	Rib style
51335	Smooth style



Eagle Riser and Clamp Kits

Fits BT and XL 1973-99 with 3-1/2" spacing.

51336	Straight 3-3/4" (1/2"-13 threaded)
--------------	------------------------------------

Handlebar Top Clamp Bolts

Chrome bolt sets for FX-XL.

PCP	Type	Year	Model
5387	Allen	1982-on	FX-XL
5312	Cap	1974-on	FX-XL
9636	Allen	1974-on	FX
		1983-on	XL



Handlebar Cover Clamp for FLH 1960-79

Damper and non-damper versions available.

PCP	Description
3806	Chrome with damper 1960-79 (58589-60)
3810	Chrome without damper 1960-79 (58590-60)
45347	Polished smooth 1960-79 (56590-60)

Handlebar Control

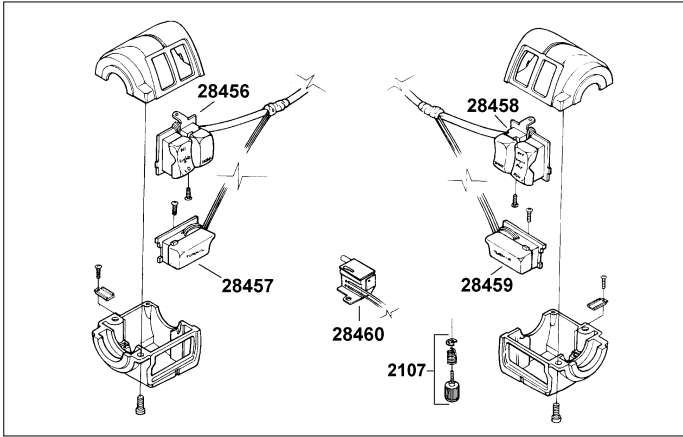

1982-95 Handlebar Switch Assemblies, Black

PCP	Item
28457	Left turn signal (71599-92)
28458	Engine, stop/start (71589-92)
28459	Right turn signal (71591-92)
28456	Dimmer & horn (71597-92)
28460	Stop switch, front (71590-92)
1346	Stop switch 1972-81 (72001-69B)
28450	Switch Kit, one each of above switches black (set)
28451	As above, chrome set
2107	Throttle adjusting screw all models 1974-on with stock throttle (56397-74A, 56394-74)



1982-95 Switch Housings Not for Radio

A 4-piece chrome set replacing upper & lower of right & left sides. Use your existing screws and wiring/switches for assembly.

46010	Kit (Set of 4) 1982-95 (not for radio)
24551	10 Screws, (OEM 2508) SS finish



Polished/Chrome Allen Bolts

8767	Switch box kit 1982-95
8766	Switch box kit 1973-81



1982-84 Chrome Handlebar Controls

Chrome handlebar mounted brake & clutch control assemblies with switch housing (use your OEM wiring parts). The clutch lever assembly includes both style of cable pin which will permit the use of the early style cable, as well as the latest eyelet type.

PCP Fits

90110	Kit with 3/4" (.750") bore master cylinder for all dual disc models 1982-84
-------	---

Replacement Parts

46700	Chrome 3/4" (.750") bore master cylinder for all 1982-84 models with 10mm thread (45013-82, 45019-85)
46707	Black, as above
46001	Switch housing, right top (71564-82)
46002	Switch housing, right bottom (71563-82A)
46003	Switch housing, left top (71567-82)
46004	Switch housing, left bottom (71568-82A)
46005	Replacement lever clamp only, for clutch & brake (45044-82)
46006	Clutch lever assembly with anti-rattle device (includes #46005) and necessary hardware
10165	Replacement nylon pin for eyelet style cables (45036-88) (5 pack)



Clutch Lever Assembly 1982-95

PCP	Description
46006	Chrome assembly (with anti-rattle device)
50211	Black assembly
50205	Black clamp and bracket (38608-82A)
50206	Chrome, as above

Handlebar Wiring

28448



28449



91209



Chrome Handlebar Control Kits for 1972-81

These complete chrome-plated control kits are offered in two versions. The kit contains the master cylinder and clutch lever assembly with two switch housings, all handlebar wiring harnesses and switches attached, the buttonswitch caps and all the necessary mounting hardware required.

6705 Chrome kit w/wiring and chrome switches and caps

91209 Chrome kit with wiring and black switches

91205 Chrome kit with chrome switches and caps

Handlebar Wiring Harness with Switches

Complete with soldering already done. Includes wire connectors, buttons, screws, stop light switch rubber boot and switch retaining plates. Fits all 1972-81 BT and XL 1973-81 colour coded to match the OEM wires. 48" long kits fit tall handlebars.

28448 Black switches with 40" leads

28449 Chrome switches with 40" leads

3249 Black switches with 48" leads

28447 Chrome switches with 48" leads



28450

28451

28650



Complete Harnesses with Switches 1982-95

Each switch set comes with a 48" wiring harness which will accommodate tall handlebars. They are ready to install in **your switch housings**. Fits all Sportster® and Big Twin models (except those with radio controls) 1982-95.

28450 Complete Kit, Black

28451 Complete Kit, Chrome

Replacement Switches

Suited as replacements to the original parts. Comes soldered to 12" lengths of wire. Fits all Sportster® and Big Twin models 1982-95.

Black	Chrome	Description
28456	28461	Dimmer/Horn (71597-92)
28457	28462	Left Turn signal (71598-92)
28458	28463	Engine Start/Stop (71589-92)
28459	28464	Right turn signal (71591-92)
28460	-	Front stop switch (71590-92)

Handlebar Harnesses for All Models 1973-95

Colour coded, correct guage, 36" & 48" long wiring harnesses that replace the OEM shorter harnesses. Both kits have black vinyl casing. Early kit includes connectors and terminals. Late kit has connectors and handlebar wiring retainer clips.

28650 1973-81 Stock (36")

28651 1973-81 Extended (48")

28652 1982-95 Stock (36")

28655 1982-95 Extended (48")



91203

Handlebar Control Kit

Fits 1972-81 Harleys. Includes master cylinder assembly, clutch and brake levers, clutch lever bracket and two (2) vertical switch housings. Reuse OEM wiring.

91206 Polished kit

91204 Chrome

91203 Black

Handlebar Controls



Handlebar Switch Housing

Chrome-plated or polished reproductions of original equipment. If you wish to relocate your control switches we also offer a plain switch cover to give you a clean custom appearance. The switch housing will accept our rocker switches and buttons. These components fit XL, FX, FXE and FL models 1973-81.

PCP Finish Type

Vertical Switch Housing (71539-73B)

- 2194** Chrome
4768 Polished

Horizontal Switch Housing(71539-72)

- 4769** Chrome
4770 Polished

Block Off Switch Cover

- 2265** Chrome
4767 Polished



Dome-Switch Housing

A new design shape, chrome plated and fits 1972-81 all models. Sold in pairs with chrome allen screws.

50500



Chrome Banjo Bolts and Washers

Replacement banjo bolts for OEM & PC 46700 handlebar master cylinders for models 1982-on.

24030 Fits master cylinders with 10mm brake lines (41747-82A)

24031* Fits PC Master Cylinder 46700 ONLY when 12mm brake lines are used on 10mm cylinder

24029 Fits master cylinders with 12mm banjo fitting (41739-84A)

*NOTE: Allows use of 12mm lines on a master cylinder with 10mm thread

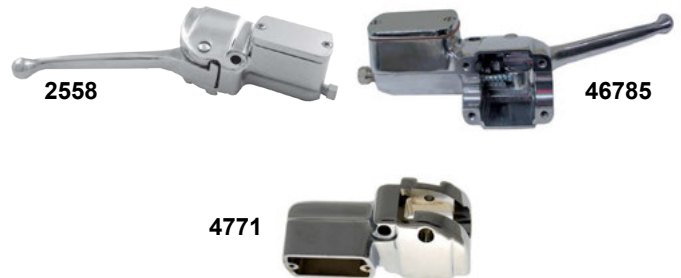

Master Cylinder Assembly

Chrome-plated master cylinder assembly. Includes brake lever, custom master cylinder cover, brake line fitting, stoplight switch and all other internal components. Fits all XL, FX models 1973-81 and FL models 1972-81.

PCP Description

- 2558** Chrome master cylinder assembly (45010-73C)
46785 Polished, as above
4771 Chrome master cylinder body (45024-72)

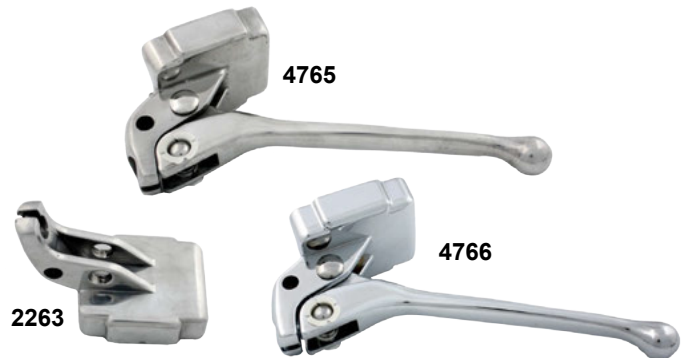

Clutch Lever Assembly for Harley 1973-81

Complete assembly includes lever, lever bracket, pivot pin and clip, cable anchor pin and plastic pin bushing set.

PCP Description

- 4765** Lever assembly polished
4766 Lever assembly chrome
2263 Bracket, polished (38608-73)
2193 Bracket, chrome (38608-73)

Control Box Decal Set

Includes decals for right and left handlebar switch boxes. Use on Big Twins 1973-81.

892 Set

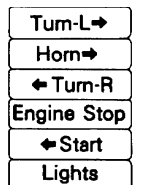

Chr. Switch Housing Mount Kit

Mounting kit for the handlebar switch housing cover.

Acorn	Allen	Cap	Years
	5388		Pre-1973
2635	5358	5255	73-81
	5359		82-95

892 Decal set

Handlebar Levers



Complete Assemblies Clutch or Brake

Polished

PCP Description

- 1417** FL, FLH 1952-67 small 5/16" cable hole (45002-65A)
1419 XL 1965-70, XLH, XLCH 1965-70 larger 7/16" cable hole (38604-65A)
1418 BT 1968-72, XLH, XLCH 1972 only medium 3/8" cable hole (38608-68)

Chrome

PCP Description

- 3719** FL, FLH 1952-67 small 5/16" cable hole (45002-65A)
3727 XLH, XLCH 1965-70 larger 3/8" cable hole (38604-65A)
3723 XLH, XLCH 1972 only medium 3/8" cable hole and BT 1968-72 (38608-68)

POWERLEVER



808



809

Lever Blades 1972-81

PCP Description

- 809** All clutch or shoe brake, polished
810 As above, chromed
808 All disc brake, polished
811 As above, chromed



Power Grip Levers for Harley 1965-81

Strong, solid aluminum, chromed easy-pull power grip style clutch and brake levers for all Harley models 1965-81.

- 1459** Clutch and drum brake lever for all models 1965-81
3701 Polished, clutch/brake lever, FL 1965-71, FX 1971-72, XL 1965-72 (45024-65A)
1460 Disc brake lever for all models 1972-81



50200

50201

1982-95 Clutch & Brake Lever

- Sets feature Girder design with smooth ball or skull end

PCP End Style

- 50200** Smooth
50201 Skull



Lever Blades 1982-95

Brake

PCP Finish

- 2440** Chrome (45064-82)

Clutch

- 2439** Polished (45017-82)
2441 Chrome (45062-82)

Handlebar Levers



1941-64 Replica Brake Clutch Handle

Features accurately formed clamp and cadmium plated hardware to replace 45002-41.

50236



Replica Parkerized Hand Lever Assembly

Parkerized cast investment steel like the original military version. Correct on 1941-46 models. Fits 1941-64 FL.

50262



Winged Brake and Clutch Levers

These attractive levers are die cast and chrome plated.

50209 All models 1982-95 (pair)

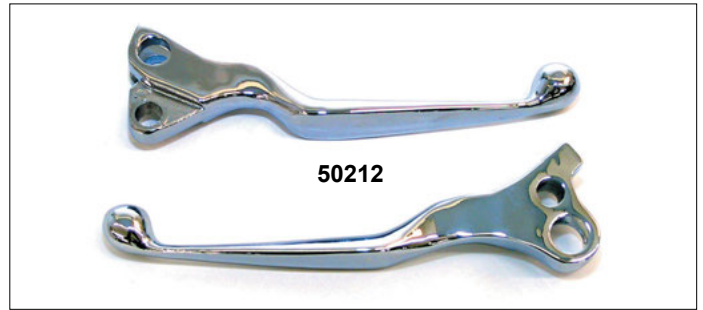

Contour Levers

1972-95 Style levers are sold in sets.

PCP Application

50212 1972-81 chrome

50213 1972-81 chrome w/skull

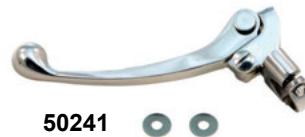

50241



50242



50245



50244



50208

Replica Lever Assemblies

Include slotted lever bushing as original with small hole for brake or clutch.

PCP	Finish	Item
50208	Chrome	Complete assembly (45002-41)
50241	Chrome	Complete with ball end
50242	Polished	Lever only with ball end
50244	Polished	Lever only, stock style (45017-41)
50245	Chrome	Lever only, stock style
16280	Parkerized	Lever clamp strap
5409	Cadmium	1941-64 Pin and nut (45031-41)
10160		1949-64 Lever bushing w/cotter (45033-49)

Lever Control Hardware



Lever Pin and Bushing

Pivot Pin With Clip for Harley 1965-81

Replacement pin and clip for all plain and chrome lever assemblies as well as OEM replacement. (OEM 45031-65 & 11036).

10160 5 Pack

Lever Bushing for Harley 1949-64

Slotted bushing for old-style Harley levers. Accepts Harley cable end. Plated and furnished with cotter pin.

10160 45033-49 (5 pack)

72809 Colony kit with cad bushing washer and cotter pin



Clutch Cable Pivot Pins and Bushings

Nickel-plated slotted pins with two nylon bushings. Fits the clutch levers on 1965-81 Sportster® models and 1968-81 Big Twins. Also fits the front brake lever on 1965-72 Sportster® models, 1968-71 FL's and 1971-72 FX's.

10163 45039-68, 45036-68 (5 pack)

13410 Nylon bushing (45039-68) (10 pack)

10164 Hand lever anchor pin all 1982-87 (45036-82).



Chrome Lever Pins

Allen style for pivot point on 1982-07 models, replacement for stock clutch and brake pins (use stock retaining ring), sold in pairs (45032-82).

10200 Pivot pins

Cable Clamp

For use on Harleys. Fitted to hand lever for emergency or permanent use. Easy to install. .460" diameter.

1297 Cable fix (each)

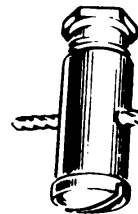

Clutch & Brake Lever Pivot Screw Kit

Cad plated reproduction of pivot screws and nuts used on clutch & brake levers. Big Twins & 45's 1941-1964.

5409

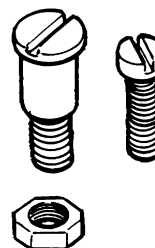

Handlebar Switch Repair

Includes 4 screws, 2 retainer clips for button switches (71533-72), and 4 button black caps. 1972-81.

1884 Set

3472 Retainer clips only (71533-72) 10 pack.



Hand Lever Pivot Pins

For brake and clutch sides.

PCP Item

10159 1982-87 Pin (45032-82) (Each)

11035 1982-87 Snap ring (11143) (10 pack)

10187 1965-81 Pin and clip (45031-65) (5 pack)

11018 1979-84 BT, 1972-90 XL Snap ring (11036) (10 pack)

Throttles & Grips



Throttle Kit 1973-81

Includes throttle assembly 56500-74 and grip set 56206-74, with chrome end plugs, single cable model on FX-FL-XL 1974-80.

PCP Fits
4780 Kit

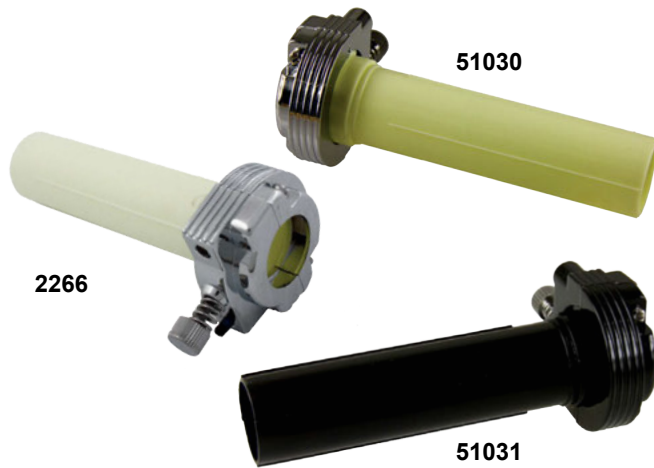

Throttle Assemblies

Replacement 1" throttle assemblies with screw.

Black	Chrome	Type	Application	OEM
51022	2266	Single	73-81	56500-79
51031	51030	Dual	82-95	



Short Stock Grip Set

Smooth original style. OEM replacement #56205-62. Set includes chrome end plugs. Fits FL-FLH 1962-73.

5271 Black
5272 White



Throttle Pipe and Rubber Grip Sets

Single and dual cable throttle pipes complete with our replacement grips, and end caps. Single assembly fits all models from 1974-81, and dual assembly fits all models from 1982-95. Sold in sets.

51250 Single cable 1974-81
51251 Dual cable 1982-95

Throttle Control Adjusting Screw

For all Harley models 74-85 with stock throttle or our 4780 or 4782 chrome throttle controls. Includes spring.

2107 56397-74A & 56394-74



Chrome Throttle Clamps

Features smooth design and includes upper and lower pieces with screws for single or dual cable applications.

73506 Single 1973-81
73507 Dual 1982-95



Throttle Clamp Sets

Die-cast clamp sets include the upper and lower clamp with screws.

PCP	Application	Type	Finish
4784	73-81	Single	Chrome
73546	73-81	Single	Black
4785	82-95	Dual	Chrome
73547	82-95	Dual	Black

Throttles & Grips



4782

Throttle Assembly Dual Cable

Replaces OEM 56395-81. For 1981-on Twins with push-pull type cables. Chrome housing with nylon throttle tube.

PCP Fits

4782 Dual assembly w/grip kit 1981-05 (56395-81)

3707 Throttle liner with clamps (56324-81A)

4783 Grip set 1981-86

50000 Chrome end plugs (10 pk) (56238-62)



51213



51219

Throttle Assemblies

Single and dual cable models with chrome throttle clamps offered in either our "Comfort Touch", or Rubber Textured Comfort Touch grips to fit all models from 1974-81. Single cable assembly fits all models from 1974-80, and the dual cable assembly fits all 1981-on.

With "Comfort Touch" Grips

51212 Single cable

51213 Dual cable

With Rubber Textured Grips

51218 Single cable

51219 Dual cable



51228

51229

Replica 1962-65 Ribbed Grip Set

Plastic grip set has a 1-1/8" ID that fits most stock controls.

51228 Black (56205-62)

51229 White (56201-62)



23091

Vintage Style Grip Set

These grips are styled after the logo type 1909 early grips, but are designed to fit late model bars and throttles. 1974-on and all universal 1" and 1-1/8" twist assemblies.

23091 Black

5430 White



51248

ISO Handlebar Grip Set 82-95

Chrome grips feature black rubber slots.

51248

For a Larger Selection of Mirrors, Risers and Handlebars see Section 6 of our TC/EVO main catalogue

Grips & Accessories



Comfort Touch Grip Set 1974-81

The latest in handlebar grips for today's motorcycles: perfectly-sized rubber sleeves covered in soft neoprene. The soft foam cover absorbs vibration and stops finger "tingles". The grips are capped with beautiful chrome-plated ends. Replacement neoprene foam covers are also available. Available for all Harley models 1973-on, without air reservoirs.

51202 Grip set for handlebars without air reservoirs (pair)



"Eagle Passion" Sets

Feature full cell foam covering for comfort touch. Chrome or gold inlay end caps.

PCP **Finish/Covering**

51230 Chrome comfort touch foam

51231 Gold inlay comfort touch foam



23104



5437



23105



5440

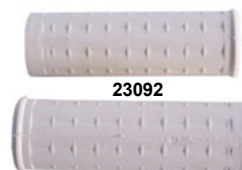

23092

Grips

PCP **Fits**

2269 Black clutch side grip 1974-80 with 1" hole



Chrome Bar Grip End Plugs

These are accessorized with jewels and skulls.

50000 Plain (10 pk) (56238-62)

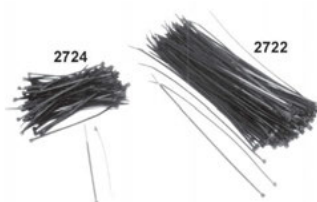

2724

2722

Black Cable Ties

Sold in bag of 100.

2724 4"

2722 7"

1952 Waffle Style Stock Grips

OEM replacement #56212-53. Replica-waffle style. Fits all H.D. models 1949-61. Sold in pairs

PCP	Year	Size	Style
23104	1949-72	1-1/8"	Black, smooth-no plug hole
5437	1949-72	1-1/8"	Black with plug hole
23105	1949-72	1-1/8"	White with plug hole
5440	1974-on	1" & 1-1/8"	Black waffle style
23092	1974-on	1" & 1-1/8"	White waffle style



23093

23095

23096

Stock Grip Sets 1974-on

Replaces 56206-74 for 1974-on FX, FL models with 1-1/8" and 1" size.

Black **Application**

23093 1974-on with chrome plugs

23106 As above, white

23095 1974-on, no plugs

23096 1981-on, does not accept chrome plugs



23106

Grips & Accessories



Brake Line & Throttle Cable Clamps

For detailing with routing cables, brake lines, & other linkages, our custom clamps are the perfect choice. Our fully machined aluminum clamps are beautifully chrome plated. The big ends fit all the common fork tubes, glide, narrow glide, & 39mm.

27510	1"
27511	1-1/8"
27512	1-1/4"
27513	1-3/8" (35mm)
27515	39mm



Chrome Cable Clamps

Chrome cable clamps hold hanging throttle cables in place. Machined from alloy and chrome plated. Clamps onto 1" bars.

27525	Single cable
27526	Dual cables



60" Chrome Cable Wrap

Is a classic 1950's style chrome dresser trim item, I.D. size noted (5mm is about 3/16") Sold in 5 foot rolls

45196	5mm
45197	7mm
45198	9mm



Chrome End Grip Sets

Feature comfort touch grip area either with foam or leather covering to reduce vibration. Chrome plated end cap with either smooth cap or fringes.

51232	Smooth cap w/black tooled eagle
51233	Smooth cap w/brown tooled eagle
51206	Smooth cap, leather black
51207	With fringe



Long Grip Set 1909-34

OEM replacement #3310-09. Original style used for restoration. Custom application must be shortened. Fits "74" and "80" most stock controls and 45" 1935-52.

5540	Black
-------------	-------



Old Style Short Stock Grips

OEM replacement #3310-35B. Fits "74" and "80" 1935-52 stock controls. Replica style with logo.

5543	Black
-------------	-------



1960's Jack Hammer Grips

Replaces stock 1" and 1-1/8" set. Original style thick rubber. Fits 1" handlebars.

5436
