

Section 18

Twin Cam	1 to 11
Bottom End	12 to 23
Top End	24 to 27
Transmission	28 to 32
Chassis	33 to 38
General	39 to 44



Jims M8 Left Main Seal Remover

The crankshaft oil seal is difficult to remove without potentially damaging the crankcase bore. Insert the removal fingers over the engine output shaft, and then slide the lock collar over the fingers. Once assembled, you can easily remove the seal square to the bore by simply turning a wrench.

31396



Jims M8 Torque Plate Kit

Aluminum cylinders cannot be accurately honed and measured without the use of torque plates. These plates adapt easily to conventional boring bars or a Sunnen type honing machine.

31914

Twin Cam Tools



Jims 25MM Wheel Bearing Remover/Installer

This tool is used to remove & install 25mm, ABS and non-ABS, wheel bearings on most of the 2007-on models using a 25mm bearing. This tool must be used with the earlier Jims wheel bearing installer/remover tool (Jims 1042)

31034



Jims Rear Wheel Compensator Bearing Remover/Installer Tool

Use to remove and install a new compensator ball bearing, after the rear pulley is removed from the rear wheel drive bowl. This bearing is now positioned with the rubber isolators in the drive bowl. the tool will center and guide the installer plug with the center of the pulley for safe bearing installation. Use on all 2008-on XL, FL and V-Rod.

31449

Twin Cam Tools



Jims Late Model Twin Cam Case Splitter Tool

Use this tool to "break" the case sealant by pushing apart both case halves. Flywheels will be pushed from the left case. Not for use with impact tools. Use on all Twin Cam, 2006-on Dyna and all 2007-on FL and FXST.

31913



Jims Twin Cam Engine Stand

Powder coated, steel stand will simplify engine repairs.

31519 All Twin Cam (not FXST 2000)



Jims Twin Cam Beta Engine Stand

Steel, powder coated stand uses special riser mounts to clear the rear balancer housing of the 2000-on Twin Cam B case.

31917



Jims Twin Cam Timken Case Bearing Conversion Tool

This tool is a must for the big cubic inch late model Twin Cam engine builder. It may also be used to replace bearing for stock 88" or 96" engines. Utilizing the special Jims precision insert, it is designed to easily and accurately convert the left side crankshaft roller bearing (24604-00D) to the more durable Timken bearing (9028). This insert is manufactured from aluminum that is several times stronger than the aluminum case material the standard bearing rides in. Conversion can be performed with normal hand tools, a hand drill, and a two ton press.

The tool includes:

- steel bearing insert held to under .0002" total indicator reading
- a press plate that will hold the bearing insert inline with the case bearing bore at the time it is being pressed into the case
- drill bits to drill oil feed and return holes and hardware.

31555 Use on Twin Cam engines 2003-on. **Must** also use tool #31558 for race installation. Order bearing inserts and Timken bearings separately.



JIMS Rolling Buddy

Rubber mounted H-D V-twins use the engine as a structural part of the chassis. When the engine is removed, it becomes impossible to roll the bike. Rolling buddy plates are designed to take place of the engine and bolt the chassis back together. When installed the bike can easily be rolled.

PCP Application

- 31921** Evo Touring, Dyna & FXR
- 31922** 1999-06 Touring & 1999-05 Dyna
- 31923** 2007-on Touring & 2006-on Dyna



TC-88 Chain Shoe Tool

Used to remove and replace the spring loaded cam chain tensioners. Fits FL 99-16 and FXST, FLST 00-17.

26082

Twin Cam Tools



Jims Inner Bearing Remover

Use to remove bearing assembly easily without damage to the crankcase. Tool will also keep pin rollers from falling into the case.

31513 All Twin Cam



Jims Cam Chain Tensioner

Use to unload the pressure on the primary and secondary chain tensioners to assemble and disassemble cams. Will also check spring loads on chain tensioners.

31516 All Twin Cam



Magnetic Tappet Tool

Holds tappets up while changing cams on all TC-88 engines. Fits FLT 99-16, FXD, FLST, FXST 99-17. Sold as a pair. **26079**



Jims Cam Assembly Tool

Use to hold both cams in an upright position while lowering the cam support plate over both guides and cam journal guides. Features non marring material that will not damage cam surfaces. Use on all Twin Cam, 2006-on Dyna and all 2007-on FL and FXST.

31502



Jims Camshaft/Crankshaft Locking Tool

Locks the gear teeth on the TC88 model engine.

31517



Jims Timken Bearing/Race Installer Adapter Kit

Will upgrade Jims# 97222-55 bearing installer tool to work on the fine spline Twin Cam sprocket shafts. Designed to either install (8028) Timken bearing or the roller bearing race assembly (24004-03) onto the sprocket shaft.

Use on BT 2006-on FXD or 2007-on FXST, FL. Also use on Jims 120" engines **31910**

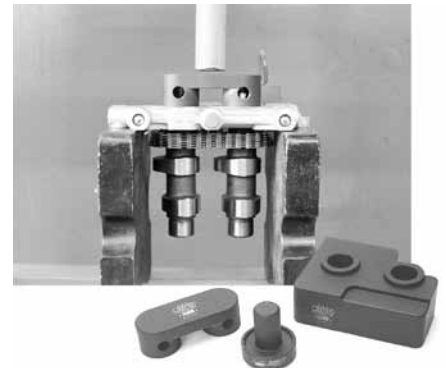

Jims Camshaft Remover and Installer

Use to remove and replace front and rear camshafts and ball bearings in Twin Cams. It provides the precision alignment of the camshaft to ensure a smooth press in and out of the support plate.

31511 All Twin Cam



Jims Inner Cam Bearing Installer

Use to install the two inner cam needle bearings on Twin Cams. It aligns to the shaft bores for a precision press fit

31512 All Twin Cam



Jims Cam Bearing Puller

Use to remove the bearing from camshaft.

31514 All Twin Cam

Twin Cam Tools



Jims Crankshaft Bearing Tool

Use to remove and replace right crankcase bearing. Press bearing in and out straight without damage to the case.

31509 All TC 88A 1999-02

31544 TC 2003-on "A" & Beta I/s case



Jims TC Crankshaft Bearing Installer and Remover

Designed to protect expensive engine cases by using a specially designed support block to remove or install cam side crankshaft bearing. Use press fit lube on case and bearings while installing.

31565



Jims Connecting Rod Bushing Tool

Use to remove and replace wrist pin bushings in Twin Cam without removing connecting rod from crankcases.

31508



Jims Crankshaft Bushing Tool

Use to remove and install crankshaft bushing in the support plate on TC-88.

31515



Jims Sprocket Shaft/Flywheel Holder

Use to hold flywheel assembly in vise, for assisting assembly or disassembly with or without the left case attached. Can also be used to check case clearance on stroker flywheels. Use on all Twin Cam, 2006-on Dyna and all 2007-on FL and FXST.

31018

Jims Rod Holder

Keeps connecting rods in place and eliminates twisting or bending of the connecting rod while reaming or honing the wrist pin bushings. Use on all Twin Cam A & B models.

31520



Jims Crankshaft Guide

Use to spread crankcase pinion bearing rollers while reassembling right side engine case on to flywheel assembly.

31566 All Twin Cam 88 1999-on



Jims Bearing and Race Puller Tool

This tool is designed to remove the flywheel sprocket shaft inner bearing race with the supplied Jims T-bar and hardware. For use on Twin Cams 03-on. Use to remove Timken bearing #9028 or #9029 for 55-on models and Jims 120" engines. Use to remove the flywheel sprocket shaft inner bearing race or the Timken bearing. Also removes pinion shaft inner bearing race on 54-on Sportster, including all Buells. Use to correctly remove press fit transmission gears and bearings from input and output shaft on all V-ROD 02-on.

31903



Twin Cam Tools



Jims Beta Balancer Inner Bearing Remover/Installer

Accurately and safely install or remove the inner balancer bearing mounted in the left engine case. Designed for early or late Beta case work done on a bench without an arbour press. Use on all 2000-on Twin Cam B models.

31542



Jims Balancer Shaft Alignment Tool

This tool takes the guess work out of setting up your sprocket and chain alignment on a "B" Twin Cam Softail engine. Treat this tool with great care, just as you would treat a micrometer.

31584 2000-on Twin Cam "B" Softail models



Jims Beta Engine Hydraulic Balancer Retainer Tool

Retainers hold the hydraulic chain tensioners in place when repairing Beta engines. Use on all 2000-on Twin Cam B models.

31543



Jims Outer Balancer Bearing Installer/Remover

Removes and installs the outboard balancer bearing on '96" and 110" "B" Softail engine's chain guard support plate. Use on all 2007-on Softails.

31447



Jims Outer Balancer Bearing Installer and Remover Tool

This tool removes and installs the outboard balancer bearing on the new 96" & 110" "B" Softail engine chain guide support plate.

31551 Use on all Softails 2007-on



Jims Balancer Shaft Retention Pins

Use this tool to secure the engine balancers on TC 88 "B" engines when servicing the flywheel assembly. This tool locks into the balancer's sprocket pin holes to prevent the balancer from turning out of sync with the flywheel.

31492 2000-on TC "B" model Softails



Jims Balancer Shaft and Bearing Installer Tool

This tool was designed to align and safely install a new balancer bearing and counter-balancer shaft into the Twin Cam 96" or 110" "B" Softail engine case. For removal of the balancer shaft from the engine case use Jims tool #31905.

31907 Use on 2007-on FXST



Jims Balancer Shaft Inner/Outer Bearing Remover and Installer

This tool will pull the bearings out of "B" motor cases in one easy motion preventing any damage to the bearing bores. The installing portion of this tool is designed to push on the outer diameter of bearings preventing any damage to the bearing or its bore. Includes thrust bearing for use on TC88B models 2000-on.

Use installer portion with tool #31438.

31585



Jims Balancer Shaft Removal Tool

This tool is designed to remove both front and rear counter-balancer shaft bearing assembly from the left engine case of the 96" and 110" Beta engines.

31905 Use on Softail 2007-on

Twin Cam Tools



S&S Crankcase/Cylinder Boring Plate Kit

Is designed for boring stock TC-88 engines to accept S&S Super Sidewinder 4" and 4 1/8" bore cylinders. A spacer included with the kit allows the cases to be bored without removing the cylinder studs.

530035



Jims Cylinder Torque Plates

These plates simulate stress conditions when boring and honing. Correct torqueing sequence is lasered on surface. Can be used on Screamin Eagle big bore cylinders.

31518 All Twin Cam to 4"



Jims Compression Release Valve Tool

Use this tool for machining all TC 1999-on heads for preparing heads to install Jim's compression release valves. Install on the front or rear head, with or without the valves installed. Simply drill, spot face, tap and install compression release valves.

31586



Jims Wrist Pin Bushing Reamer

Use with rods in or out of motor. Use to ream wrist pins to HD specifications. Reamers are made to exact tolerances and piloted to locate from the I.D. of the newly replaced wrist pin bushing.

31548 Twin Cam



Jims Wrist Pin Remover

Easy to use tool requires only one person to remove wrist pin.

31510 Use on all models



Jims Engine Dipstick Socket

Ingenious tool allows for the safe removal of the engine oil level dipstick that is located close to the scorching hot exhaust pipe on a Bagger or Dyna. Features a square hole for 3/8" ratchet fitment, 7/8" hex for wrench fitment and a cutout for clearance around the exhaust pipe. Made from non marring Delrio for durability and heat resistance.

31040



Jims BT Clutch Assembly Service Tool

This tool will safely disassemble and assemble the clutch shell assembly. Easily removes and installs the clutch hub from its bearing. Safely removes and installs the clutch shell ball bearing (37906-90) without any damage to the new bearing. This is done by pushing on the outer perimeter of the bearing.

31911 Use on all BT 1990-on



Jims Transmission Case Shifter Shaft Seal Installer

Precise and effortless installation of the shifter shaft seal. Align, center and install the shifter seal to the right depth on all EVO and Twin Cam Big Twins.

PCP Application

31036 Installs OEM 37101-84B seal on 2006-on 6-speed Cruise Drive transmissions

31039 Installs OEM 12045 on all 1980-99 EVO BT or 1999 Twin Cam 5 speed, to 2006 FXST, FLH and to 2005 FXD

Twin Cam Tools



Jims Trans Trap Door Puller and Bearing Tool

This tool will remove and replace OEM 8998 or 8992 transmission door bearings. It can also be used to remove the complete transmission assembly. Door bearings must be replaced if using this tool to pull door off case. Use on all 5 speed BT and aftermarket 6 speed 1980-06 except 2006 Dyna models.

31915



Jims Main Drive Gear Seal Installer Tool

Use to install the main drive gear oil seal (12077) to the proper depth with transmission assembled. Includes a protective sleeve for seal. Works without removing transmission from frame. The sleeve can also be used when installing transmission assembly by protecting the main drive gear inner bearings.

31906 Use on 2006-on present FXD & 2007-on FL, FXST



Jims Right Side Drive Trap Door Puller

This tool will remove the transmission door for service work without removing the complete transmission assembly. Use in all Jims right side drive transmissions and other aftermarket right side drive transmissions.

31027



Jims Cruise Drive 6 Speed Trans Main Shaft Pulley Locknut Socket Tool

Use to remove the larger 2-1/4" hex nut from the end of the main drive gear, which secures the rear drive trans pulley. Thread the inner support collar to the end of the mainshaft, place the socket over the collar with your favorite 1/2" drive tool and unthread locknut. Use on all 2006-on Dyna and all 2007-on FLHT and FXST models.

31038

Jims Twin Cam Engine and Trans Plug Kit

Indispensable kit for engine and transmission rebuilders. Plug the holes on all engine and trans when going through the steps of the rebuilding process. Helps keep dust, dirt and from the case openings. Use on any 1999-on Twin Cam engine and transmission.

31918

Twin Cam Tools



Jims Cruise Drive 6 Speed Transmission Door Remover Tool

Use to pull the complete door with gears and shafts from the transmission. No need to remove the trap door by prying or hitting with a hammer. Can be used with transmission in frame. Use on all 2006-on Dyna and 2007-on FLHT and FXST models.

31552



Jims Cruise Drive 6 Speed Trap Door Bearing Remover/Installer Tool

Innovative tool will accurately install a lubed ball bearing into the transmission trap door. Also Use on all 2006-on Dyna and 2007-removes bearing without error and can performed on a work bench, no need for an arbor press. Use on all Twin Cam 6-speed Cruise Drive models, 2006 Dyna and all 2007-on TC models.

31561



Jims Cruise Drive Late 6 Speed Trans Main Case Seal Installer

6 Speed main case bearings are of such high precision that you must be gentle when working in or around them. This driver style seal installer does not push or pull and installs the main seal to the correct depth, without applying any stress to the bearings or seals. Use on all 6-speed Cruise Drive 06-on.

31037



Jims Inner Cam Bearing Removal Tool

Fits FLT, Softail 07-on and FXD 06-on.

31358



Mainshaft Bearing Race Tool

Fits FLT 87-06, FXST, FLST 86-06, FXR 84-94 & FXD 91-05.

26069



Cam Bearing Puller

Used to remove inner cam bearing, caged Torrington, without splitting cases while preventing rollers from coming out during removal.

31411 BT 1958-99 (95760-TB) (Jims)

26057 BT 1958-99 (Preston)

Twin Cam Tools



Jims Cruise Drive 6 Speed Maindrive Gear Bearing Remover/Installer Kit

This is a complete kit for servicing the main drive gear or the main bearing on Cruise Drive 6 Speed transmission. Precision tool removes and installs both parts correctly without damaging the case. Use on all 6-speed Cruise Drive 2006-on models. 2006 Dyna and all 2007-on FL and FXST.

31916



Jims Cruise Drive 6 Speed Main Drive Gear Remover Tool

This tool removes the main drive gear from the main bearing correctly while in the transmission case. This eliminates the need of an arbour press and the risk of case damage. Use on all Twin Cam 6-speed Cruise Drive models, 2006 Dyna and all 2007-on TC models.

31570



Jims Cruise Drive Shift Shaft Remover/Installer

Remove and install OEM 35186-06 shifter shaft sleeve without removing the transmission case from the chassis. This tool installs sleeve to the correct depth in case without error or damage. Use on all 2006-on 6 Speed Cruise Drive models.

31048



Jims Cruise Drive 6 Speed Maindrive Gear Installer

Use this tool to safely install a new or newly repaired main drive gear. This job can be performed with hand tools while the transmission is still in the frame. Holds the main drive square to its bearing bore, eliminating any marring of gear or bearings. Use on all 2006-on Dyna and all 2007-on FL and FXST.

31462



Jims Cruise Drive 6-Speed Main Drive Gear, Bearing and Seal Installer Tool

Use this tool to safely install new main drive gear bearings and seal. This tool will hold bearings and seal square to its bore, eliminating any marring of the bearings and seals while installing both to the right depth. Use on all 2006-on Dyna and 2007-on FL and FXST.

31028

Twin Cam Tools



Jims Ignition Switch Housing Alignment Tool

This tool will easily align the ignition switch housing as the retaining screws are being torqued. This gives the ignition knob the alignment it needs to help extend the life of the ignition switch housing. Use on all 2003-on FL Touring models that have an OEM #61530-03B. **31422**



Jims Starter Ring Gear Rivet Fixture Tool

This tool is designed to remove the starter ring gear rivets from BT clutch shells to install Jims #639 and #640 or equivalent performance starter ring gears. **31902** Use on 1990-06 FL, FXST and 1990-05 FXR, FXD



Jims Oxygen Sensor Socket Tool

This tool is used to remove or install the oxygen sensor on all closed loop fuel injected H-D models. Socket has a 3/8" drive receiver or can be used with a 7/8" wrench. Socket will withstand up to 125 ft/lbs of torque. **31912** Use on all EFI models 2006-on



Jims Dyna Ignition Switch & Fork Lock Remover/Installer

This tool locates on the ignition switch face nut that holds the switch in place on the frame, letting you remove or install this switch correctly. Tool has a 3/8" drive access hole. Use on 2006-on Dyna models. **31415**



Jims 49mm Fork Seal and Dust Shield Installer Tool

This tool is designed to install the lower leg 49mm fork seal squarely into the bore without damaging the seal lip surface. Also used to install the dust shield cover. It is a two-piece design to aid in some assembly applications. **31900** Use on all FXD 2006-on and all VROD 2002-on (except inverted fork models)



Jims Thread Chasers for Spark Plug and Oxygen Sensors

Use to remove any I.D. thread damage that may have come from either exhaust carbon or the mating components, both in aluminum or steel.

PCP	Size	Application	Fitment
31023	12mm x 1.25	Spark plug	TC 99-on, XL, XR 86-on, Screamin' Eagle Evo heads 86-on and VRSC 02-on
		O2 Sensor	FLH 10-on sensor in exhaust systems
31024	18mm	O2 Sensor	FLH 06-09, all FXD, FXST, XL and V-Rod 06-on sensor in exhaust systems
31025	14mm & 18mm	Spark Plug	Double-ended tool used with 13/16" socket for all 14mm and 18mm spark plug holes

Twin Cam Tools



Jims Fuel Pump Retainer Remover/Installer

Use to safely remove or install the retaining ring that holds the fuel pump to avoid developing a fuel leak. Allows for quick and easy service of fuel filter and other fuel related parts. Use on all 2008-on FL models, with new fuel tank.

31421



JIMS Wheel Bearing Tool Support Plate

Accurate and precise bearing removal and installation on cast wheels without risk of damage. Attaches to the brake rotor mounting holes and is used in conjunction with JIMS #31587 or OEM wheel bearing puller. Fits 14-on cast FL wheels, 10-on CVO and open accessory hubs with 5 or 7 lug rotors.

31041



Inner Cam Bearing Tool

Use this four piece tool to safely install inner cam bearings to proper depth without damaging the bearings.

• Fits 1999-05 FXD, 1999-06 FLT, FLST and FXST

26071



Jims Inner Primary Cover Bearing and Seal Installer/Remover Tool

Designed to safely remove and install the inner primary bearing (9135) without any damage to the new bearing. This is done by pushing on the outer perimeter of the bearing. Also removes and installs inner primary seal (12052A). This is the bearing and seal that the transmission main shaft passes through.

31901 Use on late 1984-06 FXST, 1985-06 FL, 1985-06 FXR, FXD



Jims Late Sealed Wheel Bearing Remover & Installer Kit

Use to remove and install late new style sealed wheel bearings without damaging the wheel.

31587 TC, XL and Buell 00-on



Jims 25mm Wheel Bearing Puller Tool

This tool is used to remove the front 25mm HD wheel bearings on most of the 2007-on Softail models. This tool **must** be used with Jims wheel bearing installer/ remover tool #31587.

31598 Use on 2007-on front wheels of FXST, FLSTC, FXSTB, FXSTD, FLSTN, FXSTC



Jims 25mm Wheel Bearing Installer Adapter

Updates JIMS wheel bearing installer/remover tool to accommodate 25mm bearings. Use on most 07-on front wheels with 25mm bearings.

31268

Bottom End Tools



Jims "Taller" BT Engine Stand
Powder coated stand is 1-1/2" taller to fit all BT cases for engine repair. Features notch for crankcase breather fitting.
31431 BT single cam only includes S&S and aftermarket motors

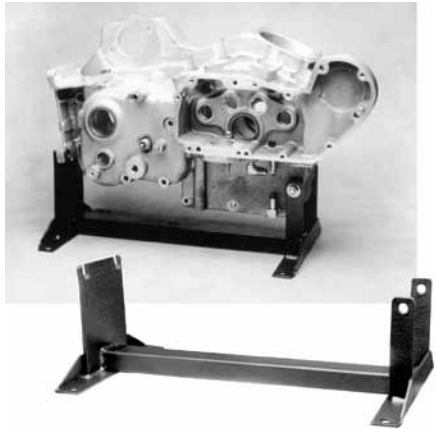

Jims XL Engine Stand
Powder coated, steel bench stand simplifies engine overhaul.
31432 XL 1957-03, Buell 1987-02



Preston Motor Stands
PCP Fits
2831 Motor Stand BT 1941-99 (not TC)



Jims End Play Gauge Indicator Tool
Features H-D thread pitch for mounting to cases when checking end play on engines or transmissions. Comes with 1/4"-20 and 5/16"-18 threads on the mounting rod. Can be used in any position for checking cam, shift drum, rocker or breather gear end play, as well as fly-wheel, mainshaft, or starter gear runout. For use on all Big Twin and Sportster.
31540



Preston Engine Stand XL 52-03
Measures 15-1/4" from the plate to the front holes.
82166



Jims Cam Cover Holding Tool
Use tool to hold cam cover for removing and installing bushings. Clamps in vice or mill. Holds cam cover flat and keeps it from being scratched.
31423 BT 1970-99 (1041-TC)

Bottom End Tools



Jims Cam Bearing Installer

Use tool for inner Torrington bearings 9058 on BT 1958-99 models.
31535



Cam Cover Pullers

Easily remove BT 1970-99 cam covers without prying on gasket surfaces.
5863 Preston's puller



Jims Cam Gear Remover BT 1970-99

Use to remove the cam gear from the camshaft on BT models. This precision tool acts as a stable base to keep the camshaft perpendicular to the press. A 3/8" ball bearing is included to protect the camshaft's end while pressing off the gear. For use with Jims cam gear alignment tool.

31589 1939-99 BT camshafts with pressed on camshaft gears

31538 1970-99 Single cam gear alignment tool



Trock Cam Bearing Installer

Will install OEM 9028 Big Twin Torrington bearing.
26093



Jims Cam Bearing Puller

Used to remove inner cam bearing, caged Torrington, without splitting cases while preventing rollers from coming out during removal.

31411 BT 1958-99 (95760-TB)

31489 XL 1957-90 (95760-XL)

31513 Twin Cam 1999-06 (1279)



Jims Cam Bearing Tool

For use with handle no. 31438 to install inner cam bearing. Handle slips through the outer cam bushing for alignment. All Jims bearing installers are designed with an angle to apply all the pushing force to the extreme outer diameter of the bearing.

31485 BT 1958-on single cam only all aftermarket and S&S motors

31486 XL 1957-90, Buell 1987-90

Race and Bearing Install Tool Handle
Handle slips through the outer cam bushing for alignment. Approx. 12" long.

31438

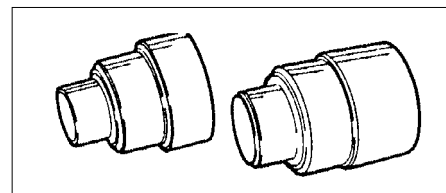

Preston's Cam Shaft Needle Bearing Installing Rods

Used to install cam shaft needle bearings on both Big Twins and XL's. Tool for all Big Twins replaces OEM #97272-60. Tool for all XL's replaces OEM #97273-60.

5828 Big Twins

5829 All XL's



Preston's Drive Handle

Replaces #33416 to drive wheel race, crank bearing race and cam needle installers.

5861

Bottom End Tools



Jims Cam Seal Installer / Remover

Remove and install cam seal without removing the cam cover. Just mount tool in cover, screw in the two removing screws, turn center and the cam seal comes out. Can also be used to remove cam cover from case. Use on 1970-99 Big Twin single cam models.

31533



Jims Cam Bushing Line Reamer Tool

Use to line ream cam cover bushing to size from inner cam bearing for a true centerline between the two dimensions. Finish size will be about .0008" to .0015" over the cam journal.

31408 BT 1970-on single cam only including S&S and aftermarket motors



Jims Cam Bearing and Bushing Alignment Tool

Use to check the alignment of cam bearing to cam cover to well within .0003" of centerline.

31536 BT 1970-on single cam only including S&S and aftermarket motors



Jims Cam and Pinion Bushing Drill Jigs

Allow the installation and drilling of a dowel pin to factory location supplied with #31 drill.

PCP Type

31401 Cam BT 1970-on (25581-70)

31402 Pinion BT 1954-92 (25582-54, 25582-73)

31403 #2 Cam XL 1957-90 (25588-57)

31406 Cam XL 54-on (25586-37)



31495 No. 31 drill bit for all model jigs above



31590 Staking pins for above (10 pk)

Bottom End Tools



Jims Pinion Bushing Line Reamer Tool

Use to line pinion bushing in cam cover from right case race.

31491 BT 1954-on single cam only including S&S and aftermarket motors and also XL idler gear bushing 54-E84



Jims Pinion Bushing Puller

Use to remove pinion bushing from cam cover in one easy operation. Use with PCP# 31423, cam cover holder. (95760-TP).

31412 BT 1954-99 EVO



Eastern's Bushing Reaming Tools

Big Twins and Sportster (pinion bushing in cam cover)

PCP Application
26091 XL 1986-on (94812-89)

Cam Bushing Reamers (cam bushing in cam cover)

26115 BT 1970-98 (94802-70)

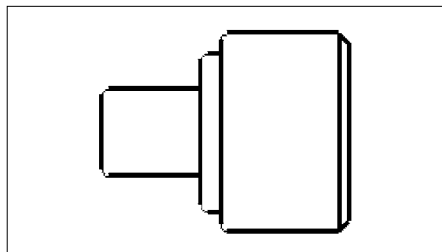

Preston's Pinion Bushing Tool

Positions pinion bushing in cam cover on all 1970-98 Big Twins to correct depth.
5862

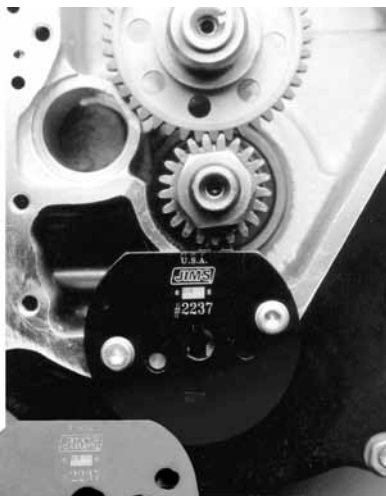

Jims Pinion Gear Lock Tool

For applying torque to the pinion nut on BT1954-99 models. Use Jims tool #31461 to tighten pinion nut.

31541



Jims Pinion Gear Installer and Puller

Use to remove pinion gear on BT 1939-89.

31479



Jims Pinion Gear Nut Socket

Use to remove or secure pinion gear nut to pinion gear shaft. 1/2" drive. Use with locker tool #31541.

31461 BT 1955-99



Preston's Gear Shaft Nut Socket Wrench

Fits the pinion gear nut which secures pinion to gear shaft 1955-89. OEM 94555-55.

2826

Bottom End Tools

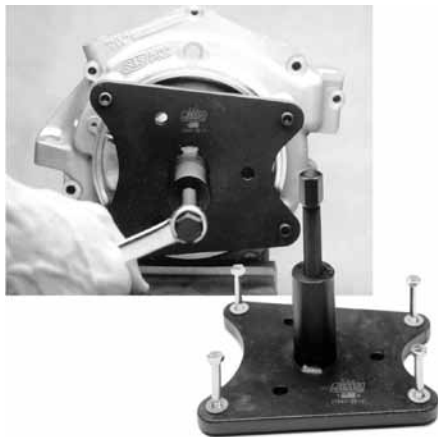

Jims Crank Assembly Removing Tool

Use to press flywheels from cases. Will also press cases apart and break sealant bond. Some case pressing will require a hard cap # 31553.

31488 BT 1955-on including TC, S&S and aftermarket motors



Sprocket Shaft Installing Tool

PCP Fits

2835 Big Twins 1955-98 (97225-55)

31483 As above, Jim's Machining



Jims Sprocket Shaft Bearing Race Tool

Use to remove and install Timken bearing race from motor case. Use with handle #31438.

31459 BT 1969-on including TC, S&S and aftermarket motors



Jims Sprocket Shaft Protector

Hardened end cap protects the shaft when using a press.

31553

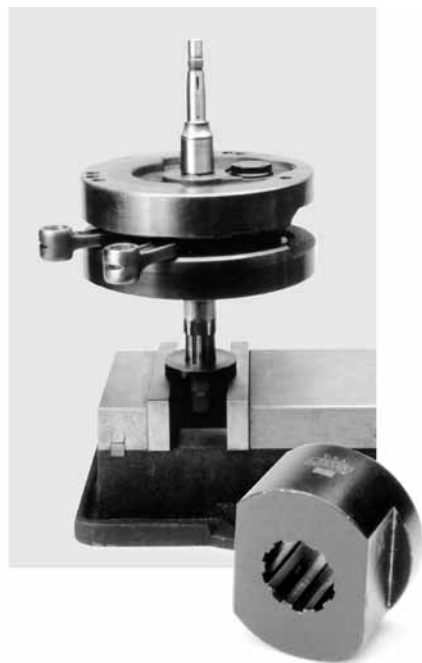

Jims Sprocket Shaft Holder

Use to hold the flywheel assembly in vise with or without left case attached.

31556 BT 1955-on includes TC-88, S&S and aftermarket motors



Jims Tool Driver Spacer

Spacer applies outward force on the bearing race tool to grip the race better, allowing easier removal of race. Use with driver tools #31437, #31459, etc...

31557 Use on all bearing race tools



Jims Sprocket Shaft Bearing Race Tool

Use to remove and install Timken bearing race from motor case. Use with handle #31438.

31460 XL 1977-03, Buell 1987-03



Jims Race and Bearing Install Tool Handle

Approximately 12" long. Use with tool #31437, 31449, 31460, 31485 & 31486

31438

Bottom End Tools



Jims XL Timken Bearing Puller

Tool removes the inner Timken bearing from sprocket shaft without removing the shaft from flywheels.

31424 XL 1977-03, Buell 1987-on

Jims Big Twin Timken Bearing Remover

Use to remove the sprocket shaft Timken bearing on BT 1986-on with an integral sprocket shaft.

31522 BT 1955-on includes TC-88



Jims Motor Sprocket Shaft Seal Install Tool

Use to press oil seal over sprocket shaft into case, use with tool #31483

31458 BT 1969-on including TC, S&S and aftermarket motors



Jims BT Sprocket Shaft Bearing Installer Tool

Use to install crankshaft assembly into crankcase Timken bearing.

31483 BT 1955-on including TC, S&S and aftermarket motors



Jims Sprocket Shaft Seal Installer

Use this kit to install the sprocket shaft seal to the proper depth and also for holding the seal square for a no leak fit. Driver handle sold separately.

31554 XL 1974-03



S&S Anti-Rotation Bracket

Bracket slides over the sprocket shaft splines of BT engines and bolts to one of the primary bolt holes of the crankcase to keep the crank from rotating. Great for installing pistons and cylinders.

509870



Jims Sprocket Shaft Bearing Installation Tool

Use to install crank shaft assembly into crankcase Timken bearings. Use with # 31480. Use tool #31453 to install the bearing until tool runs out of threads, then install #31454 to push the bearing on the rest of the way. Fits 1977-03 XL and 1987-on Buell.

31453 2.060" long

31454 2.500" long



Jims Snap Ring Installer and Remover

Use to remove and install the Timken outer race snap ring in BT 1969-on cases. Especially good for use in cases without inserts and to prevent aluminum gouging in 1990-on cases.

31559 BT 1969-on including Twin Cam 88, aftermarket and S&S motors.

Bottom End Tools



530011

S&S HD Flywheel Balancing Kit

S&S master flywheel balancing kit enables the average repair shop to perform balance jobs on most any O.H.V. BT and XL 1957-99. This includes all V2 1340, 883, 1100 and 1200 engines.

530011 Triple beam gram scales
530027 Master balance kit w/scales



Degree Wheel Kit

530020



31908



31909

Jims BT Engine Rotator-Flywheel Sprocket Shaft Tool

Use to rotate the flywheel assembly when doing pushrod adjustments, building big inch engines, or when checking operating clearances. Also can hold the flywheel assembly from rotating when torquing the cam drive sprockets retention bolts on Twin Cams or pinion shaft nut on single cam models.

Features a long socket making it easier to use without the use of 1/2" drive extension on your 1/2" driver. For engine bench work Jims recommends the engine be bolted into an engine stand. Use stand #31431 for Shovel, Pan and Evo engines. Use #31519 stand for all "A" engines, early and late 1999-2007 Twin Cam FL, FXD. Use Jims stand #1668 for all 2000-2006 FXST.

IMPORTANT: Not for pneumatic or electric impact. This tool is only guaranteed for use with hand drivers.

PCP Application

31908 BT 1955-06 except 2006 FXD.
Use on 1999-05 FXD
31909 Use 2006-on FXD and 2007-on FXST, FL



Jims Flywheel Runout Inspection Gauge

Check flywheel runout of the pinion shaft while assembled in engine case. Also checks the amount of gear lash on gear driven cams used in some Twin Cam engines. Use on 1984-on Big Twin, Evo and Twin Cam.

31521



Jims Flywheel Sockets

Heat treated, low profile sockets provide 100% nut to socket and drive end contact. Machined flat at the receiving end to prevent rounding off the nut.

BT Late 1983-on Single Cam Only

Use to install or remove crank pin nut no. 23969-83.

31416 1-1/2" x 1/2" drive

BT Late 1981-89

Use to install or remove pinion shaft nut no. 24016-80.

31417 1-1/4" x 1/2" drive

31503 1-1/4" x 3/4" drive

BT 1972-on Single Cam Only

Use to install or remove sprocket shaft nut no. 24017-80.

31418 1-5/8" x 3/4" drive

XL 1981-99 and Buell 1987-99

Use to remove or install crank pin nut no. 23901-81.

31419 1-3/8" x 3/4" drive

31504 1-3/8" x 3/4" drive



Flywheel Spreader Tool

Spreads wheels while truing for BT and XL.

26144

Bottom End Tools



Jims Rod Race Tool

Supports both sides of rod as races are removed or replaced, minimizing the possibility of distortion to female rod or race.

31428 All BT single cam only includes S&S and aftermarket motors



Jims Rod Alignment Tool

Use to check rod straightness without removing rods from case. The alignment tool is 4-1/2" long.

31436 BT single cam only, including S&S and aftermarket motors



Jims W/Pin Bushing Reamer

Use with rods in or out of motor. Use to ream wrist pin bushings to HD specifications.

31549 BT with late diameter size wrist pins 1973-99 (includes all aftermarket motors)

31550 XL 1957-on, Buell 1987-on



Jims Timken Bearing Simulator

This tool allows quick and easy removal and replacement of flywheel assembly in the left side crankcase when checking clearances before final assembly. For use on BT 1970-on models including Twin Cam 88, aftermarket and S&S motors.

31560

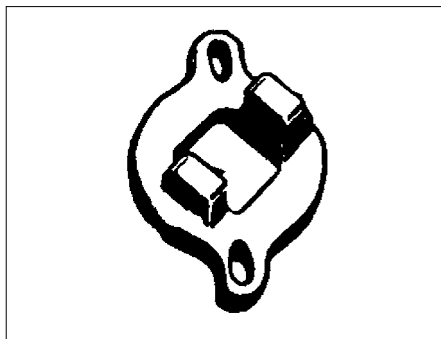

Preston's Rod Clamping Tool

Holds connecting rod when fitting piston pin bushing on all 74 & 80 model Twins.

5876



Connecting Rod Checking Pin

This pin is used to check connecting rod alignment after rods have been installed in flywheels and lower end is assembled. Pin is 4-1/2 inches long and .7920" to .7923" in diameter, hardened to R.C. 45 to 50. Pin fits both Sportster and Big Twin rods.

530002



Jims Rod Lapping Set

Arbor assembly includes 1-1/2" and 1-5/8" laps.

31473 All BT single cam only includes S&S and aftermarket motors

31474 1-1/2" lap head only

31475 1-5/8" lap head only



Jims Lap Head 1-1/2"

Used in rod lapping set PCP #31473.

31474 96740-36-4

Bottom End Tools



Eastern Crankcase Lapping Tool

Aligns left and right main bearing races as well as lapping to size on all Sportsters, & Big Twins.

- 2849** Complete tool
- 2850** Replacement Lap Head 1-1/2
- 2851** Replacement Lap Head 1-3/8
- 2852** Replacement Lap Head 1-3/4



Eastern Rod Lap Tool

Big Twin and Sportster. This tool is for lapping connecting rod bearing races when fitting new rod rollers.

- 2838** Tool with 2 cast iron laps
- 2839** Lap head only 1-1/2"
- 2840** Lap head only 1-5/8"
- 26001** Spanner wrench

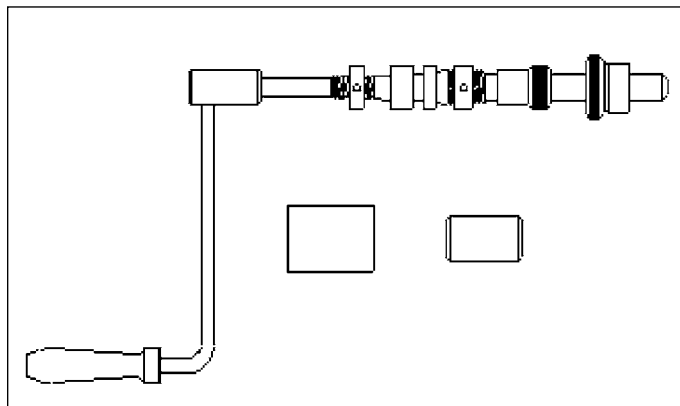

Eastern Lapping Tools

Use for precision alignment of engine and transmission shafts. Engine unit replaces 96710-40 to lap right and left crankcase races for oversize bearings. Trans tool insures proper fitting of oversize rollers with mainshaft races on Big Twins and Sportsters. A dual purpose "Combo Lap" for both engine and trans use also available. We stock the replacement cutters for both tools.

- 2849** Engine Cpt.
- 2853** Trans. Cpt.
- 5875** Combo Cpt.

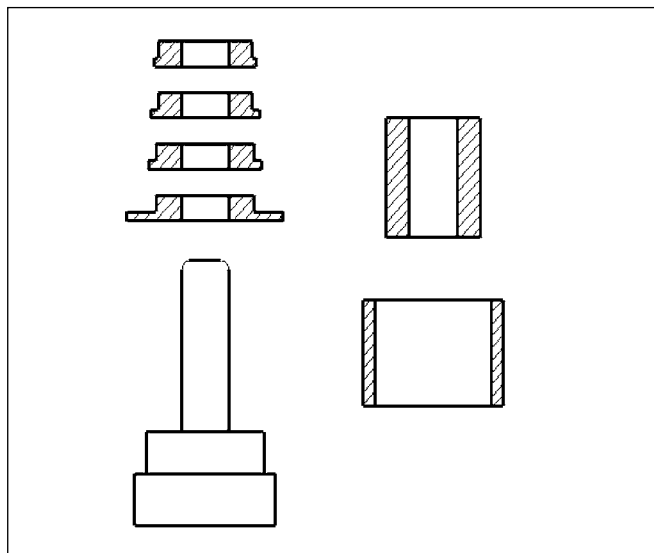

Preston's Rod Race Tool

Supports both sides of rod as races are removed or replaced minimizing the possibility of distortion to female rod or race.

- 2857** All Twins

Clover Oil Based Lapping Compound

16 Oz. can. Use on valves for a good seal and with all Jims lapping tools. Available in 2 grits- 1 for roughing-in and 1 for finish work.

- 31591** Coarse 220 grit (micron finish of 32)
- 31592** Fine 320 grit (micron finish of 16)



Bottom End Tools

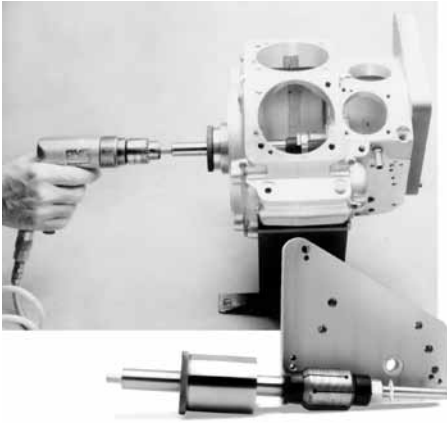

Jims Twin Case Lap Tool

Jims case lap is guided on both sides of the pinion bearing race. This additional support on the cam gear side of the bearing race is achieved by means of a bolt on base plate that precisely locates a drill bushing in which the lap turns. Instead of guiding only from the left side, Jims case lap uses a special ground bearing sleeve to hold left side of lapping shaft without movement. Both ends of the lap are supported in precisely the same centerline as the flywheel assembly. With this extremely rigid arrangement it is possible to power the lap with a low speed drill motor without chatter in the lapped bearing race. Can also be powered by a conventional hand crank. To do a 4 speed transmission case, Order PCP# 31409 with this tool.

31472



Jims Cylinder Jig Assembly

Use to repair stripped damaged cylinder base threads up to 4" bore in engine case. Tool will hold centreline and squareness to where factory intended them to be.

31532 BT 1984-on single cam only including aftermarket and S&S motors, XL 1986-on and Buell 1987-on



Jims Cylinder Torque Plates

Simulate stress conditions when boring and honing. Drilled for multiple use.

31530 Up to 4" Evo

31531 Bolts for use with XL Evo and Buell

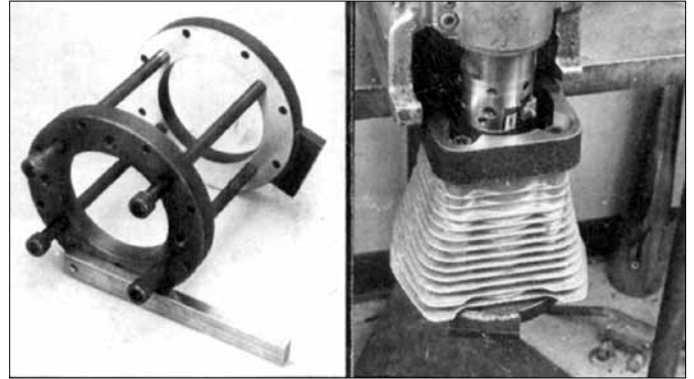

S&S EVO Cylinder Torque Plate Kit

Simulates stress conditions when boring and honing EVO Cylinders. Machined from chrome moly steel, accommodates all BT 1340 and Sportsters 883-1100-1200 cylinder and 3-5/8 S&S Cylinder. As pictured, up to 3-5/8" bore.

530016 S&S

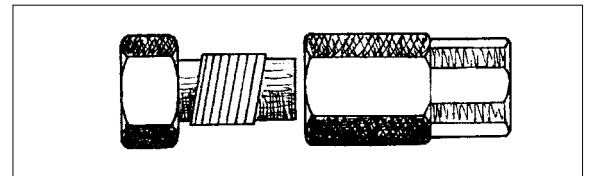

Evo Cylinder Tools

Allows installation of stud to correct height or removal by locking to stud.

26094 Assembly tool

26095 Extracting tool

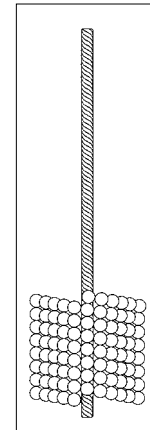

Cylinder Wall Flex Hone

The easy and economical way to recondition cylinder walls and a perfect cross hatch for oil retention and for quick ring seating. Globules of silicone carbide laminated to the ends of hi-density nylon creates a flexible hone which is unbreakable, requires no set up, and does not get out of shape. Just chuck the wire shaft in a 3/8" or larger drill; lubricate cylinder wall with a little oil and start deglazing. In 30-40 seconds the cylinder is done. Normal life of this tool is at least 1,000 cylinders.

26700 3-7/16" to 3 1/2"

26701 3" to 3-3/16"

26703 3-5/8" to 3-3/4"

26702 4-1/4"

Bottom End Tools

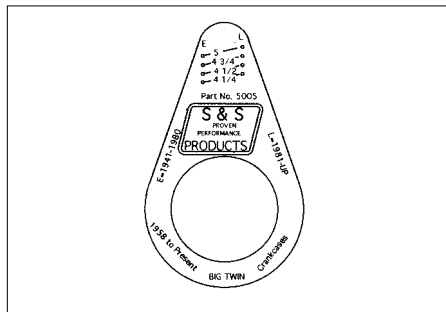

Crankpin Nut Clearing Gauges
530005 Big Twins 1958-99



S&S Crankcase Oil Passage Drilling Jig to 1998

The Crankcase Oil Passage Drilling Jig is designed to help the H-D Big Twin engine builder update early crankcases when installing an S&S oil pump assembly. This fixture enables the builder to do four crankcase drilling modifications.

530013 Drilling jig



Jims Oil Pump Snap Ring Installer

Jims tool easily installs outer snap ring on oil pump shaft without over stretching the ring.

31498 BT oil pumps single cam only including S&S and aftermarket motors



Jims Piston Pin Bushing Tool

Use to remove and install wrist pin bushings without removing rods from crankcase.

31468 All single cam models



Jims Timken Bearing Race Installer

Use to press a race in straight in the left side crankcase on BT 1969-98 and XL 1977-03 models. For 1969-98 Big Twin use Jims tool #31459.

31558



Jims Oil Pump Seal Installer

Installs oil pump seal perfectly below gear surface for a no leak fit.

31499 Use on all aluminum BT pumps, single cam only including S&S and aftermarket motors



1885

Preston's Bearing Race Press Plug

Used to remove and install Timken Bearing Outer Race.

PCP	Fits
1885	1955-98 Big Twin (97194-57)
5878	1977-03 XL



Crane Cam Tuning

34545 Top dead centre piston stop

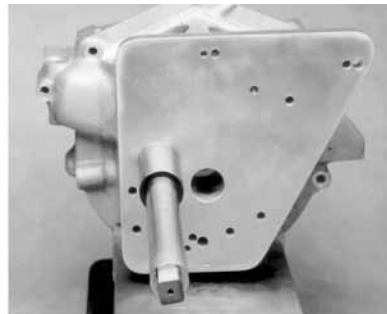

Jims Breather Reamer Tool

Use to repair a damaged breather hole to .030" oversize. No need to disassemble the cases.

31562 BT 1936-98

Bottom End Tools

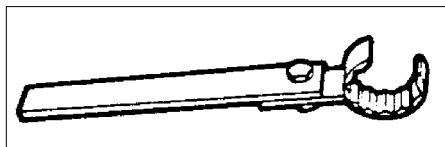

Oil Pressure Switch Wrench

Installs and removes oil pressure switches without damage to the switch itself, the extension handle is not used when servicing Sportsters. Used on 1340cc Evo. Replaces 34816.

26031



Wrenches for Oil Pressure Gauge and Indicator Lamp Sending Unit

Reversible ratcheting wrenches are used to install and remove oil pressure indicator lamp or gauge sending unit on all FL Touring models 1999-on

PCP Item

26171 For Indicator lamp

26172 For sending unit



JIMS Inner Primary Bearing/Seal Tool

Seal removal and installation tool for 85-on BT models. Eliminates the need to use a press.

31052



Jims Late Shovel and Evo Tappet Block Alignment Tool

Use to align oil hole from crankcase to tappet block. Using two will allow alignment of rocker boxes on Evo heads.

31440 BT Late 1976-on single cam including aftermarket and S&S motors (1/4-20 threads)

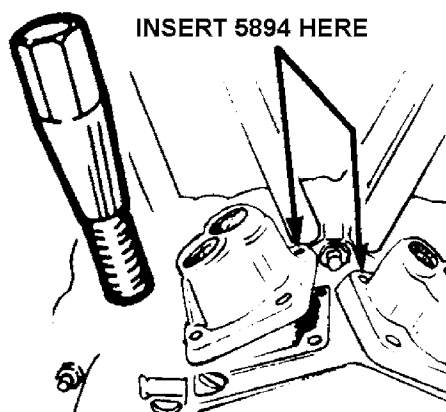

Tappet Guide Alignment Tool

1. Snug 5894 in screw hole on tappet block nearest the tappet oil feed hole.
2. Install and tighten other three screws.
3. Remove 5894 and install fourth screw.
4. Tappets are now aligned properly with the CAM.

Tappet Guide Alignment Tool

Replaces 33443 to align tappet guide to engine case to result in proper alignment of the cam lobes to valve tappets on 1340cc EVO only.

5894 Preston's



Bender's Tappet Roller Tool

This high quality American-made tool makes a time-consuming job easy to handle. It prevents damage to the tappet body during the removal and replacement of all types of tappet rollers. Fits the tappets of all Big Twin and Sportster® models including Evolution® models.

5874 Sold each



Jims Tappet Oil Filter Screw Plug Tool

Use on BT with slotted screw.

31547



JIMS Tappet Position Holding Tool

Allows the tappet and anti rotation pins to be safely and accurately stored for proper reinstallation. For all TC engines 99-on and XL 00-on.

31042

Top End Tools



Jims Valve Guide Tool

Use to install shoulderless valve guides to the proper depth. Designed for stock style guides with an O.D. of about .560". Order driver handle separately.

31444 All BT and Twin Cam includes all aftermarket heads



Jims Valve Guide Driver Set

Use guide removal and installation on all models. 3 pce set.

31426 All models including TC-88 and all aftermarket heads



Jims Head Holder-Valve Guide Remover and Installer

Comes with adapters to fit all HD and aftermarket heads. Adapters are supported by a support stand. Makes pressing guides in and out simple. A special guide alignment shaft holds the right angle for best possible guide installations.

31528



Jims Valve Guide Seal Tool

Use to install the valve guide seal. Designed for stock style guides with an O.D. of about .560". Order handle separately. Factory driver spacer not required.

31443 BT 1984-on including TC-88 and all aftermarket heads

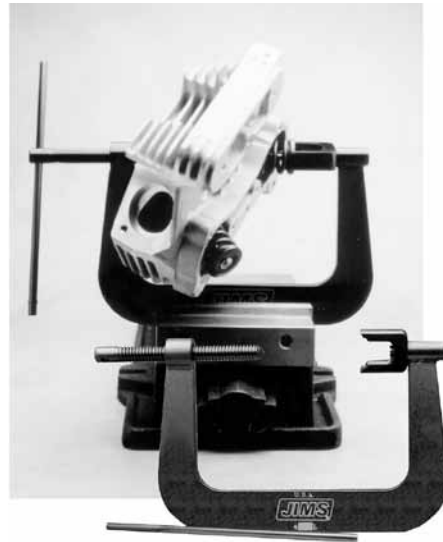

Valve Spring Compressor Tool

Jims tool for removing or installing valves. Hardened ball bearing style tip at valve head end eliminates damage to valve. Can be clamped into vice and includes valve collar receiver for safer tool use.

31471 O.H.V. BT and XL including Twin Cam and all aftermarket heads

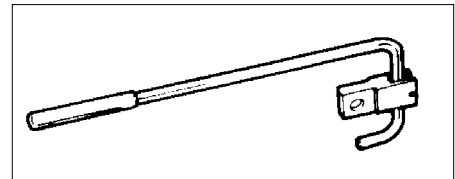

Rear Intake Valve Spring Compressor

Compresses intake valve spring on the rear cylinder of the FXST (1340cc only) so that the rocker box can be removed while the engine is still in the frame. It does this without damage to the valve stem, valve spring, or rocker cover. (OEM 34641).

5895



Piston Pin Retaining Ring Installer Tool

Fits BT 84-17.

26005



Wrist Pin Bushing Reamer Tool

Sifton tool with lead-in taper at the start of each ream. Fits EL 36-52 & FL 41-99.

26025

Top End Tools

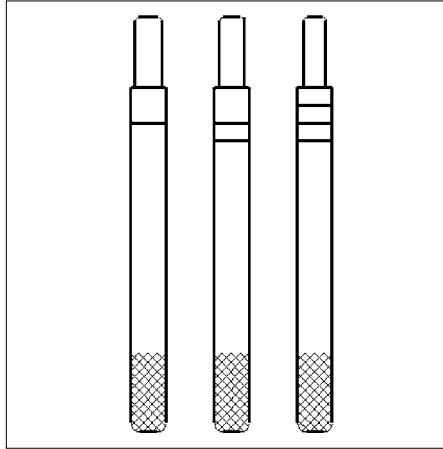

Valve Guide Driver Tool Set

Three sizes of drift valve guides for BT and Sportster. 5/16 valve guide drive, 11/32 valve guide drive. 3/8 valve guide drive.

2829



Wire Type Wrist Pin Circlip Tool

Easily install and remove wrist pin clips without damage on BT 84-on & XL 86-on.

26140



Evolution Rocker Box Cover Ratcheting Wrench

Features a low profile to allow clearance between frame and engine, a replaceable bit and an extra long handle for greater reach. BT 84-99 and XL 88-06.

26165



Valve Guide Seal Installer

Installs the valve guide seals to proper height without damage for all Shovel-heads (OEM 35103).

5897



Valve Guide Install Tool

This single tool will, with the correct socket, accurately set the height and install all guides, including shouldered, shoulderless and snap ring types for all Harley OHV motors 1948-86. Sockets must be purchased separately

4436 XL Intake socket

4437 XL Exhaust socket

4438 Evolution intake & exhaust socket

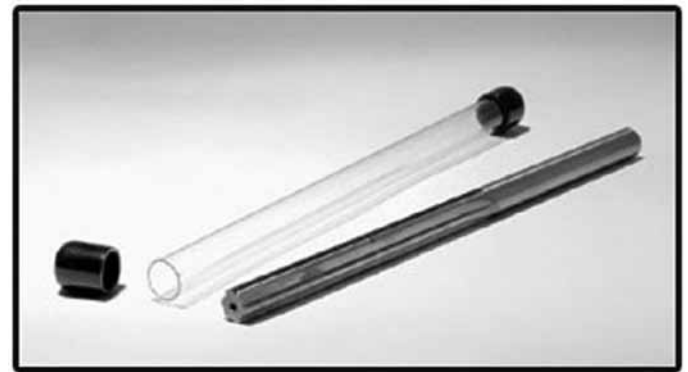

AV&V Solid Carbide Valve Guide Reamers

These unique reamers feature a 2" long pilot for a perfect alignment with the valve guide while reaming and are specially designed for use with manganese bronze material. Valve guides can be reamed to exact dimension without any taper in just a few seconds. These durable tools will last for hundreds of guides. When using AV&V valves and guides this one tool allows you to fit both intake and exhaust.

PCP	Diameter	Application
34044*	7mm +0.001"	Stock OEM valves
34045	0.3110"	Evo, Twin Cam
34046	0.3115"	Evo, Twin Cam
34047**	0.3120"	Evo, Twin Cam

*HD 7mm valves are .001" oversized, #34044 must be used to fit AV&V bronze guides to accept OEM valves

** Recommended size for all Evo and Twin Cam AV&V valves



Universal Ball Hones

Kibblewhite precision valve guide hones are durable enough to size C630 bronze and cast iron valve guide materials.

PCP **Size**

32115 7.0mmm

32116 5/16" (.3125")

32117 3/8" (.3750")

Top End Tools



Jims Piston Support Plate

Use this tool to install your rings and cylinders by providing a non-marring flat support to push the bottom of the piston agents as you install the rings and cylinder over the piston.

31588 Use on all HD style engines

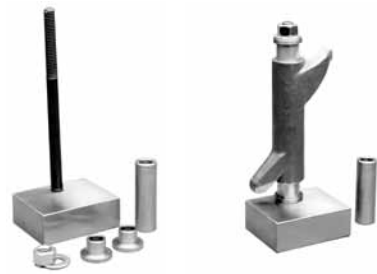

Rocker Arm Bushing Installer

Jims, use to install rocker arm bushings in rocker arms with or without a press. Installs each bushing to the correct depth for the best oil control. Can be used on all aftermarket rocker arms.

31529 BT 1966-on, Twin Cam 88, XL 1957-on and Buell 1987-on



Pushrod Cover Compressor

Allows removal & installation of push rod clip.

26055



Jims Head Holder Tool

Use to hold head in vise through spark plug hole. Has 14mm and 12mm ends. Allows easy positioning of head for all types of work. Can be used on all BT 1948-on including Twin Cam 88 and all aftermarket heads.

31523 For use on BT 1948-on, XL 1957-on, and Buell 1987-on



Jims Rocker Bushing and Roller Bearing Puller

Use to remove rocker bushing or bearing in one easy operation. Use on BT 1966-on and Twin Cam includes all aftermarket rocker arms.

31490 Use on BT 1966-on, Twin Cam, XL 1957-on and Buell 1987-on



Pushrod Cover Clip Installer/Remover for Twin Cam

Install and remove pushrod clips quickly with one hand when using this non-marring, non-slip black Delrin this tool.

31021 Jims

26015 Preston



Pushrod Cover Compressor Tool

Pushes against top rocker box to allow one hand operation. XL 57-89 and BT models,

26155



Universal Ball Honers

Precision valve guide honers are durable enough to size C630 bronze and cast iron valve guide materials.

Kibblewhite

32115 7.0mm

32116 5/16" (.3125")

32117 3/8" (.3750")

Imported

26052 8mm valve guide

26053 .554" Rocker arm bushing

26056 10mm Valve guide



Rocker Bushing Line Reamer

Jims, use to ream rocker bushing to a factory fit of .0007"-.0012" in line with each other. Precise line reamer is capable of a 24 finish or better. Use on all rocker arms including aftermarket arms.

31420 Use on BT 1966-on, Twin Cam, XL 1957-on, and Buell 1987-on.

Top End Tools



S&S Boring Plate and Spacers

Saves time when preparing crankcases and cylinder heads for S&S Sidewinder big bore installations. Machined cast iron with precision ground working surfaces. Plate has Panhead and Shovelhead head bolt patters on one end and cylinder base patterns for 1936-99 BT engines and 1986-03 Sportster engines on the other. Spacers are sold separately which allow Evolution cases to be bored without removing the cylinder studs. Both #530007 and #530008 spacers are required for 1984-99 BT Evolution engines. 1986-03 XL models require only spacer #530007.

PCP	Item
530006	Boring plate and bolt kit
530007	3-11/16" Tall spacer
530008	7/8" Tall spacer



Valve Spring Compressor

For use on conical valve springs. Add this collar to your JIMS valve spring compressor tool #31471 to remove and replace valves and conical (Bee Hive) springs (OEM 18245-02). A must have tool for safe valve work. Use on all BT 05-on except SE models and all XL and Buell 04-on.

31441



Jims Piston Pin Keeper Tool

Use to install retaining ring in piston in one easy step without distorting ring.

31442 BT 1983-on single cam only including S&S and aftermarket motors and XL late 85-on, Buell 87-on



Jims Head Bolt Torque Gauge

Accurate gauge allows the measuring of 90 degree when tightening Evo head bolts. Torque sequence lasered on gauge.

31525 BT 1984-on includes TC-88, S&S & aftermarket motors



Socket Handle Cylinder Head Bolt

3/8" square drive for use with standard sockets. Use on all Twins.

5819

Transmission Tools



Jims BT Transmission Stands

31434 BT 4 speeds and 5 speed
FXST 1986-on

31435 5 speed rubber mount
transmissions excluding
1993-on FLT and all Dyna
models

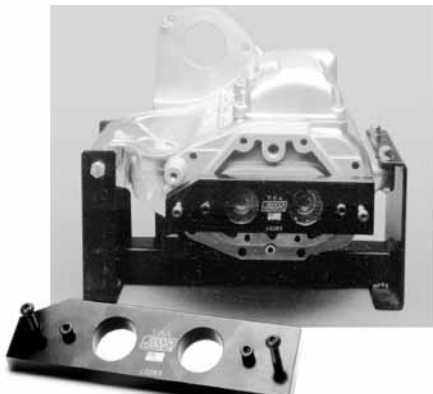

Jims 5 Speed Door Puller

Use to remove BT 5 speed trans door.
Removes door with gears and shafts
attached without any scratching and no
damage to door bearing.

31575 BT 1980-on 5 and 6 speeds



Eastern's Transmission Lap-ping Tool

Insures proper fitting of oversize rollers
with transmission mainshaft races. Will
lap races on Big Twins and Sportster
transmission.

2853 Complete tool

2854 Lap Head only Sportster 1.300

2855 Lap Head only BT 1.870

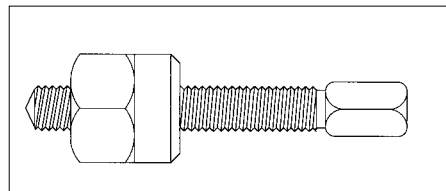

Preston's XL Transmission Access Door Puller

Screws onto clutch gear end and pulls
access cover which is press fit on two
dowels. Replaces OEM 95560-57. Use
on all XL 57-90.

5817



Jims FL Power Train Alignment Tool

This tool easily and safely aligns the Power Train, (rubber
mounted engine, transmission and swingarm assembly) to
the correct position as found on most touring models. Align-
ment service must be performed when the engine, transmis-
sion or swingarm has been removed or repaired. The safety in
handling and performance of the motorcycle could be greatly
effected without the accurate alignment this tool provides.

31546 Use on 1996-on FLHT models



Jims Seal Driver 5 Speeds

Use to install main seal in transmission
on early and late 5 speeds. Press in the
seal as flat and straight as possible to
.050" below housing for a no leak fit, use
with Jims tool #31410.

31569 BT 1985-on 5 and 6 speeds



Jims Seal Driver Late 4 Speed

Use to install the main seal in transmission. Press in the seal
as flat and straight as possible to .050" below housing for a no
leak fit, use with Jims tool #31410.

31571 BT 82-86



JIMS 5 Speed Main Case Seal Installer Tool

Ensures correct alignment and seal depth when installing seal.
Fits 85-06 BT 5 speeds and aftermarket 6 speeds.

31053

Transmission Tools

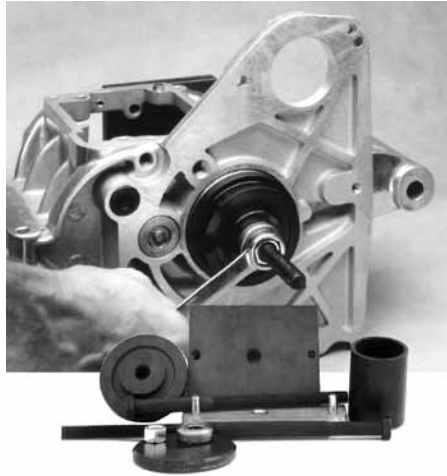

Jims 5 Speed Transmission Main Drive Gear Tool

Use for damage free removal and installation of the main drive gear. Also installs the main bearing without removing transmission case.

31451 BT 5 and 6 speeds 1980-on, XL and Buell 1991-on.



5-Speed Main Drive Gear Bearing and Seal Installer

Replaces 34734 for 1980-90 BT.
5899



Jims C/S Support Plate

31455 XL 1991-on (37404-91)



5 Spd Main Bearing Remover

Jims, use to remove old bearing straight without possible damage to trans case and without removing the trans case.

31580 All BT 5 and 6 speeds



Main Drive Gear Bearing Tool

Jims, use to install inner and outer 5th gear bearings to factory depth. New bearing depth incorporated, will still work on early depth.

31456 BT 5 & 6 speeds 1980-06, XL and Buell 1991-05



Jims Transmission Main Drive Gear Bearing Tool

Install main bearing to the factory depth.

31439 BT 1979-86 4 speeds

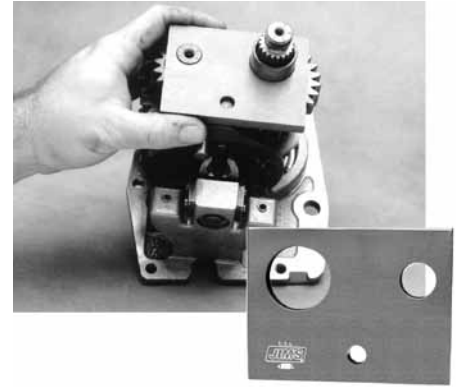

Jims Trans Gear Spacing Tool

Use to align main and countershafts when checking proper gear spacing.

31452 XL 1986-90, Buell 1987-90



Jims 5 Speed Main Drive Gear Bearing and Seal Installer

Use to install both bearings and the seal on the clutch side.

31446 BT 5 speeds 1980-90



Main Drive Gear Seal Installer

Jims, use to install main drive gear oil seal to the proper depth with transmission assembled. Comes with a protective sleeve for seal.

31593 BT 5 speed models

Transmission Tools



Jims 5 Speed Transmission Shaft Installer

Allows transmission shaft to be installed without the use of a hydraulic or arbor press.

31574 5 and 6 speed transmissions

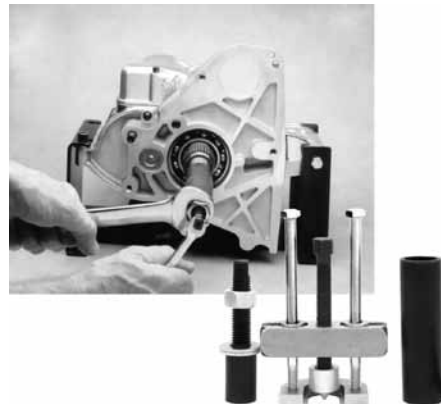
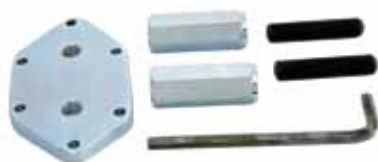

Mainshaft Bearing Race Tool

Jims, use to remove and install the bearing inner race on the transmission mainshaft.

31493 BT Late 1984-on



Mainshaft Bearing Installer

Fits BT and Sportster 1991-on. Replaces 37842.

26074



Jims Mainshaft Sprocket Lock-nut Wrench-1/2" Drive

Heavy duty, thick walled tube features extra long 2 piece design. Inner collar will retain wrench to nut for safer work.

31464 BT 1936-on (1-7/8" hex)

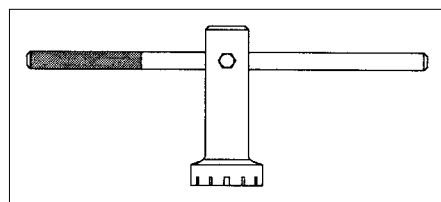

Counter Shaft Sprocket 4th Gear Nut Tool

Replaces OEM #94660-37. Handle not included.

5822 1979-on 5-speed 80"



Trans Mainshaft Bearing Installer XL 84-90

Replaces 34810, aligns and installs bearing without damage to case or bearing. Use with our handle.

26023

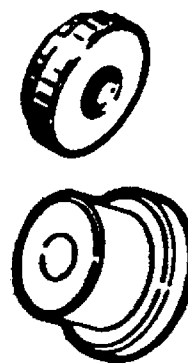

Trans Mainshaft Bearing Installer XL 84-90

Replaces 34810, aligns and installs bearing without damage to case or bearing, use with our handle.

5887 Installer

5861 Driver handle



Jims BT Sprocket Locker

Use to lock final drive sprocket. For removing and installing sprocket nut. Use with no. 31464.

31581 BT 1980-on 5 & 6 speed

Transmission Tools



JIMS Ultimate Clutch Adjusting Tool

Quickly and accurately tighten the clutch adjusting screw jam nut without having the screw change position on 1985-on BT. Includes proper hex allen wrench which conveniently stores in the tool handle.

31044



JIMS Compensating Sprocket Lock Kit

Positively secures the compensating sprocket so it cannot come loose due to shaking. Also keeps the alternator rotor in place to prevent damage to the charging system as well. For use on 2006 Dyna and 2007-on Big Twins with Screamin Eagle performance compensator. **Not** for use on early style compensator with spring cup attached to rotor or 2014 stock compensator.

PCP	Application	For use with Compensator	
		OEM	Screamin Eagle
31057	08-11 Softail Rocker 2011 FLH	40370-08 83935-09	40274-08
31056	12-13 BT	83935-09A	40274-08A



JIMS Cruise Drive Vise Stand

Holds the shafts in perfect alignment while protecting them from damage. Use to assemble transmission gears and shafts in 06-on Dyna and 07-on BT.

31051



Countershaft Bearing Remover & Installer Tool

Install or remove the closed end countershaft bearing on all 5 speed and 6 speed cruise drive transmissions without using a press or tapping it in with a transmission shaft. Installs square and to the proper depth. For all HD 6 speed Cruise Drive and 80-06 5 speeds and aftermarket 6 speeds.

31924

Big Twin Trans M/S Seal Re- mover & Installer by Jims

Used to replace transmission mainshaft seal on Big Twins 1936-86 4 speeds. Will push seal to .050 below housing for a no leak seal.

31410 Kit



Transmission Tools



Jims Clutch Hub Puller

Use to remove wet and dry clutch hub clutch release rod. 4 bolts included for dry clutch removal. (95960-52C)

31467 BT 1936-90

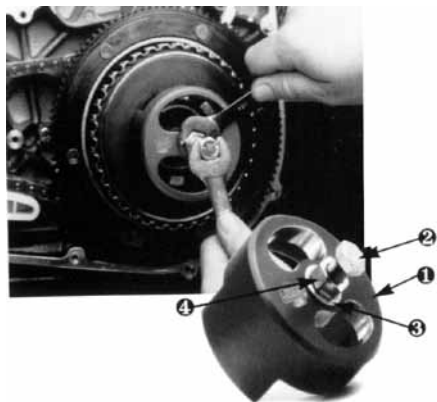

Jims Clutch Spring Compressor

Use to release clutch spring for ease of retainer ring removal and installation. (38515-90)

31457 BT 1990-97

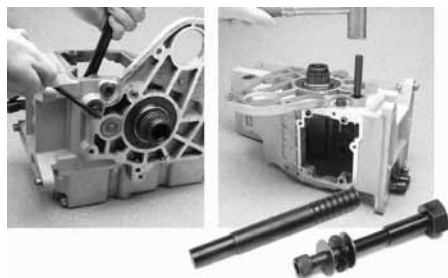

Jims Shifter Shaft Sleeve Tool

Use to remove and install the shifter shaft sleeve in all aftermarket 5 & 6 speeds. This tool may be used to remove, install replacements or upgrade shifter shaft sleeve, assembly and drum. Upgrades shifter assembly in 5 speed 1980-99 BT and 1980-00 FLHT, FXR and FXD. Use to replace shifter sleeve for 5 speeds 2000-06 FXST, 2001-06 FLHT and 2001-05 FXD.

31029



Jims Clutch Hub Puller Tool

Lettered for removal of listed items:

- A 45" clutch
- B BT clutch (3, 5, 10)
- C BT alternator cover
- D XL transmission sprocket
- E BT motor sprocket
- F XL early clutch
- G XL late clutch

31429



Clutch Spring Compressor

For diaphragm clutches on 1984-90 Sportster models. This one piece simple design utilizes a portion of the clutch release mechanism during disassembly. Replaces 34761.

5892 Imported

31448 Jim's Machining



Jims XL Nut-Clutch Spring Tool

31497 XL 1991-on (38515-91)



Clutch Puller

Pulls the clutch hub on all Big Twins and 45's 1936-84 (except diaphragm clutch). Work equally well on 3, 5 or 10 finger clutch hubs. Can also be used to pull the trans sprocket on XL, and rotor assembly on Big Twins 1970-on.

5823



V-TWIN BT 1340 Clutch Compressor Tool 90-on

Enables clutch to be disassembled. Replaces tool 38515.

26049



Oil Drain Spigot Tool

Channels transmission fluid from the bottom of the transmission case into the drain pan instead of onto the frame. Allows you to remove the drain plug through the center of the tool. Fits FLT 09-on.

26081

Chassis Tools

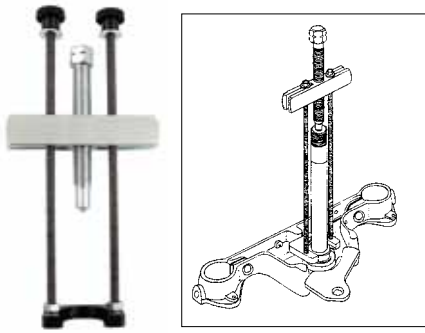

Lower Neck Bearing Puller

Includes: cross arm puller, rods and lower puller claw. Simply remove roller from old bearing, install claw and turn puller.

26106



Fork Bushing & Seal Installer

Installs bushing and seal without damaging components.

PCP Application

5883 FXRT 83-on, FX 84-on, XL 73-87 (39mm) (34190)

5884 FLT-FXWG 1984-on (41mm) (34634)



Bushing Installers

PCP Application

26011 Fork bushing FXR 1987-on



Front Axle Wrench

• Use on 1-5/16" front axle

26077



Fork Stem Bearing Remover

Use this tool to remove the lower fork stem (triple clamp) tapered bearing. Use on all lower fork stems that use bearing OEM #48300-60. Order Jims hard end cap #1048 when using on early XL 1954-77

31450 Tool

31291 Bearing plate



Fork Seal and Cap Installers

Jims, use to install fork seals, dust seals, and chrome caps. Lightly grease to keep from scratching fork tubes.

31505 39mm slider with Delrin plastic indestructible cap (2 pce kit)



Jims 41mm Fork Seal Slider

Lightly grease slider to install fork seals, dust seals and chrome caps.

31507



Fork Leg and Tube Holder Tool

Use this tool to hold fork legs and tubes for easy hands free servicing or rebuilding. Mounts in a vise to hold the fork firmly during repair without causing damage to the fork assembly. Will not scratch surfaces.

31487



Front Fork Compressor Tool

Use to compress the front springs in cartridge style shocks when servicing or rebuilding. The compressor can be mounted in a vise for easy hands free servicing. Also includes an adapter for FL forks to eliminate direct contact with spring coil and a special rod to pull up the fork damper rod.

82099



Jims Fork Nut Socket

Use to remove and install top fork tube plug. Eliminates possible burring of plug caused by wrenches.

31496 Use on 1948-on Wide Glides



Chassis Tools



Jims Starter Jackshaft Seal Installer Tool

This tool is designed to align and easily install the starter jackshaft seal (12066) without distorting or damaging the seal. This seal is located in the upper part of the inner primary of Big Twins.

31904 Use on Twin Cam 1999-06 FL, 2000-06 FXST, 1999-05 FXD and BT Evo 1994-00.

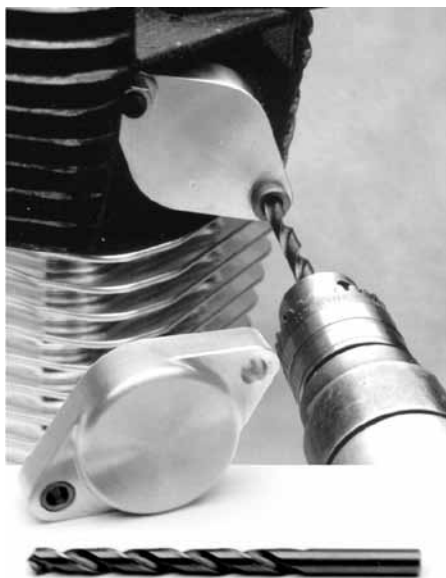

Jims Exhaust Stud Drill Fixture

Fits BT and XL 1984-on exhaust ports to align for the drilling of a broken exhaust stud.

31524



Fork Tube Plug Socket Wrench

Socket wrench tool for FL 1948-84, FXWG 1980-86, FLST 1986-on, FLT 1979-on.

26096



Jims Alternator Rotor Removal Tool

Must have tool for 45 AMP charging systems. Will pull the rotor free from its magnetic hold. Use on 1997-06 FL and Ultra.

31433



Jims Exhaust Gasket Seal Installer Tool

Use Jims handle #31438 or with exhaust flange nuts to position the seal evenly into the exhaust port of the head. Use on all 1984-on EVO Big Twins, Sportster and all Twin Cam.

31020



BT Alternator Rotor Puller

The puller uses the sprocket shaft end to centre and the two threaded holes in rotor for rotor removal.

26076



Oxygen Sensor Tool

Remove and install oxygen sensors on fuel injected models. Socket has 3/8" drive receptacle. Can also be used with 7/8" wrench.

PCP Fits

26110 18mm EFI

26111 14mm FLT, XL 06-on, Softail, Dyna 06-17



Jims 35mm Hex Top Fork Nut Socket (3/8 Drive)

To remove or install top fork nut on glide forks. Has a rubber protector on inside to prevent chrome damage.

31567

Chassis Tools



Touring Suspension Air Pump

Small, low volume pump with bleeder valve and 0-60psi pressure gauge makes easy work of adjusting pressure in air shocks. Features tight connector and flexible hose for getting at tricky spots. Fits FLT 83-on, FXRT 84-94.
26145 54630-03A



Digital Shock Pump Tool with Gauge

Features digital display and 0-300 PSI gauge. Fits FLT 83-on, FXRT 84-94.
26153

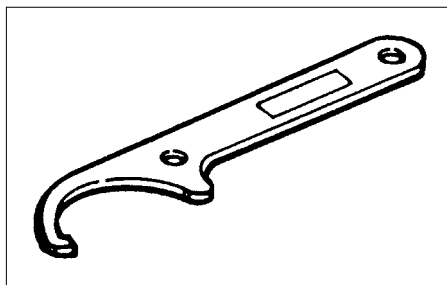

FXR-FLT L79-Up Shock Tool

Replaces 94409-78 and 94448-82. For use on 79-on FLT, 82-94 FXR & 79-on XLH-XLS-XLCH. Zinc plated.
1319



1" Fork Stem Die Tool with Holder

Use to repair or dress 1" x 24 TPI on BT fork stems. Holder can be turned by a wrench.
26126



Left Rear Motor Mount Bolt Wrench

Use for removal and installation of left rear motor mount bolt on BT without removing the inner primary cover.
26147



Shock Tool FXST 1989-on

For use with 3/8" ratchet drive.
73648

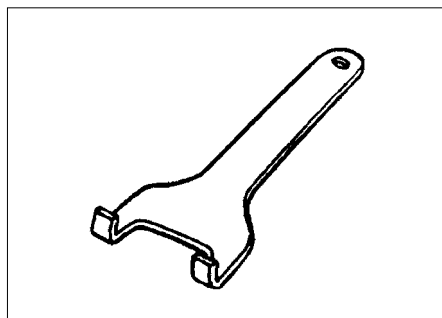

FXST-FLST Shock Wrench

Replaces 94455-89 to adjust rear shock preload or seat height.
5896



12mm Oxygen Sensor Wrench

Remove/install oxygen sensors without removing the exhaust pipes. w12-17.

PCP Application

31638 Dyna, V-rod and Softail front exhaust pipe sensor

31640 Softail rear exhaust pipe sensor



Adjustable Main Jets For S&S

Fits in the float bowl drain plug below the main metering jet. The recommended main jet is 100 to 104.

Adjustable Enrichener for S&S

Replaces the stock fixed enrichener, adjusts as bike warms up, and also makes for easier starting. O-rings and instructions included.

PCP Description

1254 Enrichener

3823 Main jet (super carb)

530452 Jet installer and removal tool on all B & E carbs



Main Jet Tap Tool

For Bendix carbs. 9/32 Threads.
5860



Evolution Ratcheting Intake Manifold Wrench

Features ball end allen bit for flexibility in tight areas. Fits BT 84-99 & XL 88-06.
26164



14mm Oxygen Sensor Wrench

Use to remove/install four wire heated oxygen sensors. Designed to be used with 3/8" drive torque wrench. Fits FLH, Touring 10-on.

31646

Chassis Tools



Jims Steering Head Bearing Race Installer

Use to install steering head races, stock and custom, as well as install cups in the frame. This tool pulls the races and cups in, straight and true, without any damage. **31582** Use on all models



Jims Steering Head Bearing Race Remover Tool

Use to remove and install steering head bearing race.

31583 BT 1949-on including S&S and aftermarket motors, XL 1978-on and Buell 1987-on.

31557 Race spacer only

31438 Driver only



Jims Steering Head Stem Nut Wrench

Time saving tool provides access to the head stem nut without removing the radio package. Use this tool to loosen, tighten an instad torque the 1-1/2" stem nut without radio removal. Use on 1996-on FLHT and 1994-on FLHR.

31030



Pivot Bearing Remover

Use this tool to remove and install all Softail swingarm pivot bearings. This tool may also be used to remove and install the spherical bearing on springer front fenders. This tool will remove and install the bearings straight and true without any damage. Use on 1984-on FXST or any aftermarket swingarm that uses OEM bearing #9076. Also use on BT 1997-02 and 2004-on Springer Softail front fenders that use OEM bearing # 9194.

31500



Rear Swing Arm Bearing Remover/Installer

For FXST, FLST models 1986-99.

26127



5 Speed Swing Arm Spreading Tool

26070



Jims Cleveblock Bushing Assembly Rear Swing Arm Tool

Use to remove and replace swing arm cleveblocks. Cleveblocks are silicone filled bushings that will be damaged if not installed properly. Jims tool presses on the outer sleeve of the bushing, preventing damage to the cleveblock. Can be used with or without a press.

31564 Use on FLT 1980-on, FXR 1982-94 and all aftermarket FXR style frames



Cleveblock Spreading Tool

Jims, use to install the swing arm in a 5 speed rubber mount frame. When cleveblocks are replaced they need to be positioned to install in the rear of the transmission. This tool will spread the swing arm cleveblocks allowing for installation of the swing arm.

31563 For use on BT 1980-on

Chassis Tools



S&S Clutch/Inner Primary Bearing Race Puller

CNC machined clutch puller is specifically designed to remove an S&S high performance clutch. Can also assist in the removal of a stock clutch from a damaged mainshaft. Add an attachment to the clutch puller and it doubles as a primary inner bearing race remover.
565141



Fuel Tank Lock Ring Tool

Use to remove and install fuel tank lock ring. Allows access to the fuel filter and fuel pump. Fits FLT 2008-on.
26112



JIMS Pulley and Sprocket Mega Nut

Left handed threaded nuts feature a lock plate design. Can be used on all H-D 6-speed Cruise Drive transmissions 2006-on FXD, 2007-on FLH, FXST and BDL 6 speed sprockets. Install using JIMS socket tool #31038 and #31581 pulley locker.
31011

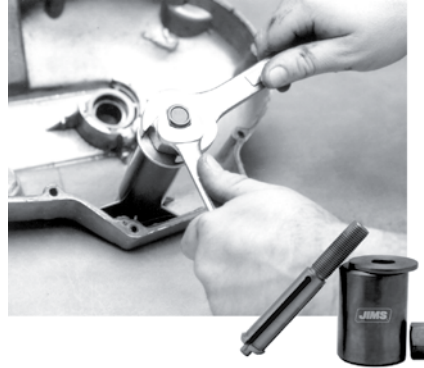

Jims Outer Primary Cover Starter Bearing Remover Tool

Easily removes bearing, even if cover has been chromed with bearing installed.
31577 BT, XL and covers that use bearing no. 9063
Note: Also c/shaft bearing 1977-on 4 speeds and XL 4 speed gear.

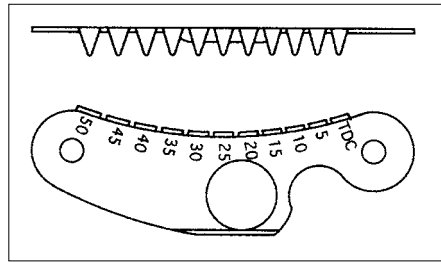

E-Z Tyme

Device bolts inside the primary cover on 1970-99 Big Twins. After installation, only inspection oval of outer primary need be removed for accurate timing.
26060



Primary Drive Locking Tool

Jims, use on all primaries between front primary chain and motor sprocket.
31579 Made from black Delrin



Late Model XL Primary Case Plugs Tool

The style of the mid-70's XL models primary plug is now available for the newer 883 and 1100 XL models. Can be used to replace both primary plugs on '86-90. Shown with one of two XL primary plug tools that are also now available and make removing the plug easier. Makes marring the plug's groove practically impossible.
5800



S&S Inner Primary Bearing Race Installer

CNC machined tools make servicing quicker and easier. Inner bearing race installer features a roller thrust bearing that decrease the effort required by 30%.
565145



26104



26105

Final Drive Tool

Tool fits final drive pulley, to ensure that the nut can be properly set to torque specifications.

PCP	Application
26104	BT (41184)
26105	XL 91-on

Chassis Tools



Fork Stem Nut Wrench

- Loosen & re-torque fork stem nut without removing radio pack
 - Fits FLHR 1994-on and FLHT 1996-on
- 26024**



JIMS Wheel Bearing Tool Support Plate

Accurate and precise bearing removal and installation on cast wheels without risk of damage. Attaches to the brake rotor mounting holes and is used in conjunction with JIMS #31587 or OEM wheel bearing puller. Fits 14-on cast FL wheels, 10-on CVO and open accessory hubs with 5 or 7 lug rotors.

31041



Adjustable Fork Seal Driver Tool Kit

Easily install fork seals on conventional or inverted forks. Includes 1 split seal driver and 3 seal guides, 35mm, 39mm & 41mm.

26034



Clutch Hub Puller

Wet clutch type hub puller. Fits FXR 84-94, FLT, FXST 84-06, FLST 86-06 & FXD 91-05. Replaces 95960-52C

26035



Clutch Drum Locking Tool BT 84-89.

Use to remove clutch hub and motor nuts. Fits FLT, FXR, FXST 84-89 and FLST 86-89.

26084



5849



72693

Spoke Nipple Wrenches

PCP Application

- 5849** Universal to fit spoke nipples, sized one to six
72693 BT, 45" & Servi-car interchangeable wheels
 45" solo front 16" wheel (12033-39)
72662 Larger size for 1980-on metric spoke nipples



Manual Shock Pump Tool with Gauge

0-60 PSI pressure gauge. Fits FLT 83-on and FXRT 84-94.

26026

General Tools



Speedo Sender Unit Wrench

Reversible ratcheting wrench with shortened 3/16" ball end hex bit for easy removal and installation of hex screws. For all models equipped with electric sending units.

26083

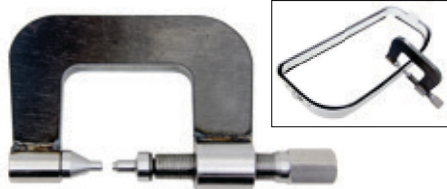

Saddlebag Latch Rivet Tool

Use to fasten rivets.

26037



Universal Ball Hones

Precision valve guide hones are durable enough to size C630 bronze and cast iron valve guide materials.

Kibblewhite

- 32115** 7.0mm
- 32116** 5/16" (.3125")
- 32117** 3/8" (.3750")

Imported

- 26052** 8mm valve guide
- 26053** .554" Rocker arm bushing
- 26056** 10mm Valve guide



**NEW ITEM
COMING SOON**

Wheel Bearing Puller/Installer

Fits FLT 00-on, Softail 00-17, FXD 00-17 & XL 00-on.

- | PCP | Size |
|--------------|------|
| 26085 | 3/4" |
| 26087 | 1" |
| 26086 | 25mm |



Ignition Switch Alignment Tool

Aligns switch housing while retaining screws are being torqued.

- 26073** FLT 03-13 & VRSC 02-on (red anodized finish)
- 26078** FLT 03-13 & VRSC 02-on (blue anodized finish)
- 26072** FLT 14-on



Fuel Transfer Tool

Attaches to the stock check valve and allows fuel transfer from one bike to another or to use for draining the fuel tank for seasonal storage. For use with all models with EFI

26080



TDC Indicator

14mm tool is used to locate top dead center of piston with heads on engine, when degreasing the cam shaft.

26008



Lower Fork Bearing Press Tube

Tool slides over 1" stem and presses down to seat bearing.

26043

General Tools



Belt Tension Gauge

Gauge is designed to aid in properly adjusting belt tension on models with a secondary drive belt.

26016 Preston

31035 Jims



Calibrated Belt Tension Gauge

Accurately measures belt tension.

26169



26040



26039

Chain Puller

This handy tool eliminates the annoyances of installing the master link in your rear chain. Conveniently pulls chain halves together without loosening at rear wheel. Fits all sizes. Chain puller.

26040

Chain Breaker

Excellent for cutting 530 heavy chain.

26039



Jims Rear Axle Nut Torque Adapter

This tool allows you to torque the axle nut from an offset position eliminating the need to remove mufflers. Features a 1/2" drive receiver hole. Use on 2006-on FL Touring models and 2008-on. V-Rod 2005-on.

31031



Link Press Tool

Presses the side plates on all 530 o-ring chains.

26012



Jims Hollow Axle Plug Tool

Most late model motorcycles are now using hollow axles which has eliminated the center point of the axle, formerly used as a center point for alignment references. Lube the o-ring ends of these tools and insert in left and right ends of Axle on 2008-on Dyna and Sportster models. This will give you the correct center point required for safe vehicle alignment

31032



Jims Third Hand Axle Locker Tool

When torquing the axle nut after setting the proper belt tension, the welded axle nut may move allowing the belt to lose adjustment. Place this tool over the welded nut on the left side with the neck portion of the tool resting over the swingarm. Hand screw the adjusting screw to take up any slack in tool. Torque the axle nut from the right side knowing the welded nut will not turn and the belt will not lose its adjustment. Use on all 2002-on FL.

31033

General Tools



Wheel Bearing Greaser

Patented fitting & spigot will grease 1973-99 tapered bearings without removing seals.

5811



Jims Wheel Bearing Race Tool

1973-99

31437



Super Tire Tool

A deluxe tire iron. 15" long for better leverage and quicker, easier tire changes.

3546



Wheel Truing Fixture Parts

Cast alloy construction. Adjustable widths for all wheels, with or without axle in place. Made in U.S.A.

26027 Roller stanchions only



Spoke Wrench

Fits six spoke nipple sizes. Jaw sizes are numbered and stepped down in numerical order for quick and convenient spoke adjustments. Tool is contoured to allow a sure grip. Perfect for tool bag or box. Lengths is 4 inches.

5849



Oil Catcher Pan

Use when removing oil filter to avoid spilling the oil onto the engine cases. Includes 12" tube to direct the oil flow into the oil drain pan. FXD 99-on & XL 04-on.

26003



Oil Filter Wrench Pliers

Rubber coated handles and serrated jaws for better grip. Use to remove stuck-on oil filters.

26006

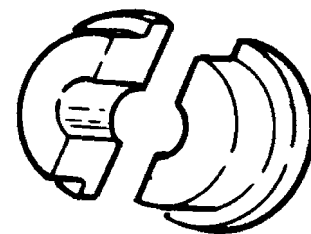

Wheel Race Puller

Replaces service tool 33071, for hubs with tapered races 1973-on. All models.

5824



Put E-Z SQUEEZE on solid surface. Squeeze with hands for 4 seconds or until new grease appears on top of bearing.

E-Z Squeeze® Bearing Packer

Patented design grease all tapered bearings with a 5/8 or large I.D. Canister holds grease for clean operation.

5871



Vise Jaws

Soft jaws work great in any 4"-6" steel vise. 6 Strong magnets to hold jaws securely to vise. V shaped cutouts hold and protect round or hex shaped parts.

26013 Accel black billet aluminum

31084 Jims cleated alloy

31085 Jims aluminum with rubber pads

General Tools



"Activator" Battery Filler

Nozzle attaches to any standard acid pack tube. Positive thumb release valve absolutely controls acid flow, preventing acid spills, burns and holes in clothing.
26148

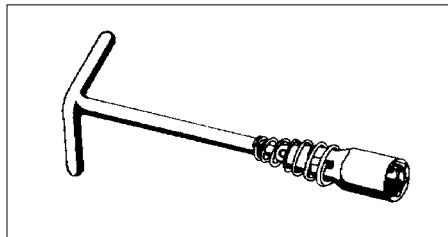

Swivel Spark Plug Wrench

Patented design for all 12 & 14mm plugs. 180° rotation.
26020



Jims Pin Extractor

Easily removes the molex style pin from connectors.

31526 Use on all models

Jims Receptacle Extractor

Easily removes the molex style receptacle pin from connectors.

31527 Use on all models 1980-on



Accel 14mm Spark Plug Indexer

This index tool for 14mm spark plugs allows the engine builder to specify the location of the ground electrode for maximum flame front generation. Tool is knurled for easy hand held operation or can be mounted in a vise. Made from billet aluminum with a gold anodized finish with increment labels for accurate alignment. USA made.

26125 Use PCP 25283 index washers for proper alignment.



Accel 14mm Spark Plug Index Washer Kit

Soft copper spark plug washers allow the engine builder to align the ground electrode and adjust plug to piston clearance. Sold in a 30 pack assortment.

25283 For use with PCP 26125 spark plug indexer



Hose Clamp Tool

OEM type clamp closing tool.

5870 Crimping tool (97087-65A)



300+ Crimp Tool from Accel

This top quality tool is an absolute must when making custom wire sets and wiring. Made from a heavy-duty hardened steel frame with molded non-slip hand grips. An adjustable ratchet mechanism produces consistent high quality crimps. The 300+ Crimp tool includes three removable stripping/crimping die type jaws, 2 styles for primary wire terminals and one for 7-9mm plug wires.

28270

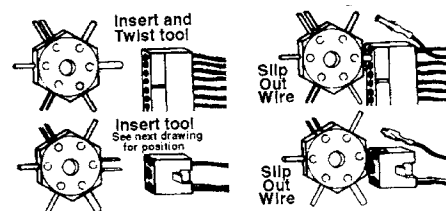

Wire Terminal Tool

Quickly and easily depresses lock tabs on terminal pins and sockets to ease wiring harness disassembly.

26054 1971-90 XL,
1973-90 BT
(97362-71)



26045



26047

Safety Wire Tools

Wire twisting pliers feature automatic twisting and plying motion which gives uniform twists without damaging wire. Bolt drill fixture allows drilling of 1/16" diameter holes in heads of hex, 12 point, or allen head cap screws from 3/16" to 5/8" shank diameter. Includes drills and bushings, which secure the bolts during the drilling operation. Tools sold separately.

26045 Drill fixture

26047 Tie wire (.032)

26048 Tie wire (.041)

General Tools



Snap Ring Pliers

Specially designed with long reach fingers for use on master cylinders.

26167



Flex Hone for 5/8" Master Cyl.

Designed for low speed operation using 3/8" drill.

26119 For 5/8" master cylinder

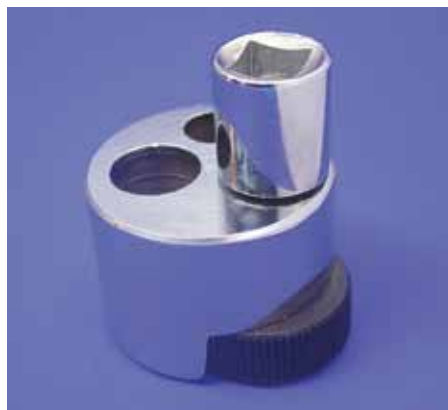

Stud Remover and Replacer

This powerful tool is designed to fit into the hard to reach spots and get out the hard-to-turn studs. Capacity from 1/4" to 3/4".

5856

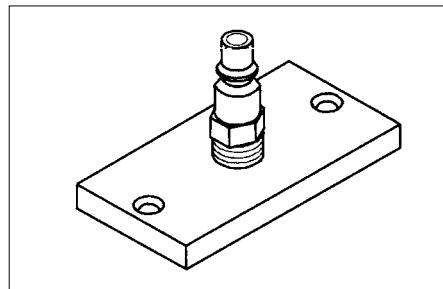

Low Pressure Master Cylinder Bleeder Covers

Will allow one person to bleed brake lines or to check system for leaks and can drain the entire system to replace brake fluid.

26129 Front 1982-95

26131 Front 1996-98

26130 Custom rear Jay Brake



Seal Puller Tool

Simply insert the tip of the tool behind the oil or grease seal, press and pull leverage works for you. No more pounding, hammering and digging that might damage bearings. Two size tips reach in and fit nearly all seal applications.

5813



Drill-Out

Broken bolt extractor kit includes a precision left hand cutting self-centering point drill and special collet. Detailed instructions included.

26059 1/2"-12mm

JIMS Exhaust Pipe Snap Ring Installation Tool

Quickly and easily install the exhaust pipe retaining ring on almost all H-D exhaust systems. Install the snap ring in seconds without scratching the exhaust pipe or twisting the ring. For use on all Twin Cam, Evo and 1986-on Sportsters.

31010



Jims Brake Caliper Piston Remover

Use this tool to support the brake caliper pistons when removing them. This tool will hold the pistons square to their bores preventing damage to pistons and piston bores. Allows seals and wipers to be replaced. Works on all 4 piston brake calipers 2000-on.

31463



Driver Handle

Replaces 33416 to drive wheel race, crank bearing race and cam needle installers.

5861

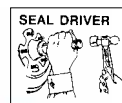

Seal Driver Kit

Quickly installs seal without damage, includes 16 adapters for seals up to 3-3/8" diameter. Includes special adapters for "shielded" seals.

26038

General Tools



Mini-Lift

Use with table lift to raise bike on table with 3" to 12" range.
Max weight 600lbs.

85000



Gasoila Sealant

Available in hard setting red varnish or soft set blue/white with teflon. Red sealant is the original sealer for sealing holes on porous surfaces and for use on the inside of crank cases and cam covers. Blue-white seals threaded joints on pipe threads and fittings. Both types are insoluble in oil, gas and solvents. Sold in 1/4 pint can that includes brush.

59474 Red varnish

59475 Blue/white



Heli-Coil Thread Repair Kit

Thread inserts for head bolts with 7/16"x16 thread are .656" long. Drill size is 29/64. Fits FL 1948-84 and FX 1971-84 6 Pack.

73770



Heli-Coil Thread Repair Kit

For cam cover screw, tappet guide, oil pump stud, timer and mounting threads. This kit includes tap, installation tool and 12 inserts.

26019



Gasegacinch Gasket Sealer

Sold as 4 oz. can.

59476

1760



Oversized Drain Plug and Tap Kit

Contains 1 chrome plated dome head plug with an oversize thread and one tap for rethreading the stripped out drain hole. Fits OHV Big Twin Harley Engines 1965-on and Sportster 1967-on.

1760 Tap and plug kit

1761 Oversize plug only



Oversize Timing Plug/Tap Kit

Contains 1 chrome plated acorn head plug with an oversize thread and one tap for rethreading the stripped out timing hole.

1758 Tap and plug kit

1759 Oversize plug only



Opti-Clear Timing Hole Plug

Clear timing tool for use on all Harleys. Remove your stock timing plug and insert this top quality tool for easy timing. This is for use as a tool only; once your timing is set it should be replaced by the stock plug. Replaces OEM #96295-65.

626 Each